

OWNERS GUIDE

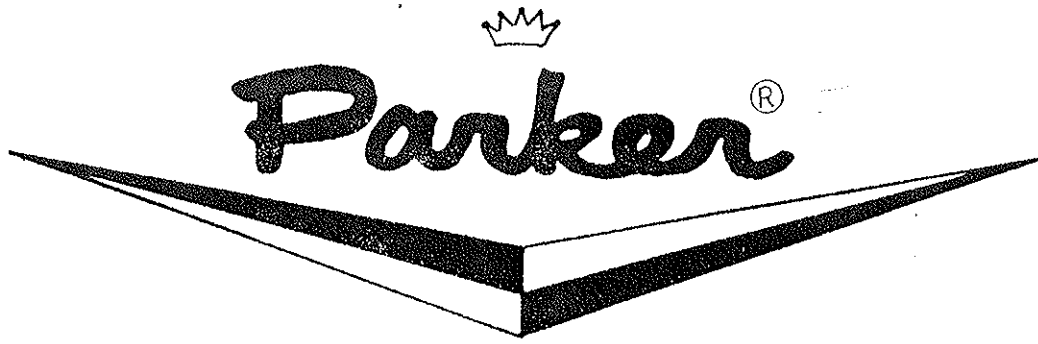

**SELF-PROPELLED HURRICANE**

MODEL HC-8180-AK-SP

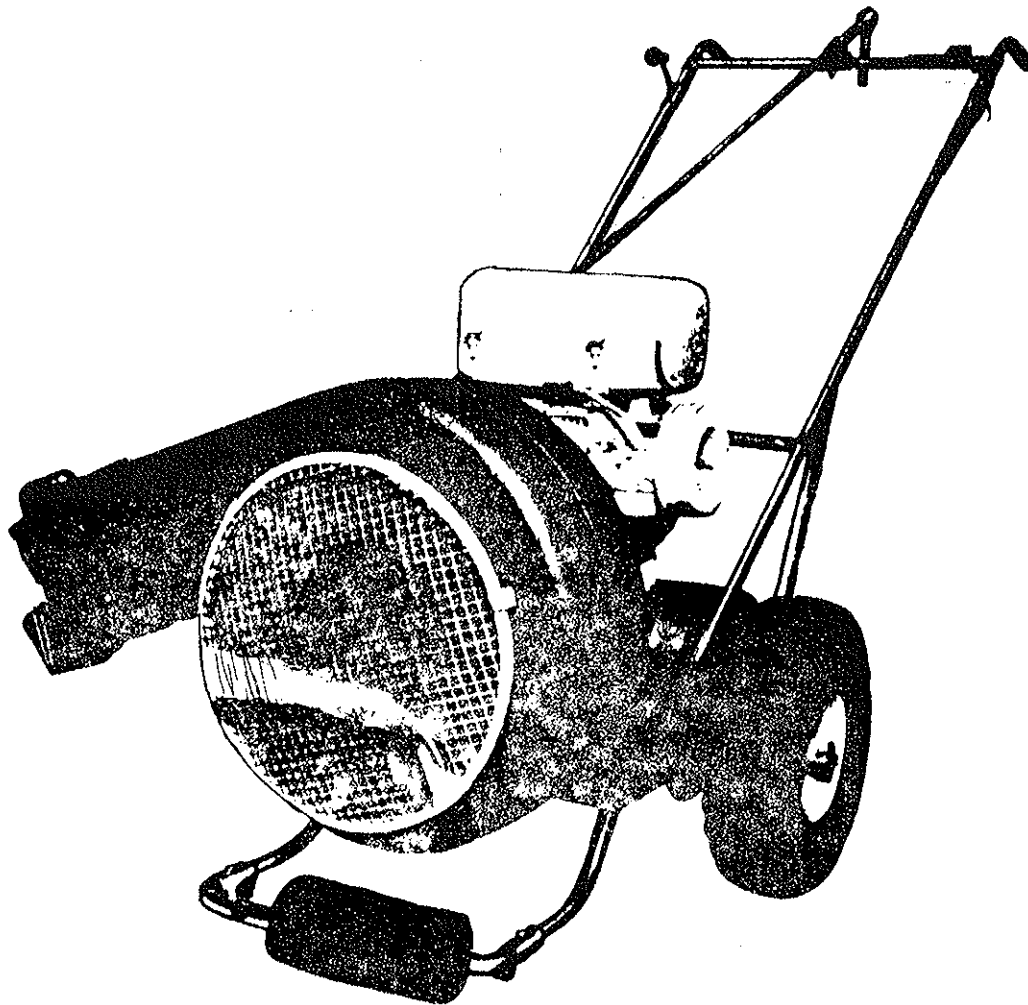

PARKER SWEEPER COMPANY    Box 1728    Springfield, Ohio 45501

## TO THE OWNER

These instructions were written to assist you in the assembly and operation of your hurricane. **READ THE INSTRUCTIONS** thoroughly **BEFORE** attempting to assemble and operate the machine so that you are familiar with the complete procedure and the safety precautions.

### RULES FOR SAFE OPERATION



The following safety precautions are suggested to prevent damage to the equipment or injury to the operator or nearby persons.

1. **TO PREVENT ACCIDENTAL STARTING ALWAYS REMOVE THE SPARK PLUG** before working on the engine or equipment driven by the engine.
2. **DO NOT RUN THE ENGINE IN AN ENCLOSED AREA.** Exhaust gases contain carbon monoxide which is an odorless and deadly poison.
3. **DO NOT FILL GASOLINE TANK WHILE ENGINE IS HOT OR RUNNING.** Spilling gasoline on a hot engine may cause a fire or explosion.
4. **DO NOT** leave machine unattended while running.
5. **DO NOT ALLOW** machine to blow in direction of people or objects that could be injured by blown materials.
6. **AVOID** operating machine in dangerous places where steep slopes or loose debris will endanger the safety of operator or other people.

### LUBRICATION

The only lubrication necessary is a couple drops of light oil on the throttle control lever and throttle wire where it enters the cable, also on the moving parts on the exhaust deflector.

### OPERATING INSTRUCTIONS

1. Before starting the engine, read the Operating and Maintenance Instruction Manual. Add proper gasoline and oil to correct level.
2. Engine should be "broken in" by running at ½ throttle for 30 minutes and full throttle for an additional 30 minutes.
3. Machine will operate effectively by either pushing or pulling.
4. Your Hurricane Blower can be used as either a Low Blow or Hi Blow depending on the application.
5. For moving heavy debris such as sticks, cleaning out flower beds, anything heavier than leaves, use the Low Blow.
6. For controlled blowing of leaves into windrows and stacking use the Hi Blow.

### IMPORTANT

#### ALWAYS GIVE THE FOLLOWING INFORMATION WHEN ORDERING REPAIR PARTS:

- |                               |                           |
|-------------------------------|---------------------------|
| 1. Part Number (Not Ref. No.) | 3. Description of Part    |
| 2. Quantity Needed            | 4. Model No. of hurricane |

If unable to obtain parts locally, write down above information and send to:  
**PARKER SWEEPER CO., BOX 1728, SPRINGFIELD, OHIO 45501**

Your unit is right hand (R.H.) or left hand (L.H.) as you stand behind it.

## GENERAL INFORMATION

1. The unit covered by this owners guide is shipped complete in one box. Follow all instructions on assembly very carefully. Whenever a difference in instructions occurs either a separate instruction or an "Explanation Note" will be given.

Unpack cartons and check contents. If not correct, notify the factory to obtain parts needed. Do not discard any of the cartons or inner packing until machine is completely assembled.

3. Tip box over so blower housing is on top of engine. Pull unit out of box and stand it up. Move box out of the way. Whenever the terms Left and Right or L. and R. are used herein, it should be understood to mean from a position standing behind the unit facing in a forward direction.

## ASSEMBLY INSTRUCTIONS

### HANDLE ASSEMBLY

8. Remove contour bolts, hex nuts and lockwashers from the end of the upper handle. Insert upper handle assembly onto the lower handle, making sure holes at the end of upper handles are aligned with holes at top of lower handles. Reinsert contour bolts, add lockwashers and hex nuts.

9. Loosen torque knob on lower handle so handles are free to move. From behind the unit pull down on handles with both hands until top edge of pivot bracket reaches end of upper handle. Screw torque knob in until tight, so knob makes contact with lockwashers. Handles should be locked into position; if not, repeat above procedure.

10. Tighten all bolts and nuts. Bring nuts up to a "snug" position all the way around, check handle assembly for alignment and, if OK, then give each a final tightening. If alignment is needed, be sure nuts are just loose enough in all the joints to permit movement between the holes and the bolts. This should be enough to result in correct alignment. Do not bend tubing to accomplish proper position.

Be sure that the bolts are pulled down tight enough for one or more bolt threads to extend through the nut. It may be necessary to collapse the tube SLIGHTLY to accomplish this.

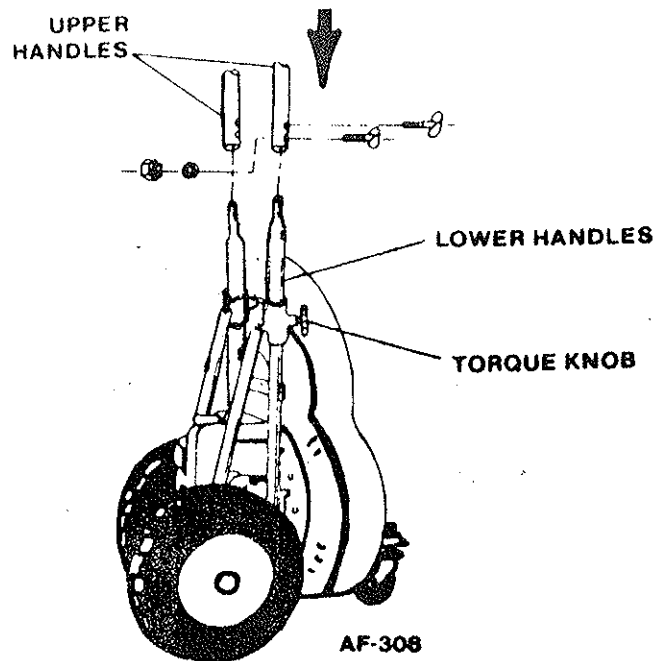

### IMPORTANT

**WARNING:** The engine contains NO OIL. Read the Engine Instruction Manual carefully before operating. Be sure you know how to start and stop the engine before proceeding further. Do not start the engine until all assembly is finished.

### Check Oil Before Starting!

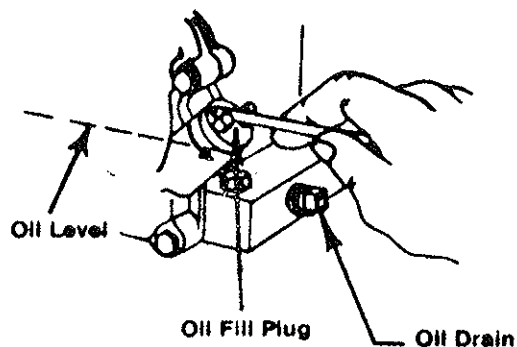

**BE SAFE. PROTECT YOUR FAMILY. YOUR FRIENDS. YOURSELF. OBSERVE ALL SAFETY INSTRUCTIONS.**

## KOHLER ENGINE THROTTLE HOOK-UP

Insert end of wire into small hole in throttle control lever on cross bar. The cable is attached to the throttle control lever bracket. At the lower end of throttle assembly, insert end of wire in small hole in throttle lever on engine as shown.

Loosen clamp screw and slip cable through clamp on the left side of the screw.

With about 1/8 inch of cable extending beyond clamp, tighten screw.

Check travel of throttle lever and adjust as follows. With the throttle lever on engine in the closed position, the lever on handle should be as shown in Fig. 10. Next, tighten boden wire nut on throttle lever to prevent slipping on throttle wire. Throttle assembly is now ready to test.

**NOTE:** If throttle does not stay open due to vibration of machine, tighten friction screw on lever assembly on cross bar until there is sufficient friction to hold throttle open.

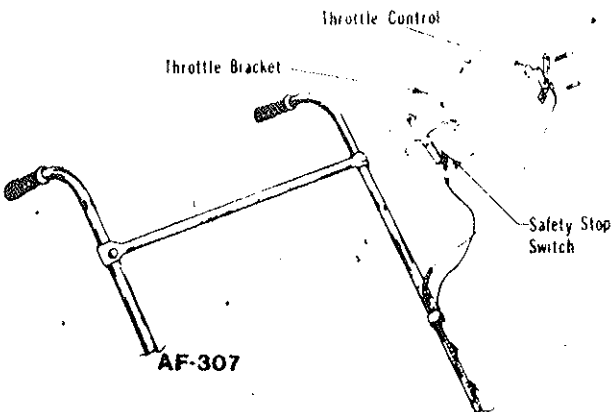
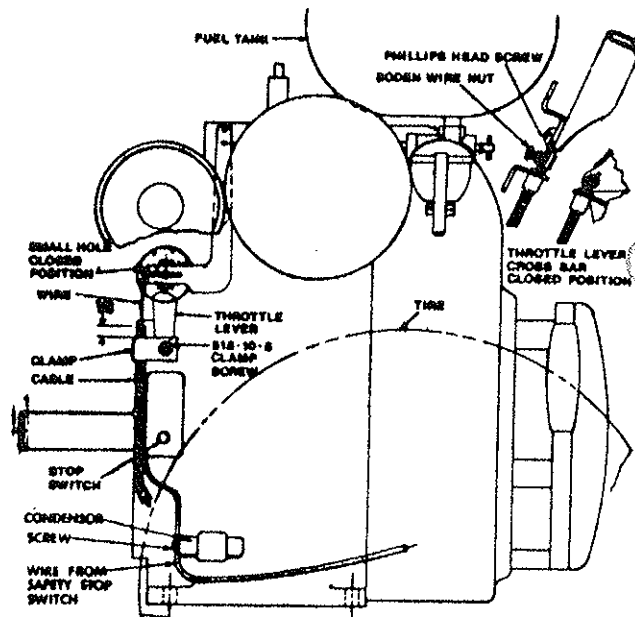

**A.** To install throttle control assembly and attach safety stop switch wire (where applicable), remove the throttle control assembly from the lower right hand handle. Straighten the throttle cable and run it up the left hand handle and attach to throttle bracket. Avoid placing sharp bends in the throttle cable.

**B.** Attach throttle cable to upper handle with snap on cable clamp which was removed on right bottom side. See handle assembly drawing for approximate location of clamps.

**C.** Hook throttle control to the bracket plate using the two oval head screws and two nuts furnished.

**D.** See drawing above for reference on assembly of stop switch on 8 H.P. Kohler Unit. Wrap the electric wire from the safety stop switch around the throttle control cable four or five times. **DO NOT** clamp electric wire under cable clamps. Make sure lower end of wire is attached to condenser section of engine; if not, see instructions on next page. Attach upper end of wire to stop switch on bracket by turning small screw part way out. Push wire terminal under small screw and tighten.

## Control Rod Installation

Slip the upper control rod through the weldment, then connect the lower control rod weldment to the deflector assembly. Telescope the control rods together and fasten with the 1/4-20x1 bolt, the internal tooth lock washer, and nut.

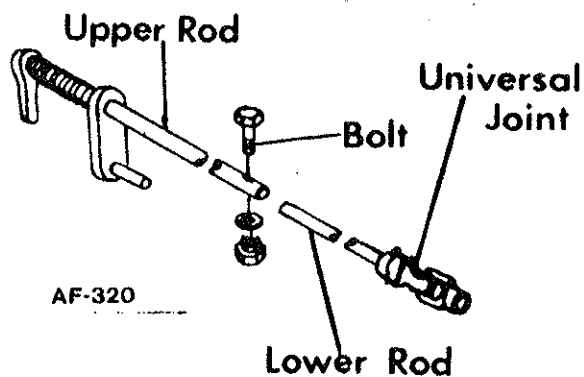

**SAFETY IS IMPORTANT!  
DO NOT IGNORE IT!  
OBSERVE IT!  
BE SAFE!**

## CONTROL ROD INSTALLATION

To attach Control Rod to Universal Joint, first remove cotter hairpin in Universal Joint and insert lower portion of Control Rod into Universal and reinsert cotter hairpin. Move control lever to make sure Exhaust Deft. Assembly is working correctly.

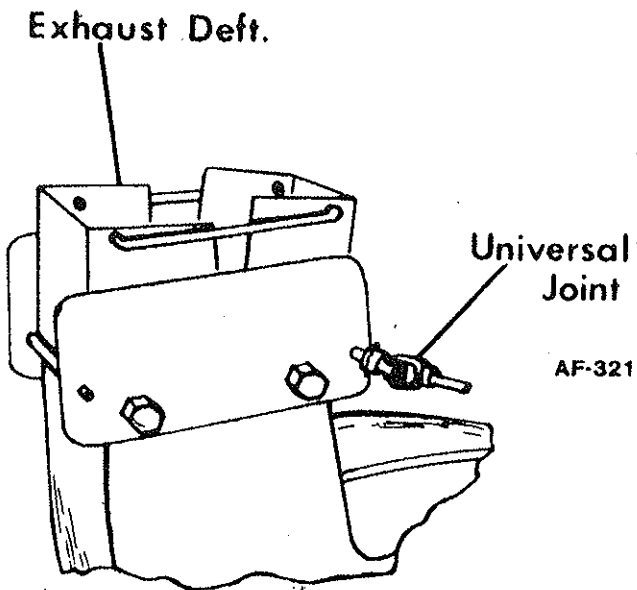

**NOTE:** Now tighten all the bolts and nuts.

## ASSEMBLY INSTRUCTIONS

1. This unit is equipped with a five speed transmission (five forward and one reverse speed). Note: Unit should always be started with transmission in neutral gear. Failure to do so can result in serious injury to operator and damage to unit.

4. Loosen  $\frac{1}{4}$ -20 nut (48) holding bracket (12) to handle assembly until bracket will slide back and forth for proper adjustment.

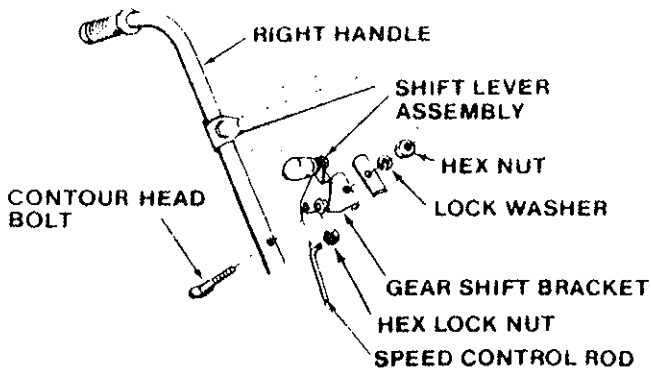

5. Speed control rod (19) should be inserted into the hole in shifter lever (13). Secure with hex nuts, (one on both sides of shifter lever). Before connecting control rod (19) at control arm (20), transmission must be in neutral gear (second from lowest lever position on transmission). Move shifter linkage (29) on transmission up or down to the neutral gear. Unit will be able to move back and forth freely if transmission is in neutral.

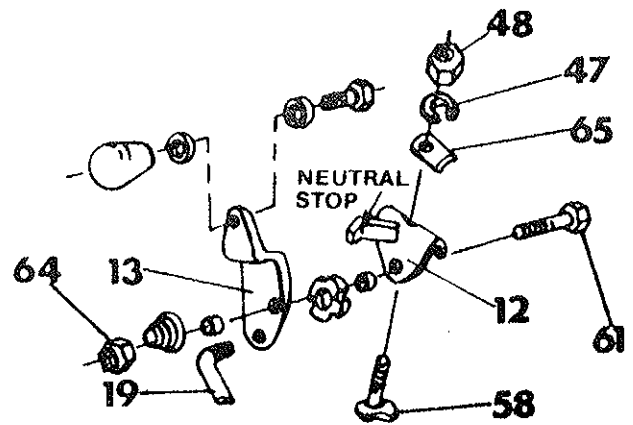

6. Slide bracket back and forth until other end of control rod (19) will align with hole in control arm on transmission. Be sure shifter lever (13) is resting against the neutral stop position while connecting control rod. Secure control rod with hairpin supplied.

7. Retighten hex nut (48) on bracket before going through any of the gears. With bracket tight, go through the forward gears and back to the neutral stop position on bracket. Unit should move back and forth freely if transmission is in neutral. If unit does not move freely, repeat above instructions, being careful to rest the shift lever (13) against the neutral stop before retightening nut #48.

## CHAIN ADJUSTMENT

Set the chassis upon 2 x 4's or equivalent. At then ends of the axle remove dowel pin, cotter pin and pull wheels off the axle. The axle bearings are now accessible for adjustment. With a  $\frac{5}{16}$  crescent wrench, loosen the nuts holding the bearings on both sides of the machine.

To tighten chain slack, push the axle forward. Make sure that the bearings are moved forward the same amount on both sides. Check this by seeing if the same amount of the slot is visible on the bearings on both sides. Tighten the nuts with a crescent wrench. Slide the wheels onto the axles and reinsert the dowel pin and cotter pin. If chain needs to be loosened repeat same procedure, only pulling axle back just slightly.

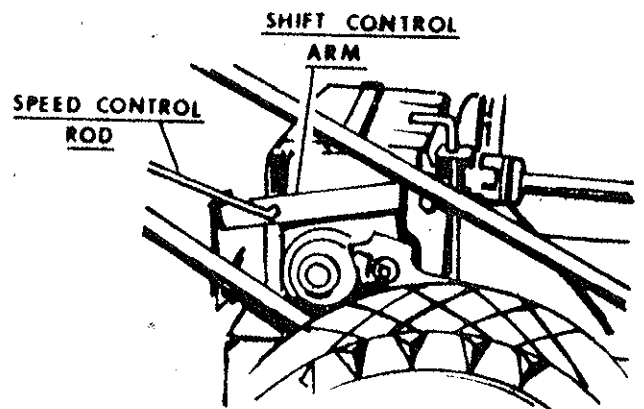

## OPERATING INSTRUCTIONS

**ADJUSTING THE BLOWER HOUSING TO HI OR LOW BLOW ENGINE MUST BE STOPPED WITH THE SPARK PLUG WIRE DISCONNECTED.**

To adjust the Blower Housing to a desired position, turn the Knob counter-clockwise to loosen. Pivot the Exhaust Deflector to the desired position, and tighten the knob.

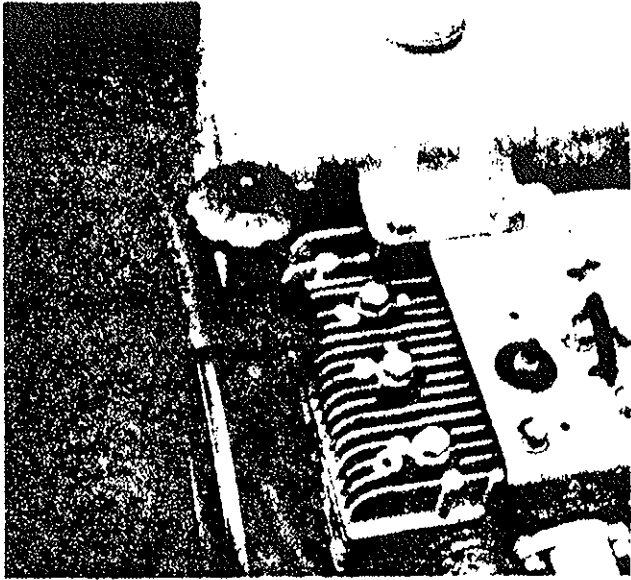

It is not necessary to detach the Exhaust Deflector Control Rod Assembly. It will pivot with the Blower Housing to any position.

By turning the Knob on the Control Rod Assembly fastened to the Upper Cross Bar, the deflection angle can be changed to control the air flow from the Exhaust Deflector.

Blower Housing in the Low Blow position.

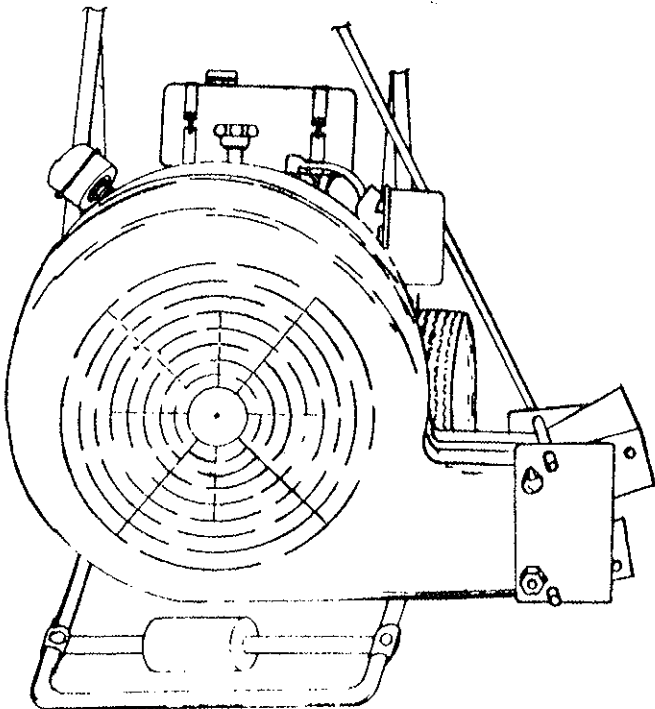

Blower Housing in the Hi Blow position.

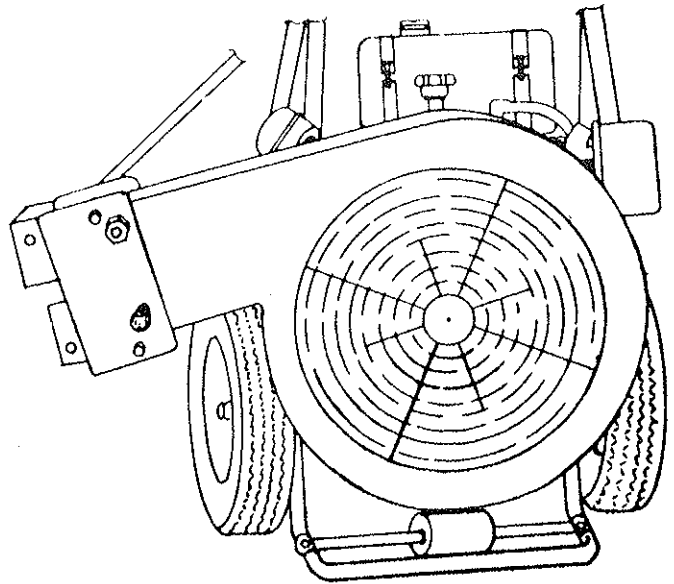

### 4. Belt Adjustment

A. Remove guard (37). Loosen bolts (32) which secure the bracket (55).

B. Bracket (55) has slots which permit the sheave to be moved. By moving bracket, belt tension can be adjusted.

C. Slide the bracket (55) to the right side of the chassis. Tighten the bolts and check belt for tightness.

### 5. Belt Replacement

A. Belt can be replaced by removing the blower housing and fan.

B. Remove the spark plug to insure that engine cannot be started.

D. Loosen bolts which secure bracket (55) to the chassis. Remove and discard old belt. Install new belt and adjust bracket (55) so that belt tension is correct. Correct belt tension is achieved when, with moderate force applied by a finger, the top of the belt can be pressed downward about  $\frac{1}{8}$ ".

## OPERATING INSTRUCTIONS

**WARNING:** The engine contains NO OIL. Read the Engine Instruction Manual carefully before operating the Hurricane. Be sure you know how to start and stop the Engine before proceeding further. Do not start the engine until all assembly is finished.

# INSTRUCTIONS FOR REMOVING OR INSTALLING THE BLOWER HOUSING

**CAUTION:** Before starting to work on the Engine or the equipment driven by the Engine, always remove the spark plug to prevent accidental starting.

## To Remove the Blower Housing:

Push the handle of the Hurricane down until the handle is resting on the ground, then push the blower guard down until it is also resting on the ground.

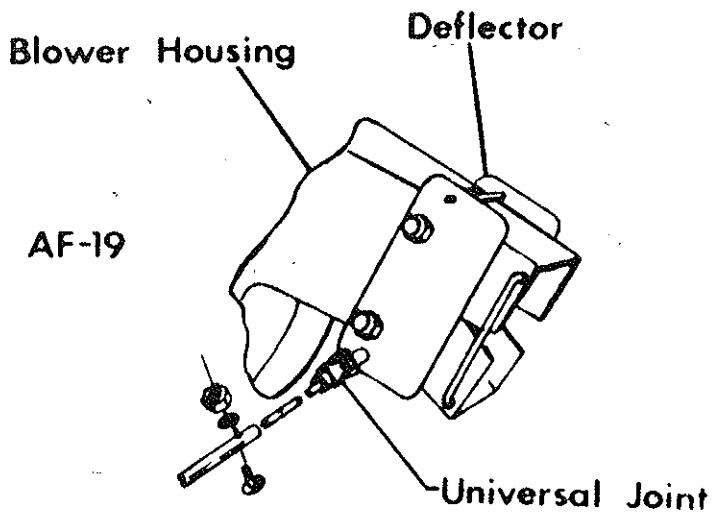
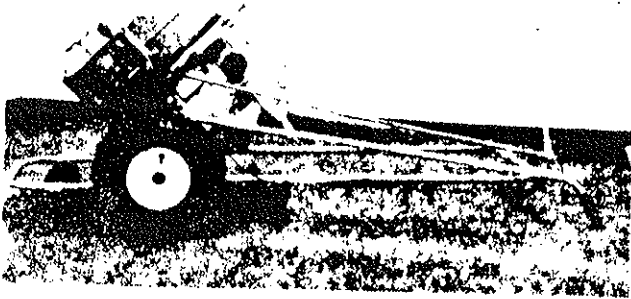

To loosen the top of the blower housing, unscrew the acorn nut and knob and remove the washer, spacer and clamp.

To loosen the bottom of the blower housing, remove the roller guides by unscrewing the nuts on each side. Remove the lock washers and pull out the roller guides bringing the bolts, washers and spacers with them.

Remove the blower housing by lifting it off the fan.

## To Install the Blower Housing:

Place the blower housing over the fan and position the pivot ring against the back plate.

Re-insert the bolts with the roller guides, washers and spacers. Add the washer, screw on the nut, and tighten.

At the top of the housing, replace the clamp, spacer, washer and screw on the knob and acorn nut.

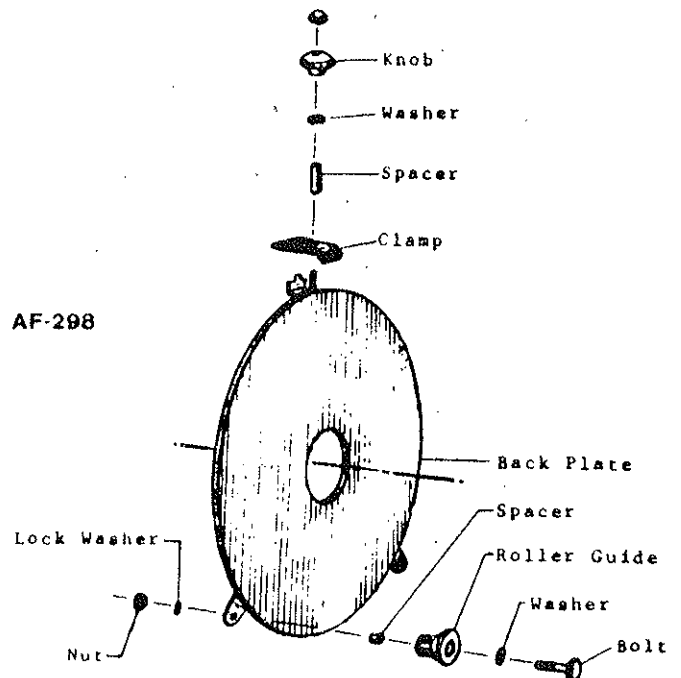

**CAUTION:** Replace the spark plug, but before attaching the ignition wire to the spark plug, pull the recoil starter cord to rotate the fan, to make sure the fan can rotate freely.

Attach the ignition wire to the spark plug and your Hurricane Blower is ready for operation.

# OPERATING INSTRUCTIONS

## FOR SAFE OPERATION

TO PREVENT ACCIDENTAL STARTING ALWAYS REMOVE THE SPARK PLUG before working on the engine or equipment driven by the engine.

DO NOT RUN THE ENGINE IN AN ENCLOSED AREA. Exhaust gases contain carbon monoxide which is odorless and deadly poison.

DO NOT FILL GASOLINE TANK WHILE ENGINE IS HOT OR RUNNING. Spilling gasoline on a hot engine may cause a fire or explosion.

DO NOT leave machine unattended while running.

DO NOT ALLOW machine to blow in direction of people or objects that could be injured by blown materials.

AVOID operating machine in dangerous places where steep slopes or loose debris will endanger the safety of operator or other people.

Transmission MUST be in NEUTRAL. Pull back on gear shift until stop is reached.

Move SAFETY STOP switch to UP position.

Transmission has one reverse and five progressive forward speeds.

After engine has started, release the BRAKE by twisting lever and letting it slide down.

Push gear shift lever forward to first speed; continue to push gear shift lever forward until desired speed is reached.

**NOTE:** Transmission has five forward progressive speeds. Unit will always move from first thru each of the five speeds. Unit cannot be moved from neutral to higher speed without going thru the lower speeds.

To STOP unit, place gear shift lever in NEUTRAL, and move SAFETY STOP switch to DOWN position. Pull up and twist brake lever to lock in ON position.

Engine should be "broke in" by running at 1/2 throttle for 30 minutes and full throttle for an additional 30 minutes.

Your Hurricane Blower can be used as either a Low Blow or Hi Blow depending on the application.

For moving heavy debris such as sticks, cleaning out flower beds, anything heavier than leaves, use the Low Blow.

For controlled blowing of leaves into windrows and stacking, use the Hi Blow.

Transmission is in neutral and parking brake is in the ON position.

**NOTE:** Do not operate the machine without first releasing the parking brake. To do so places an undue strain on the transmission and may cause premature failure.

## LUBRICATION

A. Lubricate the wheel bearings once a week if used daily. A few drops of oil applied to the chain and the throttle control cable and wire will keep it operating smoothly.

**NOTE:** Refer to engine operating instructions for proper lubrication of the engine.

**CAUTION:** DO NOT WORK ON HURRICANE repairs with engine running or idling. Bring to a DEAD STOP. Remove spark plug on engine models. When changing attachments, bring engine to a complete stop.

For easy rolling, keep the tires inflated to 25 pounds pressure.

**KOHLER ENGINES.** The stop switch is located on the lower left side of the engine below the exhaust and on the handle.

## SERVICING AND OPERATING INSTRUCTIONS

Refer to Engine Manufacturers Service Manual. Careful attention to care of air cleaner and crankcase lubrication instructions will insure longer engine life. KEEP ENGINE CLEAN.

## HOW TO ORDER REPAIR PARTS

1. Give the model and serial number, found on the back of chassis lower right hand side.
2. Write the complete part number as well as the description of the part, and quantity of part required.

## ALWAYS GIVE THE FOLLOWING INFORMATION WHEN ORDERING REPAIR PARTS:

1. PART NUMBER (Not Ref. No.)
2. QUANTITY NEEDED
3. DESCRIPTION OF PART
4. MODEL No. HC-8180-AK-SP

If unable to obtain parts locally, write down above information and send to:  
PARKER SWEEPER CO., BOX 1728, SPRINGFIELD, OHIO 45501

Your unit is right hand (R.H.) or left hand (L.H.) as you stand behind it.

**IMPORTANT**



ENGINE ASSEMBLY

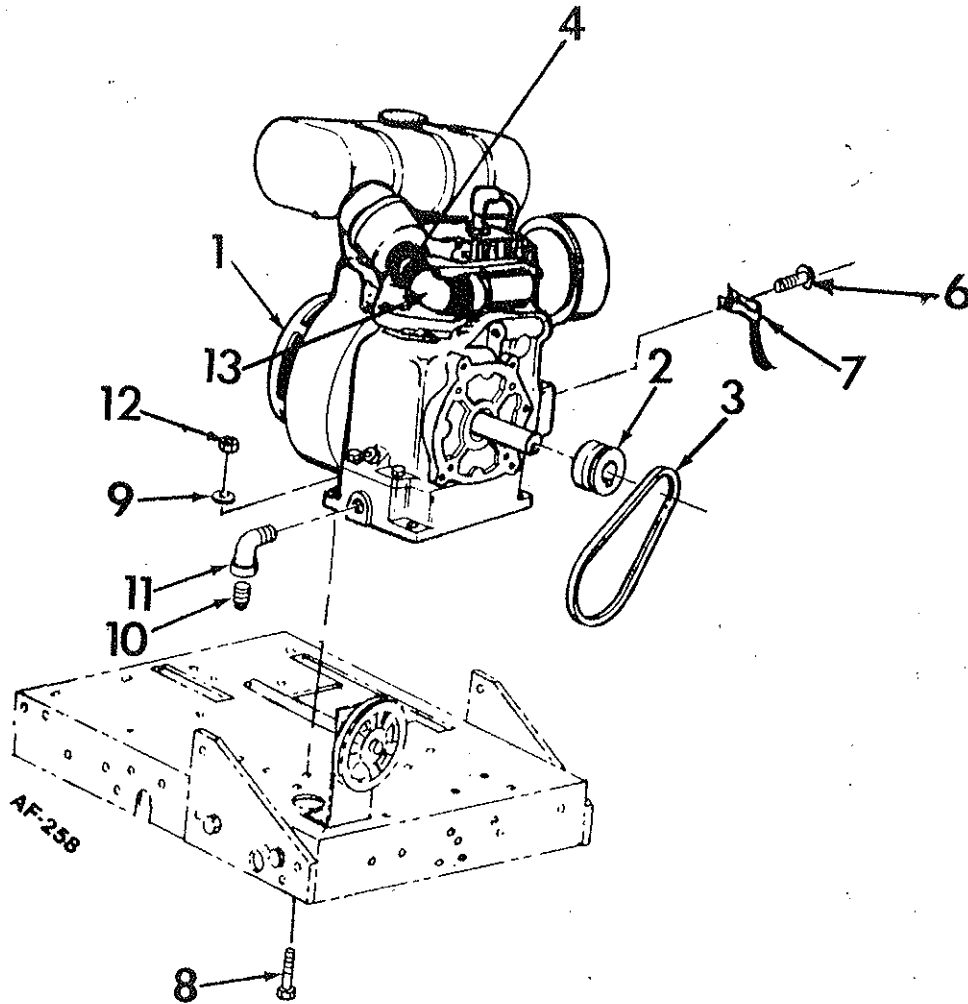

PARTS LIST

Ref. No.	Part No.	Qty. Per Unit	Description	Ref. No.	Part No.	Qty. Per Unit	Description
1	<del>78-12L-A</del>	1	Engine, Kohler	6	515-10-8	1	Screw 10-24 x 1/2 Rd. Hd.
2	74-119-A	1	Pulley, Engine	7	75-115-A	1	Throttle Cable Clip
3	73-417-A	1	V Belt 3L-210	8	65-616-20	4	Bolt 3/8-16 x 1 1/4 Hex Hd.
4	<del>67-68-A</del>	1	Pipe Nipple 1 x 1	9	945-616	1	Flat Washer, 3/8
				10	***	1	Pipe Plug, Oil Drain
				11	57-81 A	1	Street Elbow 1/2 x 90°
				12	365-616	1	Nut 3/8-16, Hex Hd. Lock
				13	<del>69-125-A</del>	1	Elbow, Street 1" x 45°
							***Supplied With Engine

CHASSIS & DRIVE ASSEMBLY

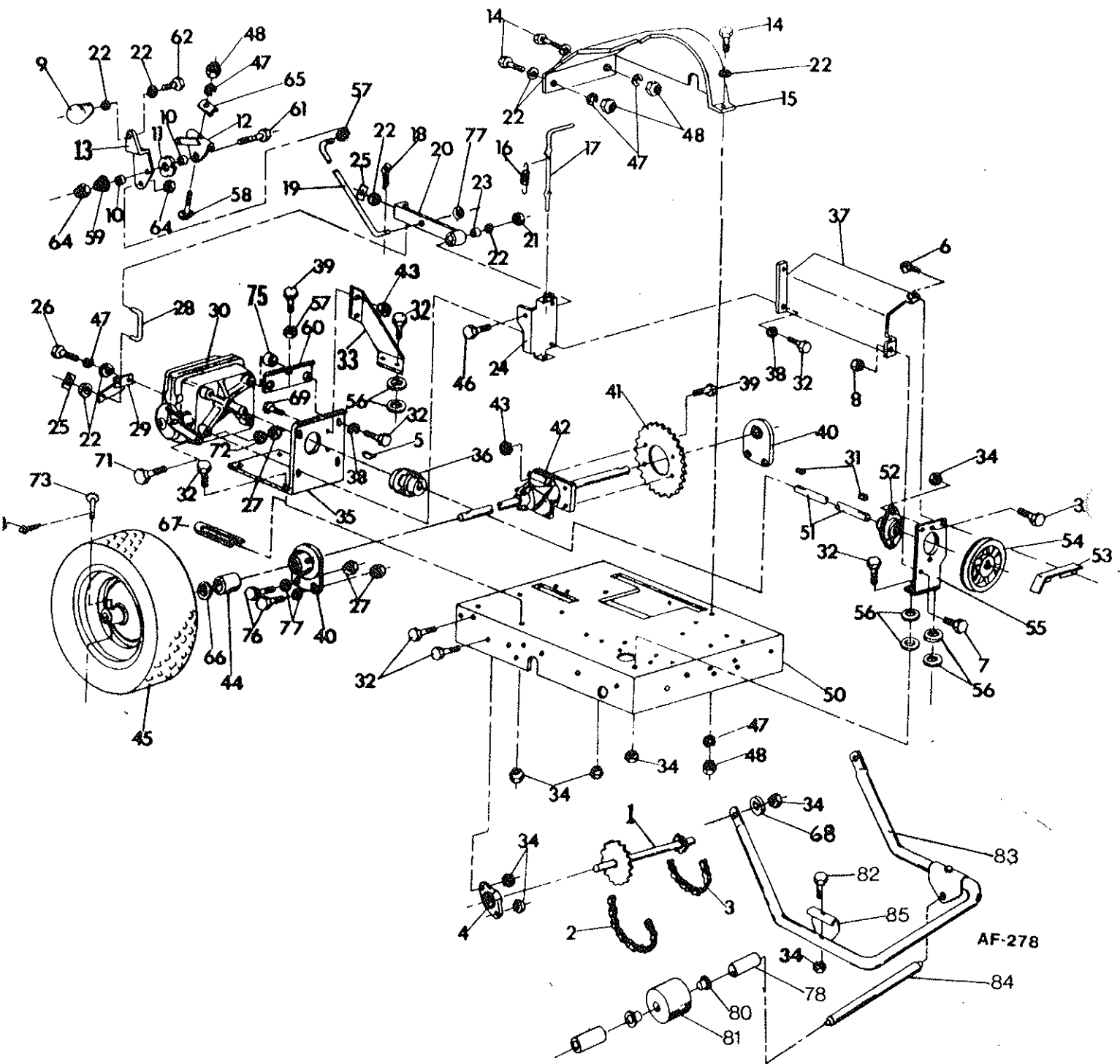

AF-278

## CHASSIS &amp; DRIVE ASSEMBLY

## PARTS LIST

Ref. No.	Part No.	Qty. Per Unit	Description	Ref. No.	Part No.	Qty. Per Unit	Description
1	81-25-B	1	Jack Shaft Weldment	40	SA-817-B	2	Bearing Assy. Modification
2	<del>74-117-A</del>	1	Chain, Roller #41-32p <del>84-41-32-B</del>	41	74-100-C	1	Sprocket Differential, 40 Teeth
3	<del>74-118-A</del>	1	Chain, Roller #41-50p <del>84-41-50-B</del>	42	<del>SA-459-B</del>	1	Differential Assy. <del>MA-588-C</del>
4	74-116-A	2	Bearing Assy. Side Flange	43	364-516	4	Nut, 5/16-18 Hex Lock Thin
5	280-09	1	#9 Woodruff Key Supplied	44	74-168-A	2	Wheel Spacer
6	<del>630-7-6</del>	2	Screw #7 x 3/8 Type A Sheet Metal	45	68-310-B	2	Wheel Assy.
7	515-10-6	1	Screw #10 x 24 x 3/8 Rd. Hd.		68-311-B	2	Wheel
8	365-10	1	Nut #10 x 24 Hex Lock		68-312-A	2	Tire 5.30/4.50x6
9	75-79-A	1	Shifter Knob	46	65-416-24	1	Bolt, 1/2-20 x 1 1/2 Hex Hd.
10	54-227-A	2	Spacer	47	935-416	4	Lockwasher 1/4 Spring
11	68-28-A	1	Cupped Washer	48	335-416	3	Nut, 1/2-20 Hex Plain
12	80-287-A	1	Stop & Bracket Weldment	50	81-19-D	1	Chassis
13	70-67-A	1	Shift Lever	51	74-88-A	1	Drive Shaft
14	65-416-8	3	Bolt 1/2-20 x 1/2 Hex Hd.	52	66-41-A	1	Seal Master Bearing
15	<del>80-206-D</del>	1	Chain Guard 82-195-D	53	75-94-B	1	Belt Guard
16	74-167-A	1	Spring, Brake	54	74-86-A	1	Sheave, Drive
17	74-96-A	1	Brake Lever	55	74-87-C	1	Bearing Bracket
18	57-110-A	1	Hair Pin	56	945-516	8	Washer 5/16 Flat
19	<del>81-104-B</del>	1	Speed Control Rod	57	335-516	2	Nut, 5/16 Hex Plain
20	80-254-A	1	Control Arm Assy.	58	69-416-24	1	Bolt 1/2-20 x 1 1/2 Contour Hd.
21	365-416	1	Nut, 1/2-20 Hex Lock	59	80-162-A	1	Shifter Spring
22	945-416	1	Washer 1/4 Flat	60	80-227-A	1	Adjusting Plate Weldment
23	75-10-A	1	Spacer	61	515-516-12	1	Screw
24	74-95-D	1	Shift Control Bracket	62	65-416-8	1	Hex Bolt 1/2-20 x 1/2
25	75-89-A	2	Speed Nut	64	364-516	1	Locknut, 5/16-18
26	60-416-10	1	Bolt, 1/2-28 x 3/8 Hex Hd.	65	80-181-A	1	Clamp
27	365-616	5	Nut, 3/8-16 Hex Lock	66	66-431-A	2	Washer
28	80-255-A	1	Speed Control Link	67	80-203-A	2	Bracket Spacer
29	SA-851-B	1	Shifter Linkage Weldment	68	74-126-A	2	Spacer
30	SA-857-A	1	Transmission	69	65-516-10	2	Bolt 5/16-18 x 3/8 Hex Hd.
31	48-277-A	2	Key, 3/16 Square	71	65-616-20	1	Bolt 3/8-16 Hex Hd.
32	65-516-12	16	Bolt, 5/16-18 x 3/8 Hex Hd.	72	335-616	1	Nut 3/8-16 Hex Plain
33	74-94-B	1	Transmission Bracket Brace	73	80-44-A	2	Clevis Pin
34	365-516	10	Nut 5/16-18 Hex Lock	74	380-332-8	2	Cotter Pin
35	74-93-C	1	Transmission Bracket	75	80-202-A	2	Spacer
36	74-114-A	1	Flexible Coupling	76	65-616-16	4	Bolt 3/8-16-1 Hex. Hd.
37	75-95-C	1	Shaft Guard	77	945-616	4	Washer 3/8 Flat
38	935-516	4	Lockwasher, 5/16 Spring	78	80-340-A	1	Spacer
39	65-516-16	4	Bolt, 5/16-18 x 1 Hex Hd.				
				80	<del>66-432-A</del> OK	2	Bearing
				81	<del>66-436-A</del>	1	Roller SA-1390-B
				82	65-516-24	2	Bolt Hex Hd. 5/16-18x1 1/2
				83	80-338-C	1	Roller Support
				84	80-339-A	1	Axle
				85	81-02-A	2	Bracket

HANDLE ASSEMBLY

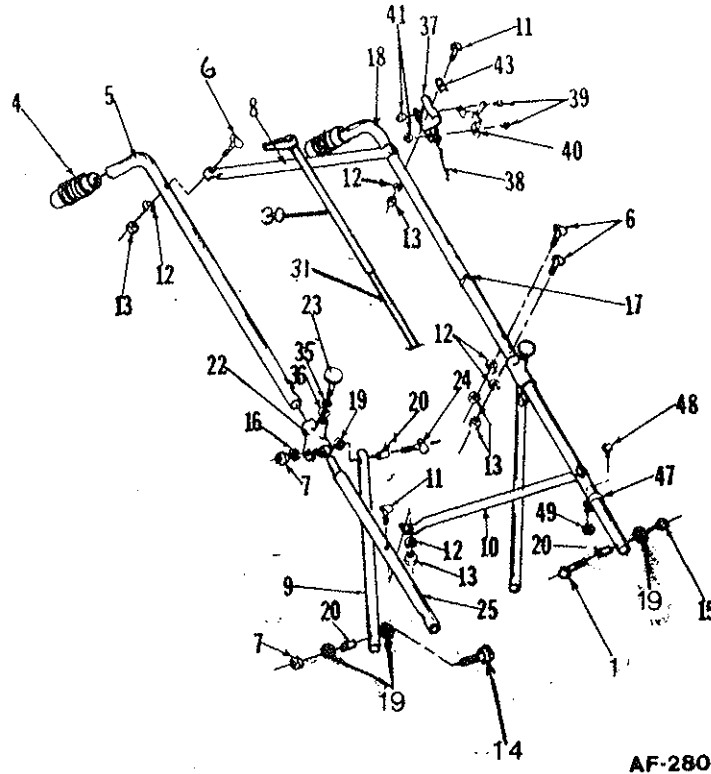

PARTS LIST

Ref. Part No.	Part No.	Description	Qty. Per Unit SP	Ref. Part No.	Part No.	Description	Qty. Per Unit SP
1	65-516-32	Bolt 5/16-18 x 2 Hex. Hd.	2	25	81-60-B	Middle Handle	2
4	80-232-A	Handle Grip	2				
5	81-11-C	Handles	2				
6	69-416-24	Bolt, 1/4-20 x 1 1/4 Contour Hd.	8				
7	335-516	Nut, Hex Plain 5/16-18	2	30	<del>SA-951-B</del>	Upper Control Rod	1
8	<del>81-50-B</del>	Cross Brace, Upper	1	31	<del>SA-1004-43</del>	Lower Control Rod	1
9	<del>81-51-B</del>	Truss Brace	2				
10	81-58-B	Cross Brace, Lower	1				
11	69-416-28	Bolt, 1/4-20 x 1 3/4 Contour Hd.	2				
12	935-416	Lock Washer, 1/4 Spring	10	35	935-616	Lockwasher 3/8	2
13	335-416	Nut, 1/4-20, Hex Plain	10	36	936-616	Int. Tooth Lockwasher 3/8	2
14	65-516-28	Bolt, 5/16-18 x 1 1/4 Hex. Hd.	4	37	SA-928-A	Stop Switch Assy.	1
15	365-516	Nut, 5/16-18, Hex Lock	2	38	<del>81-56-A</del>	Switch Wire 83-27-B-40	1
16	935-516	Lockwasher 5/16 Spring	5	39	517-10-8	Screw 10-24-1/2 Hd.	2
17	80-276-A	Control Clamp, Snap	1	40	<del>81-48-A</del>	Throttle Control Assy. 83-25-B-09	1
18	365-8	Nut, Hex Lock 8-32	2	41	365-10	Nut, Hex. Lock. 10-24	2
19	945-516	Flatwasher 5/16	10				
20	80-238-A	Handle Inserts	6	43	80-181-A	Clamp	1
22	80-246-B	Pivot Bracket	2	45	80-237-A	Bag Guard	1
23	80-228-A	Knurled Torque Knob	2	46	80-267-A	Plane Tube Cape	1
24	69-516-28	Contour Bolt 5/16-18 x 1 1/4	2	47	81-88-A	Wire Clamp	1
				48	515-8-8	Screw, Rd Hd 8-32-1/2	1

BLOWER ASSEMBLY

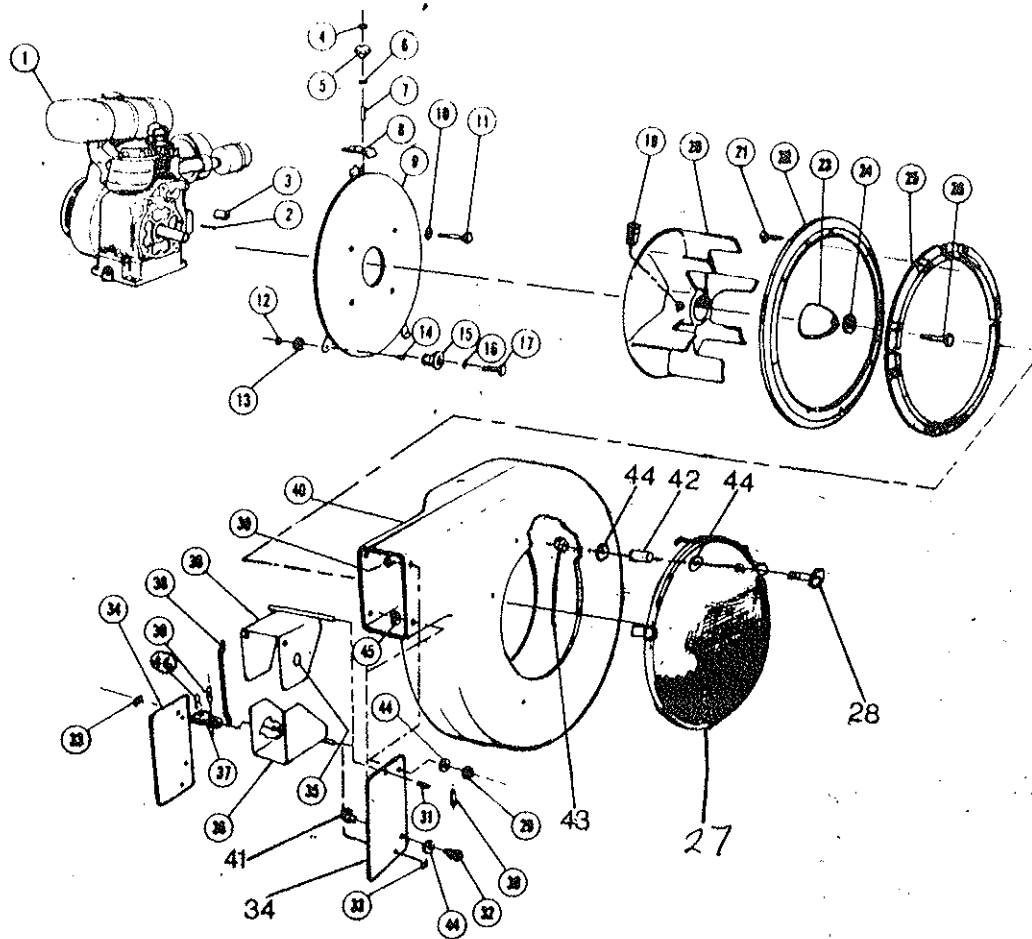

PARTS LIST

Ref. No.	Part No.	Qty. Per Unit	Description	Ref. No.	Part No.	Qty. Per Unit	Description
1	—	1	See Engine Assy	24	936-716	1	Washer, Int. Tooth
2	74-112-A	1	Fan Key $\frac{1}{4}$ Sq. x $2\frac{1}{2}$	25	73-123-C	4	Anti-Wrap
3	79-139-A	4	Spacer - Back Plate	26	<del>65-39-A</del>	1	Bolt - Fan
4	335-516-1	1	Nut, Lock 5/16-18	27	82-121-C	1	Grill
5	79-94-A	1	Knob, 5/16-18	28	515-416-24	4	Screw Rd.Hd.Mach. $\frac{1}{4}$ -20 x $1\frac{1}{2}$
6	945-516	1	Washer, 5/16	29	365-416	3	Nut - Hex Lock $\frac{1}{4}$ -20
7	79-67-A	1	Spacer	30	60-62-A	2	Roll Pin, $\frac{1}{8}$ Dia. x $\frac{1}{4}$
8	79-51-A	1	Clamp	31	73-372-A	1	Spring
9	80-316-C	1	Back Plate Weldment	32	75-79-A	1	Knob
10	935-616	4	Washer - Spring Lock $\frac{3}{8}$	33	75-80-A	2	Shaft, Retainer
11	65-616-24	4	Bolt - Hex Hd. $\frac{3}{8}$ -16 x $1\frac{1}{2}$	34	73-124-b	2	Exhaust, Side Plate
12	335-516	2	Nut, Hex, 5/16-18	35	73-106-A	1	Friction Disc
13	935-516	2	Washer, Lock 5/16	36	73-125-B	2	Exhaust Deflt. Weld.
14	80-101-A	2	Bushing	37	<del>81-65-A</del>	1	Universal Joint $\varnothing 2 - 25/1-A$
15	80-144-A	2	Guide, Roller	38	73-126-A	1	Link, Exhaust Defl.
16	945-516	2	Washer, 5/16	39	65-416-12	3	Bolt, Hex Hd. $\frac{1}{4}$ -20 x $\frac{3}{4}$
17	65-516-20	2	Bolt, Hex Hd., 5/16-18 x $1\frac{1}{4}$	40	73-79-F	1	Blower Housing
19	564-C-516-6	1	Screw Set 5/16-18 x $\frac{3}{8}$	41	65 416 10	1	Bolt Hex.Hd. $\frac{1}{4}$ -20 x $\frac{5}{8}$
20	73-118-D	1	Fan	42	82-142-A	4	Spacer
21	505-416-20	8	Screw - Flat Hd $\frac{1}{4}$ -20 x $1\frac{1}{4}$	43	364-416	4	Nut Hex.Lock $\frac{1}{4}$ -20
22	79-129-C	1	Pivot Ring	44	945-416	12	Washer Plain $\frac{1}{4}$
23	<del>73-118-A-3</del> 82-138-B-3 935-716 70-716-16	1	Retainer, Fan	45	935-416	1	Lockwasher Spring $\frac{1}{4}$
				46	81-106-A	1	Cotter Hairpin

# PEERLESS TRANSMISSION

## MODEL 750-A

Five Speed

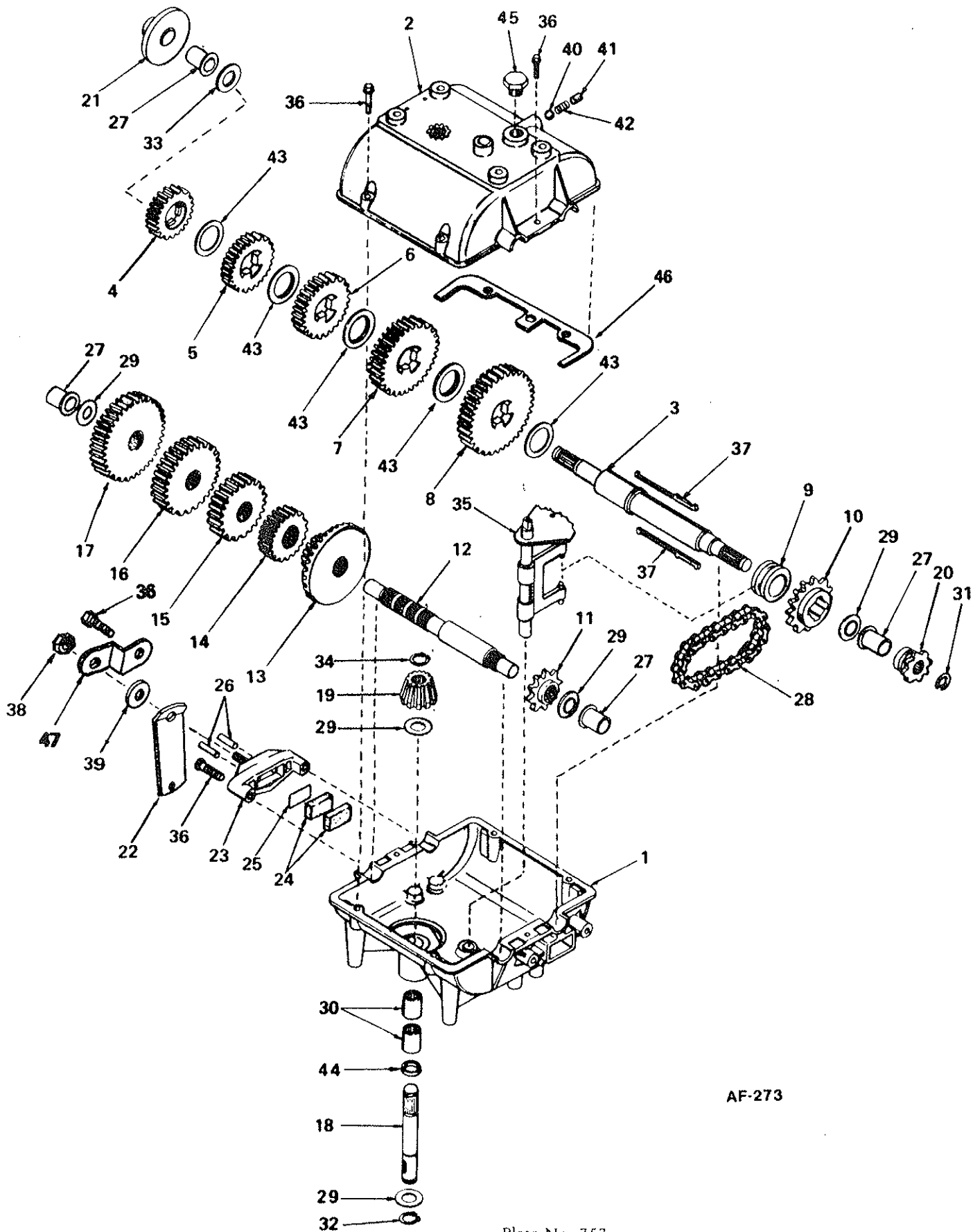

AF-273

## PEERLESS "750"-A TRANSMISSION

## PARTS LIST

Ref. No.	Part No.	Description
1	770061	Case, Transmission
2	772083	Cover, Transmission
3	776161	Shaft, Output & Brake
4	778121A	Gear, Spur (20 teeth)
5	778122A	Gear, Spur (22 teeth)
6	778123A	Gear, Spur (25 teeth)
7	778124A	Gear, Spur (30 teeth)
8	778125	Gear, Spur (35 teeth)
9	784266	Collar, Shift
10	786060	Sprocket (14 teeth)
11	786061	Sprocket (10 teeth)
12	776134	Shaft, Counter
13	778109	Gear, Bevel (42 tooth & 15 tooth spur gear)
14	778126A	Gear, Spur (20 teeth)
15	778127A	Gear, Spur (25 teeth)
16	778128A	Gear, Spur (28 teeth)
17	778129A	Gear, Spur (30 teeth)
18	776135	Shaft, Input
19	778113A	Bevel Pinion, Input
20	786047	Sprocket (8 teeth)
21	790003	Disk, Brake
22	790013	Lever, Brake
23	790025	Holder, Brake pad
24	790006	Pad, Brake
25	790007	Plate, Brake pad
26	786026	Pin, Dowel
27	780105A	Bushing, Flanged
28	786062	Chain, Roller (No. 41 chain, 22 links)
29	780072	Washer, Thrust
30	780086	Bearing, Needle
31	792072	Ring, Retaining
32	792035	Ring, Retaining
33	780109	Washer
34	788040	Ring, Retaining
35	784267	Rod & Fork Assy., Shift
36	792073	Screw, Hex. Hd. Taptite, 1/4-20x2 1/4
37	792089A	Key
38	792075	Nut, Lock, 5/16-24
39	792076	Washer, Flat, 5/16
40	792077	Ball, Steel, 5/16"
41	792078	Screw, Set, 3/8-16x3/8
42	792079	Spring
43	780108	Washer, Thrust
44	792001	"O" Ring
45	792074	Plug
46	788054	Gasket
47	786046	Bracket

Order all parts from your nearest PARKER PARTS DISTRIBUTORS. If unable to locate the part from your Parts Distributor forward your order to PARKER SWEEPER COMPANY for handling.

Hart-Greer, Inc. 900 No. 24th St. BIRMINGHAM, ALA. 35203	Frost Company 483 Wildwood St. WOBURN, MASS. 01801	Schroeder Sales & Service, Inc. 1144 Harrison Ave. HARRISON, OH. 45030	Goldthwaite's of Hous In 220 Fariss HOUSTON, TEX. 77025
Lawn & Garden Supply Co. 2222 N. 27th Ave. PHOENIX, ARIZ. 85017	Ideal Mower Sales, Inc. 811 Woodward Heights FERNDALE, MICH. 48220	Hershman's, Inc. 12477 Benner Rd. RITTMAN, OH. 44270	Goldthwaite's of Texas, Inc. 10751 Sentinel SAN ANTONIO, TEX. 78217
Lawn & Garden Supply Co. 5455 So. Nogales Highway TUCSON, ARIZ. 85706	Lorenz Service Company 2500 So. Pennsylvania Ave. LANSING, MICH. 48220	PARKER SWEEPER COMPANY Post Office Box 1728 SPRINGFIELD, OH. 45501 Phone: 513-323-4901	A-1 Eng. & Mower Company 437 East 9th Street SALT LAKE CITY, UT. 84111
H.V. Carter Company 1700 East 14th St. OAKLAND, CAL. 94606	R.L. Gould Company 3711 N. Lexington Ave. ST. PAUL, MINN. 55112	M.P.E. Sales, Inc. 25850 Chardon Rd. CLEVELAND, OH. 44143	Wetsel Seed Co. 941 N. Liberty HARRISONBURG, VA. 2280
Tarzana Mower & Engine Parts, Inc. 18750 Oxnard St. TARZANA, CAL. 91356	Hance Distributors 420 Excelsior Ave., West HOPKINS, MINN. 55343	Tri-County Sales & Service 15 North West Ave. YOUNGSTOWN, OH. 44502	The Bentley Company 4126 Airport Way, South SEATTLE, WASH. 98108
Colorado Outdoor Equip., Inc. 527 West Evans DENVER, COLO. 80223	Gunthers Service & Supply 7320 Wornall Rd. KANSAS CITY, MO. 64114	Wait Sales Company 406-10 S. Peoria, Box 1015 TULSA, OKLA. 74120	Northwest Mower, Inc. 926 N. 165th Street SEATTLE, WASH. 98133
Zaun Equipment Co. 2330 Bruner Ln., S.E. FORT MEYERS, FLA. 33908	Henzler, Inc. 2015 Lemay Ferry Rd. ST. LOUIS, MO. 63125	Baltz & Son Co. 9817 East Burnside PORTLAND, ORE. 97216	Polson Company 625 Lander Street SEATTLE, WASH. 98134
Zaun Equipment Inc. 1741 Hamilton St. JACKSONVILLE, FLA. 32210	Port Huron Machinery & Supply 801 Que Street LINCOLN, NEB. 68508	Polson Company 208 S. E. Hawthorne Blvd. PORTLAND, ORE. 97214	Polson Company East 210 Montgomery St. SPOKANE, WASH. 99205
Florida Turf & Garden 7275 N.W. 64th St. MIAMI, FLA. 33166	Arett Sales Corp. 1152 Markkress Rd. CHERRY HILL, N.J. 08034	Lawn & Golf Supply Co. 647 Nutt Rd. PHOENIXVILLE, PA. 19460	R.L. Gould 344 Berger St. GREEN BAY, WIS. 54302
Zaun Equipment Inc. 1140 So. Rio Grande Ave. ORLANDO, FLA. 32806	George Smith & Sons, Inc. 322 Broadway BETHPAGE, L.I., N. Y. 11714	Gardenville Supply Co., Inc. Route 611 PIPERSVILLE, PA. 18947	Four Seasons Equipment, Inc. 7373 South 6th St. OAK CREEK, WIS. 53154
Zaun Equipment Inc. 3032 44th Avenue, North ST. PETERSBURG, FLA. 33714	Grasslands Equip. & Irrigation 892 Troy Schenectady Rd. LATHAM, N.Y. 12110	Bluemont Co. 11125 Frankstown Road PITTSBURGH, PA. 15235	Farm & Tiller Sales, Ltd. 1205 E. Hastings Street VANCOUVER, B.C., CANADA
Wislar & Company Inc. 4505 Mills Place, S.W. ATLANTA, GA. 30336	Arett Sales Corp. Sharot St. & Portman Rd. NEW ROCHELLE, N. Y. 10801	Niemeyer Corp. 1135 Phoenixville Pike, Box 531 WEST CHESTER, PA. 19380	Robertson Seed, Ltd. 9241 - 48 St. EDMONTON, ALBERTA, CANADA
Geo. A. Davis 5440 Northwest Highway CHICAGO, ILL. 60630	Henry W. O'Neil & Associates, Inc. 410 No. Goodman St. ROCHESTER, N.Y. 14609	Fidelity Sales Corp. 6331 Baum Dr. KNOXVILLE, TENN. 37919	Morin Equipment, Inc. 90 Rue D'Anvers Parc Industriel ST. AUGUSTIN, QUEBEC, CANADA GOA 3EO
Plante's Lawn Equip. Inc. 4 Grant St. NORTH AURORA, ILL. 60542	The Messenger Company, Inc. 374 Avery St. ROCHESTER, N.Y. 14606	Fidelity Sales Corp. 447 E. Market St. KINGSPORT, TENN. 37662	Morin Equipment, Inc. 270 Industrial Park Road LONGUEVIL, QUEBEC, CANADA
T.E. Booher & Sons 1009 West State St. ALBANY, IND. 47320	American Hdwe. & Equip. 3940 Greensboro St. CHARLOTTE, N.C. 28206	Fidelity Sales Corp. 6044 Lee Highway CHATTANOOGA, TENN. 37421	Duke Lawn Equipment 1184 Plains Road, East BURLINGTON, ONTARIO, CANADA
Bruce Engine, Inc. 1791 N. W. 86th St. DES MOINES, IA. 50322	E.J. Smith & Sons 4250 Golf Acres Dr. CHARLOTTE, N.C. 28266	Goldthwaite's of Dallas, Inc. 2700 Forest Lane Box 34660 DALLAS, TEX. 75234	
Morton B. Collins 300 Birnie Avenue SPRINGFIELD, MASS 31106	Hayward Distributing Co. 460 Neilston St. COLUMBUS, OH. 43215	Goldthwaites of Ft. Worth 1401 Foch St. FT. WORTH, TEX. 76107	