

9/10/63

OPERATING INSTRUCTIONS AND PARTS LIST  
FOR

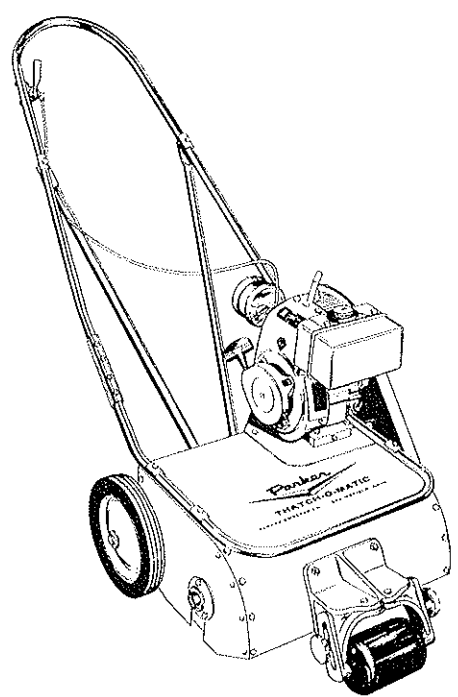

**PR-6316 THATCH-O-MATIC  
POWER RAKE**



NOTICE: These instructions were written to assist you in assembling your Power Rake quickly and correctly. Read instructions thoroughly before attempting assembly so that you are familiar with the complete procedure.

**PARKER SWEEPER COMPANY**

BOX 720

SPRINGFIELD, OHIO

## ASSEMBLY INSTRUCTIONS

1. Remove sweeper from carton and place on ground in upright position.
2. Assemble upper handle (Ref. No. 5, Fig. 1) to lower handle (Ref. No. 21, Fig. 2) with four hex hd. bolts and lock nuts (Ref. Nos. 2 and 3, Fig. 2). Don't tighten. Note: Be sure two small screws in upper handle are on the side opposite engine.
3. Assemble two braces (Ref. No. 1, Fig. 1) to bottom rear of back plate (Ref. No. 23, Fig. 2) with two hex hd. bolts and lock nuts (Ref. Nos. 6 and 7, Fig. 1). Don't tighten. Note: Be sure to use end of brace which has the greater bend.
4. Remove lock nut (Ref. No. 3, Fig. 1) from both sides of upper handle and assemble upper end of braces to handle. Tighten all loose nuts at this time.
5. Refer to front cover illustration for correct positioning of throttle cable and throttle handle. Remove two lock nuts (Ref. No. 49, Fig. 4) from inside of upper handle. Assemble throttle handle to upper handle. Tighten nuts.

## OPERATING INSTRUCTIONS

1. **IMPORTANT:** Before starting engine, read engine manual and add oil and gasoline as instructed.
2. Reset front roller to middle position. This is correct position for normal use.
3. When starting engine, throttle handle must be in idle (up) position because at higher RPM's the centrifugal clutch releases power to belt. Note: If engine fails to start, slightly increase throttle.
4. Operate engine at full throttle and work machine slowly across lawn for proper results.
5. If lawn is exceptionally tall, occasionally lift up on handle to permit thatch concentrations to escape.
6. Avoid stops on lawn for even a few seconds unless engine is idling or tines are raised above ground.

## MAINTENANCE INSTRUCTIONS

1. To tighten belt, loosen four engine bolts. Remove shims (Ref. Nos. 45 and 46, Fig. 4) from above engine base and insert under engine base as needed. Retighten engine bolts.
  2. To replace tines (Ref. No. 36, Fig. 3) (A) remove belt guard, belt, engine, pulley, and throttle handle from upper handle and set these parts aside. (B) Turn remaining unit upside down. (C) Remove two hex hd. bolts and lock washers (Ref. Nos. 7 and 27, Fig. 3) which hold bearing (Ref. No. 31) and lower half of aluminum casting (Ref. No. 39) to side plate; also remove lower half of casting on opposite side plate. (D) Remove three hex head bolts and lock nuts (Ref. Nos. 3 and 37, Fig. 3) which hold smaller aluminum castings (Ref. Nos. 25 and 40) to reel shaft. (E) Remove two halves of tine assembly (Ref. No. 35).
- NOTE: When reassembling pulley, grease end of reel shaft to prevent parts from rusting together; pulley should be flush with end of reel shaft.

## ALWAYS GIVE THE FOLLOWING INFORMATION WHEN ORDERING REPAIR PARTS

If you are unable to obtain parts locally, write to the factory for the name of nearest service dealer.

1. Part Number and Quantity.
2. Model Number (found on hood).
3. Serial Number (found on guarantee card).

Your unit is right hand (R.H.) or Left Hand (L.H.) as you stand behind it.

\*Standard hardware items may be purchased locally.

# PR6316 THATCH-O-MATIC SUPPLEMENTARY SHEET

-FOR SOFT POROUS LAWNS OR  
WHERE EXTREMELY HEAVY  
THATCH CONDITIONS EXIST-

THE PARKER THATCH-O-MATIC NOT ONLY HAS A FRONT ROLLER ADJUSTMENT BUT ALSO A REAR AXLE HEIGHT ADJUSTMENT. ALTHOUGH THE FRONT ROLLER WILL GIVE ADEQUATE ADJUSTMENT FOR MOST LAWNS AND LOCALITIES, SOMETIMES IT MAY BE NECESSARY TO RESET THE REAR AXLE. TO DO THIS:

- (1) BLOCK UP REAR OF MACHINE (SO BOTTOM OF WHEELS ARE ABOUT TWO INCHES ABOVE GROUND) WITH ANY FLAT OBJECT.
- (2) REMOVE RIGHT HAND WHEEL (WHEEL OPPOSITE BELT) AND THREE FLAT WASHERS.
- (3) LEAVING OTHER WHEEL IN PLACE, PULL AXLE OUT OF MACHINE AND INSERT IN LOWER HOLE. SLIDE AXLE BACK THRU MACHINE AND BRING OUT AT MATCHING HOLE ON OTHER SIDE.
- (4) REPLACE THE FLAT WASHER WITH THE NOTCH ONTO AXLE FIRST, THEN REPLACE REMAINING HARDWARE AND PARTS.

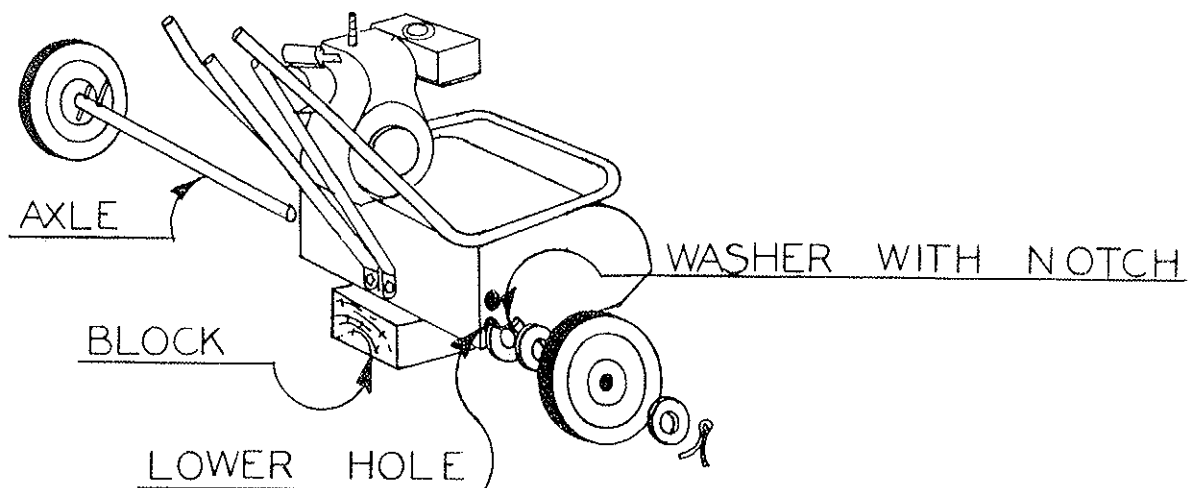



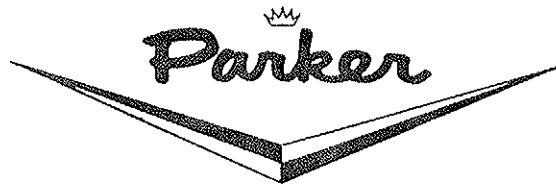

PARKER SWEEPER COMPANY      SPRINGFIELD, OHIO

# SERVICE BULLETIN

BULLETIN No. 001

Revised  
DATE January, 1972

SUBJECT ORDERING REPLACEMENT PARTS FOR PR-6316 THATCH-O-MATIC TINE REEL ASSEMBLY

RECENTLY SEVERAL IMPROVEMENTS WERE MADE IN THE PR-6316 THATCH-O-MATIC TINE REEL ASSEMBLY INCLUDING THE REEL SHAFT. THE IMPROVED PARTS ARE NOT INTERCHANGEABLE ON THE EARLY TYPE REELS, THEREFORE, YOU SHOULD CARRY SERVICE PARTS FOR BOTH THE EARLY AND LATE TYPE REEL ASSEMBLIES IN STOCK TO TAKE CARE OF YOUR CUSTOMERS.

PLEASE MAKE THE FOLLOWING CHANGES IN YOUR PARTS BOOK SECTION 5, PAGE 1:

REF.#34	946-816-16	FIBER WASHER CHANGE PART NUMBER TO 946-916-12
REF.#35	63-138-D	TINE ASSEMBLY ADD FOR 5/8" SHAFT BEFORE SERIAL NUMBER 5503332
<u>ADD</u> REF.#35A	64-95-D	TINE ASSEMBLY FOR 3/4" SHAFT AFTER SERIAL NUMBER 5503331
REF.#26	63-125-A	SPRING RETAINER ADD 5/16" ROD BEFORE SERIAL NUMBER 5503210
<u>ADD</u> REF.#26A	64-94-A	SPRING RETAINER 3/8" ROD AFTER SERIAL NUMBER 5503209
REF.#38	63-99-B	REEL SHAFT ADD 5/8" BEFORE SERIAL NUMBER 5503332
<u>ADD</u> REF.#38A	64-99-B	REEL SHAFT 3/4" AFTER SERIAL NUMBER 5503331
REF.#30	63-45-A	SHEAVE WITH 5/8" BORE ADD BEFORE SERIAL NUMBER 5503332
<u>ADD</u> REF.#30A	64-98-B	SHEAVE WITH 3/4" BORE AFTER SERIAL NUMBER 5503331
REF.#31	63-94-A	BEARING ADD FOR 5/8" SHAFT BEFORE SERIAL NUMBER 5503332
<u>ADD</u> REF.#31A	64-96-A	BEARING FOR 3/4" SHAFT AFTER SERIAL NUMBER 5503331
REF.#40	63-181-RB	BRACKET SEGMENT R.H. ADD FOR 5/8" SHAFT BEFORE SERIAL NUMBER 5503332
<u>ADD</u> REF.#40A	64-100-RB	BRACKET SEGMENT R.H. FOR 3/4" SHAFT AFTER SERIAL NUMBER 5503331, CHANGE QUANTITY REQUIRED TO 2
REF.#25	63-180-LB	BRACKET SEGMENT L.H. ADD FOR 5/8" SHAFT BEFORE SERIAL NUMBER 5503332
<u>ADD</u> REF.#25A	64-101-LB	BRACKET SEGMENT L.H. FOR 3/4" SHAFT AFTER SERIAL NUMBER 5503331
REF.#39	63-30-C	BRACKET SEGMENT - CHANGE PART NUMBER TO 64-49-B AND QUANTITY REQUIRED TO 2 - ALSO ADD BEFORE SERIAL NUMBER 5503332
<u>ADD</u> REF.#39A	64-102-B	BRACKET CENTER SEGMENT AFTER SERIAL NUMBER 5503331
REF.#37	65-416-28	HEX HD. BOLT 1/4 - 20 x 1-3/4 ADD BEFORE SERIAL NUMBER 5503332
<u>ADD</u> REF.#37A	65-516-28	HEX HD. BOLT 5/16 - 18 x 1-3/4 AFTER SERIAL NUMBER 5503331



## PARTS LIST

Ref. No.	Part No.	Description	No. Req.	Ref. No.	Part No.	Description	No. Req.
1	<del>63-35-C</del>	Brace	2	32	60-62-A	Roll Pin	16
2	*65-416-24	Hex Hd. Bolt ¼-20 x 1½	14	33	<del>63-124-A</del>	Spring Rod	4
3	365-416	Elastic Lock Nut ¼-20	39	34	946-816-16	Fiber Washer, ½ x 1	208
4	59-77-A	Tube Clamp	6	35	<del>63-138-D</del>	Tine Assembly	Set of 2
5	<del>63-37-D</del>	Upper Handle	1	36	60-92-B-1	Tine	104 <i>105</i>
6	365-516	Elastic Lock Nut ⅝-18	8	37	*65-416-28	Hex Hd. Bolt ¼-20 x 1¾	3
7	*65-516-12	Hex Hd. Bolt ⅝-18 x ¾	10	38	<del>63-99-B</del>	Reel Shaft	1
8	<del>53-44-B</del>	Handle Clamp	4	39	<del>63-30-C</del>	Bracket Segment	4
9	<del>63-32-C</del>	Belt Guard	1	40	<del>63-181-RB</del>	Bracket Segment, R.H.	2
10	<del>63-129-A</del>	Mounting Bracket	1	41	<del>63-42-A</del>	Engine	1
11	<del>57-179-A</del>	Roll Pin	3	42	<del>63-43-A</del>	Centrifugal Clutch	1
12	<del>63-46-B</del>	Axle	1	43	61-65-A	Engine Key	1
13	<del>63-47-A</del>	Wheel <i>66-228-B</i>	2	44	<del>63-44-A</del>	Belt	1
14	*945-1216	Flat Washer—S.A.E. ¾	4	45	<del>63-186-A</del>	Engine Shim, ⅙	2
15	*380-432-20	Cotter Pin ⅙ x 1¼	2	46	<del>63-25-A</del>	Engine Shim, ⅙	4
16	<del>63-127-LC</del>	Side Plate, L.H.	1	47	<del>63-39-B</del>	Inner Engine Plate	1
17	*65-416-12	Hex Hd. Bolt ¼-20 x ¾	10	48	<del>63-33-C</del>	Outer Engine Plate	1
18	<del>63-98-B</del>	Angle Support	1	49	365-10	Elastic Lock Nut No. 10	2
19	*65-416-8	Hex Hd. Bolt ¼-20 x ½	6	50	<del>47-228-B</del>	Throttle	1
20	<del>63-126-RC</del>	Side Plate, R.H.	1	51	*515-10-16	Rd. Hd. Screw, 10-24 x 1	2
21	<del>63-34-D</del>	Lower Handle	1	52	<del>63-203-G</del>	Roller Support	1
22	<del>63-97-B</del>	Reinforcement Plate	2	53	<del>61-97-C</del>	Roller Bracket	1
23	<del>63-41-F</del>	Back Plate	1	54	<del>61-96-B</del>	Pin	2
24	<del>63-128-D</del>	Hood	1	55	<del>59-47-B</del>	Adjusting Knob	2
25	<del>63-180-LB</del>	Bracket Segment, L.H.	4	56	*945-516	Flat Washer — S.A.E. ⅝	2
26	<del>63-125-A</del>	Spring Retainer Rod	4	57	*935-516	Lock Washer — Spring ⅝	2
27	*936-516	Lock Washer, ⅝	6	58	*70-516-32	Carriage Bolt, ⅝-18 x 2	2
28	<del>*564-C-516-4</del>	Allen Hd. Set Screw, ⅝ x ¼	1	59	*65-416-20	Hex Hd. Bolt, ¼-20 x 1¼	2
29	<del>63-132-A</del>	Special Key <i>250-1</i>	1	60	<del>62-92-B</del>	Roller	1
30	<del>63-45-A</del>	Sheave	1	61	<del>61-100-A</del>	Nylon Bearing	2
31	<del>63-94-A</del>	Bearing	2	62	*65-516-28	Hex Hd. Bolt, ⅝-18 x 1¾	2

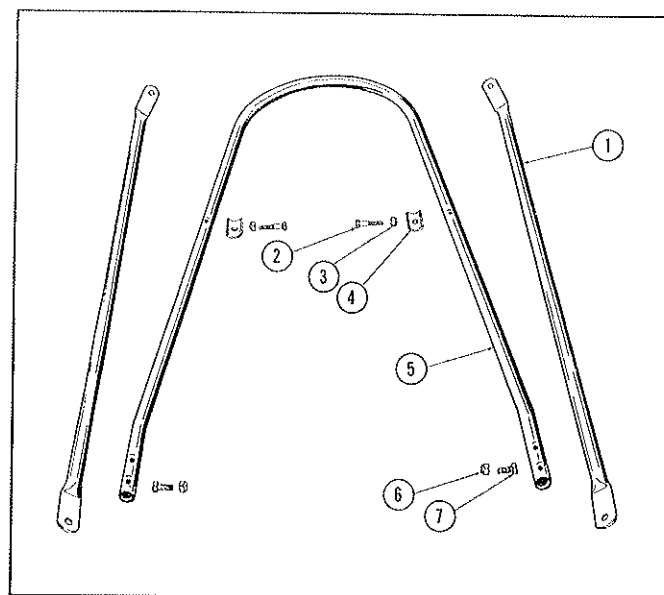

FIGURE 1

FIGURE 2

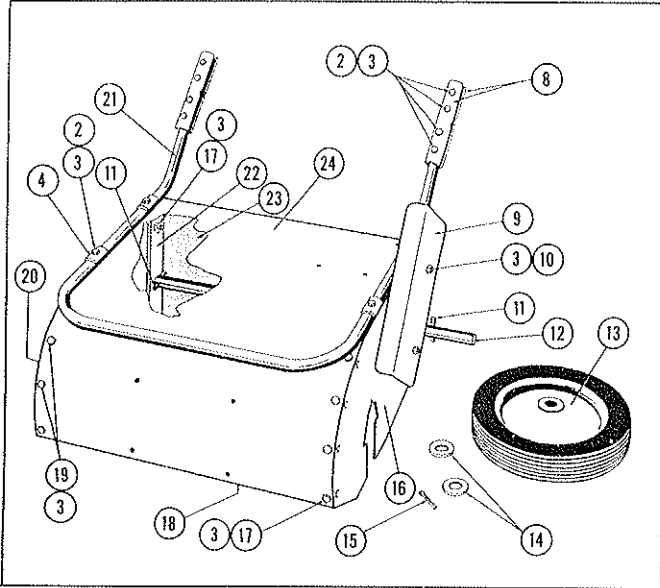

FIGURE 3

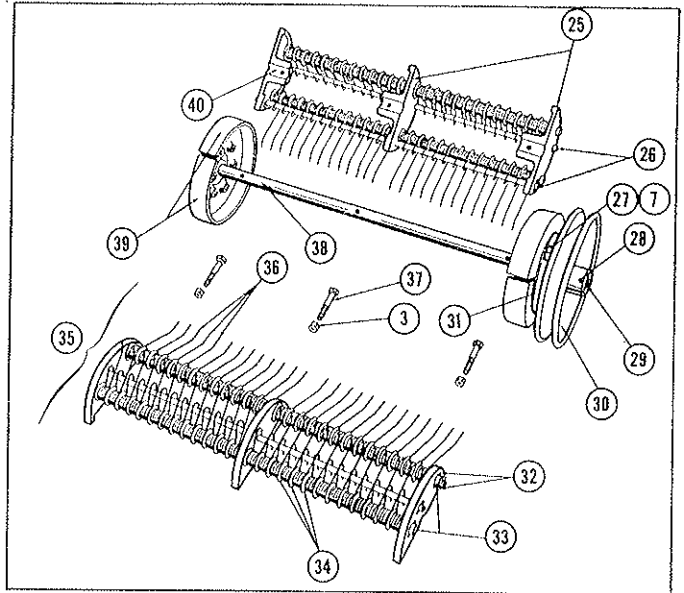

FIGURE 4

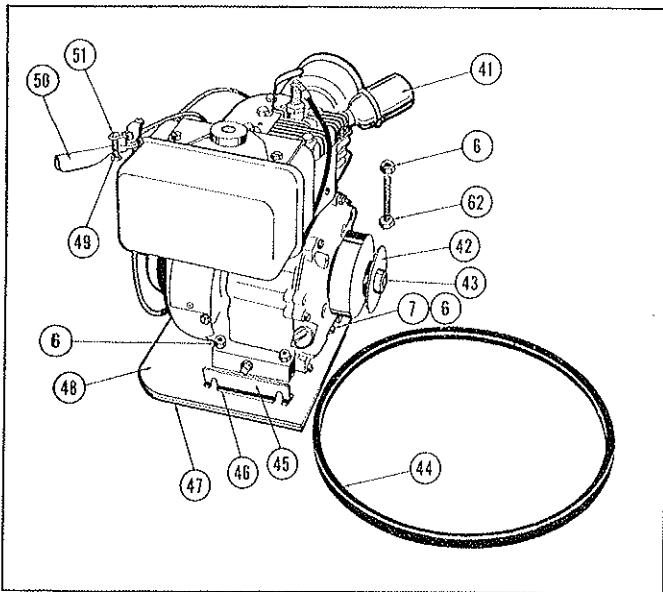
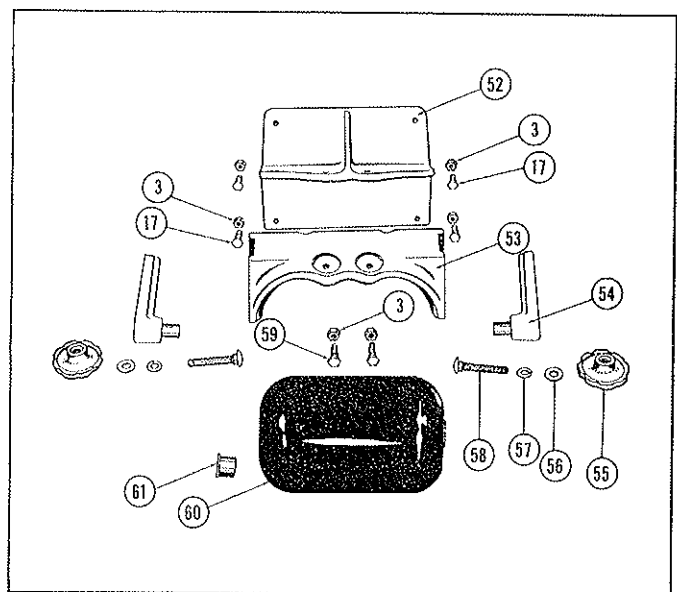

FIGURE 5





<b>THATCH-O-MATIC POWER RAKE</b>	SIZE <b>16"</b>	PRODUCTION YEAR <b>1963</b>	MODEL No. <b>PR-6316</b>
--------------------------------------	--------------------	--------------------------------	-----------------------------

**PARTS LIST**

Ref. No.	Part No.	Description	No. Req.	Ref. No.	Part No.	Description	No. Req.
1	63-35-C	Brace	2	32	60-62-A	Roll Pin	16
2	*65-416-24	Hex Hd. Bolt 1/4-20 x 1 1/2	14	33	63-124-A	Spring Rod	4
3	365-416	Elastic Lock Nut 1/4-20	39	34	946-816-16	Fiber Washer, 1/2 x 1	208
4	59-77-A	Tube Clamp	6	35	63-138-D	Tine Assembly	Set of 2
5	63-37-D	Upper Handle	1	36	60-92-B-1	Tine	104
6	365-516	Elastic Lock Nut 5/16-18	8	37	*65-416-28	Hex Hd. Bolt 1/4-20 x 1 3/4	3
7	*65-516-12	Hex Hd. Bolt 5/16-18 x 3/4	10	38	63-99-B	Reel Shaft	1
8	53-44-B	Handle Clamp	4	39	63-30-C	Bracket Segment	4
9	63-32-C	Belt Guard	1	40	63-181-RB	Bracket Segment, R.H.	2
10	63-129-A	Mounting Bracket	1	41	63-42-A	Engine	1
11	57-179-A	Roll Pin	3	42	63-43-A	Centrifugal Clutch	1
12	63-46-B	Axle	1	43	61-65-A	Engine Key	1
13	63-47-A	Wheel	2	44	63-44-A	Belt	1
14	*945-1216	Flat Washer—S.A.E. 3/4	4	45	63-186-A	Engine Shim, 1/16	2
15	*380-432-20	Cotter Pin 1/4 x 1 1/4	2	46	63-25-A	Engine Shim, 1/16	4
16	63-127-LC	Side Plate, L.H.	1	47	63-39-B	Inner Engine Plate	1
17	*65-416-12	Hex Hd. Bolt 1/4-20 x 3/4	10	48	63-33-C	Outer Engine Plate	1
18	63-98-B	Angle Support	1	49	365-10	Elastic Lock Nut No. 10	2
19	*65-416-8	Hex Hd. Bolt 1/4-20 x 1/2	6	50	47-228-B	Throttle	1
20	63-126-RC	Side Plate, R.H.	1	51	*515-10-16	Rd. Hd. Screw, 10-24 x 1	2
21	63-34-D	Lower Handle	1	52	63-203-C	Roller Support	1
22	63-97-B	Reinforcement Plate	2	53	61-97-C	Roller Bracket	1
23	63-41-F	Back Plate	1	54	61-96-B	Pin	2
24	63-128-D	Hood	1	55	59-47-B	Adjusting Knob <i>AW 79-94-A</i>	2
25	63-180-LB	Bracket Segment, L.H.	4	56	*945-516	Flat Washer — S.A.E. 5/16	2
26	63-125-A	Spring Retainer Rod	4	57	*935-516	Lock Washer — Spring 5/16	2
27	*936-516	Lock Washer, 5/16	6	58	*70-516-32	Carriage Bolt, 5/16-18 x 2	2
28	*564-C-516-4	Allen Hd. Set Screw, 5/16-1/4	1	59	*65-416-20	Hex Hd. Bolt, 1/4-20 x 1 1/4	2
29	63-132-A	Special Key	1	60	62-92-B	Roller	1
30	63-45-A	Sheave	1	61	61-100-A	Nylon Bearing	2
31	63-94-A	Bearing	2	62	*65-516-28	Hex Hd. Bolt, 5/16-18 x 1 3/4	2
				63	63-232-C	Deflector	1

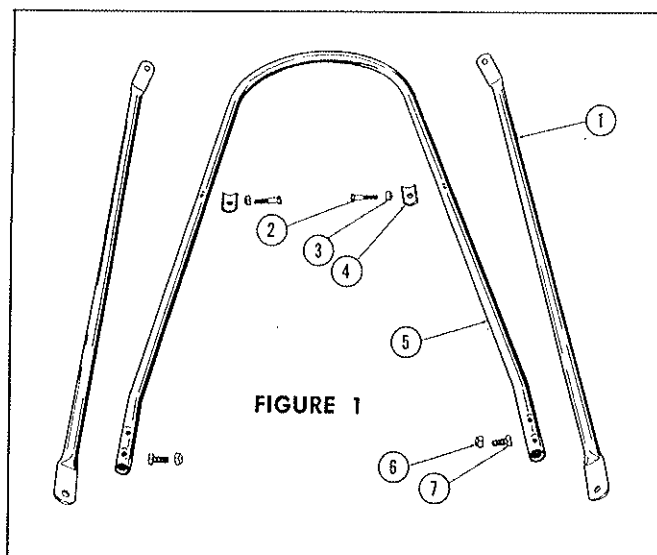

FIGURE 2

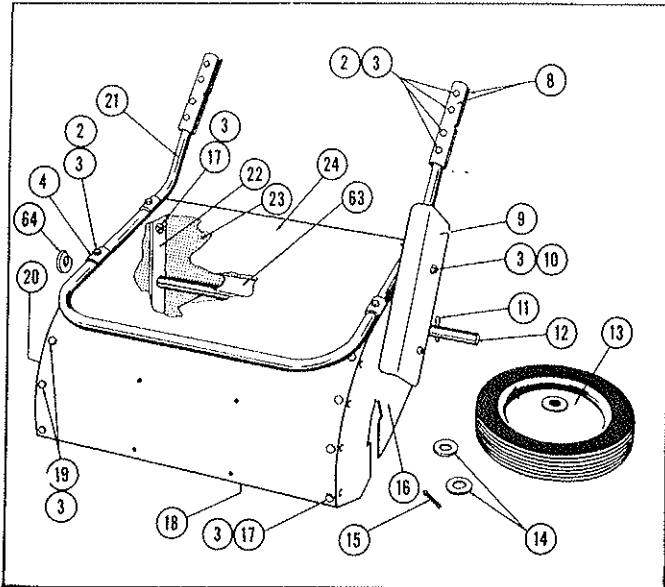

FIGURE 3

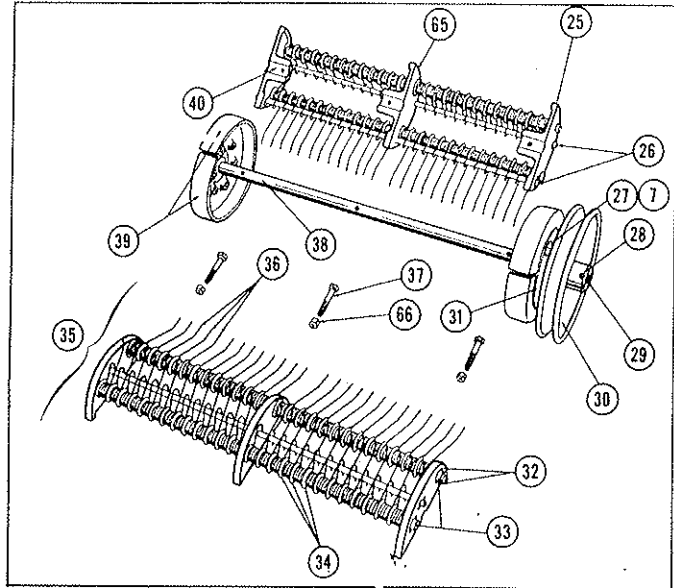

FIGURE 4

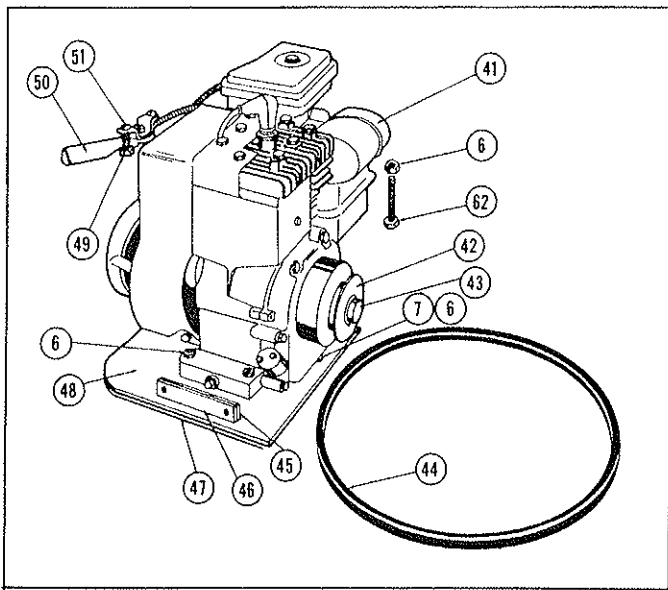

FIGURE 5

