

Instruction Sheet

Kit Number: 78807400 & 78807500

OPERATOR-CONTROLLED DISCHARGE BAFFLE KIT



WARNING: FAILURE TO FOLLOW INSTRUCTIONS could result in personal injury and/or damage to unit.
Read, understand, and follow all safety practices in Operator's Manual before beginning.

Package Contents

Check the contents of your kit for the parts listed below. Also see figure 1 on page 2.

Item	Description	Qty	AriensCo P/N
1	Chute Mount Bracket (78807400)	1	04808753
	Chute Mount Bracket (78807500)	1	04809353
2	Discharge Chute Pin	1	03830600
3	5/16"-18 x 1 1/2" Round Head Square Neck Bolt	2	06200233
4	5/16"-18" Top Locking Flange Nut	2	06500904
5	Chute Control Plate	1	04809953
6	Block-off Baffle Plate (78807400)	1	04824953
	Block-off Baffle Plate (78807500)	1	04809453
7	Spacer	3	04811651
8	3/8"-16 x 1 1/2" Round Head Square Neck Bolt	6	06200328
9	3/8"-16" Top Locking Flange Nut	12	06500822
10	3/8" x 3/4" x 1/16" Flat Nylon Washer	4	06433600
11	OCDC Baffle Lift Cam Bracket	1	04822851
12	Baffle Slide Pin	2	04261400
13	3/8"-16 x 1" Hex Bolt	2	05901711
14	9/16" x 1 3/8 x 7/64" Flat Steel Washer	1	06401012
15	5/16"-18 x 3/4" Hex Washer Head Tapping Screw	2	07400127
16	Rubber Chute (78807400)	1	03820200
	Rubber Chute (78807500)	1	03827200
17	Chute Support Bracket (78807400)	1	04808951
	Chute Support Bracket (78807500)	1	03784251
18	3/8"-16 x 1" Round Head Square Neck Bolt	2	06200235

Item	Description	Qty	AriensCo P/N
19	1/2"-13 x 1 1/4" Round Head Square Neck Bolt	1	06200325
20	1/2"-13 Top Locking Flange Nut	1	06500907
21	3/8"-16 Nylon Locking Flange Nut	1	06500726
22	3/8" x 5/8" x 15/64" Sleeve Bushing	2	05508900
23	3/8"-16 x 1 1/4" Hex Bolt	1	05901724
24	Push / Pull Control Cable * Includes T-handle, T-handle Mounting Screw and Clevis loose in package	1	06900709
25	Cable Bracket	1	09189551
26	13/32" x 13/16" x 1/16" Flat Steel Washer	3	06401013
27	J-Clamp (44", 48" & 52" Decks)	1	06916000
28	Cushioned Steel Clamp	1	06917900
29	5/16" -18 x 2 1/4" Hex Bolt (48", 52" & 60" Decks)	1	05901806
30	Mounting Bracket	1	05142953
31	4" Cowl Strip	2	00918200
32	Upper Mounting Bracket	1	05145253
33	3/8"-16 x 3/4" Hex Bolt	2	05901702
34	5/16"-18 x 1" Round Head Short Square Neck Bolt	2	06200237
35	3/8"-16 Locking Center Flange Nut	2	06500901
36	3/8"-16 x 2 1/4" Hex Bolt	1	05901640
37	5/16"-18 Locking Center Flange Nut	3*	06500840
38	25/64" x 7/8" x 1/16" Flat Steel Washer	1*	06436800
39	5/16"-18 x 1 1/2" Round Head Square Neck Bolt	2*	06200233
* Items 38 and 39 and one additional Item 37 are only required if light kit 78807300 is also installed. See Figure 19.			

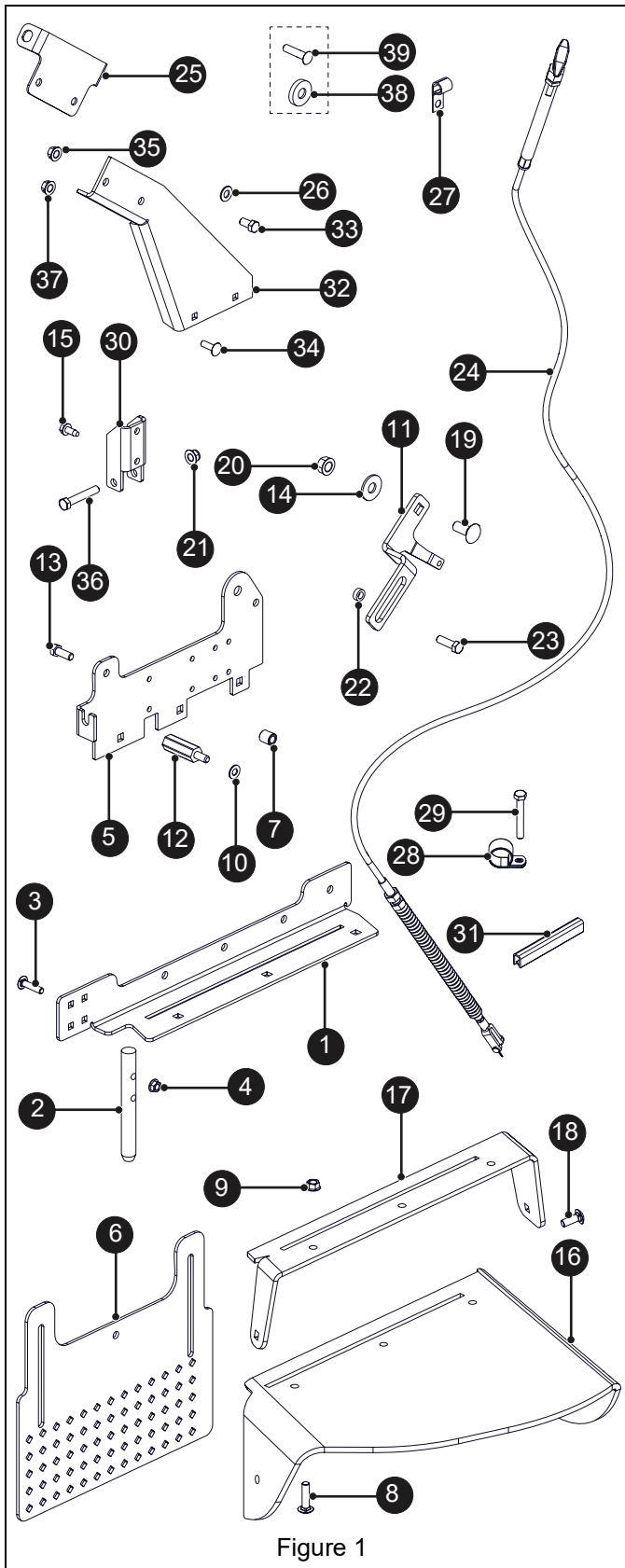

Figure 1

REMOVAL

IMPORTANT: All references to the left, right, front or rear are given from the perspective of the operator in the operator's position, facing the direction of forward travel.

1. Stop engine, remove key and engage parking brake. Wait for moving parts to stop and for hot parts to cool.
2. Remove the 3/8" x 2 1/4" hex bolt and nut retaining the discharge chute and remove the discharge chute. Retain all parts and reinstall for operation without discharge baffle.

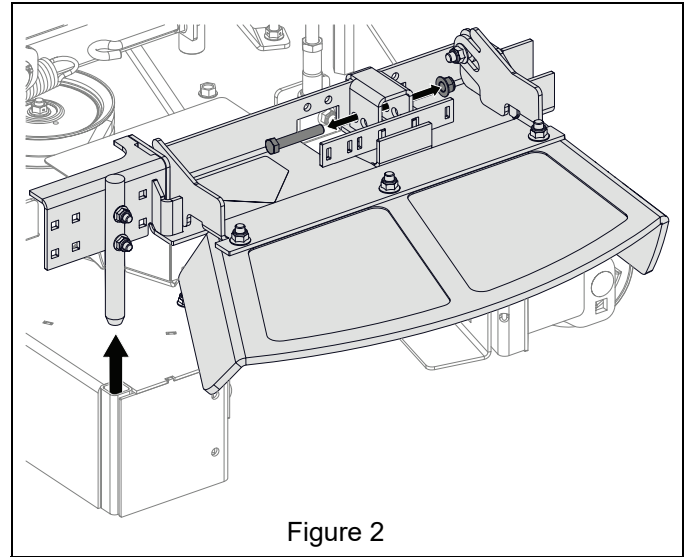
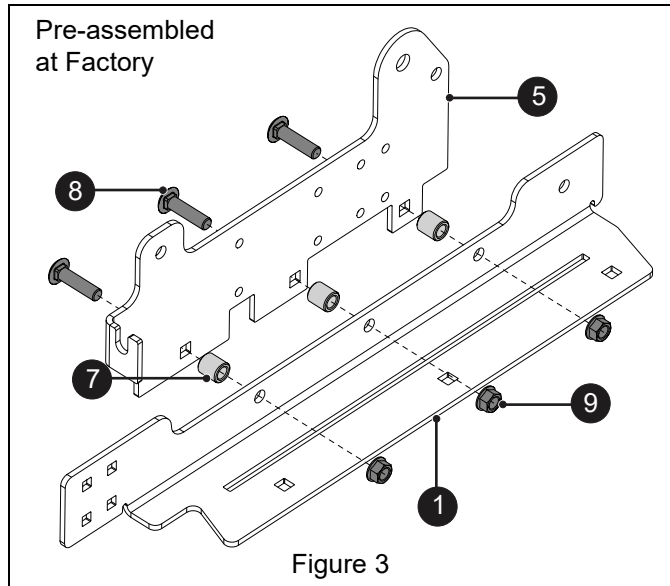

Figure 2

INSTALLATION

NOTICE: For installation convenience some of the components below have been pre-assembled at the factory. Assembly steps are included should repair be necessary.

1. Attach chute control plate (item 5) and three spacers (item 7) to chute mount bracket (item 1) using three 3/8" x 1 1/2" round head square neck bolts (item 8) and three 3/8" top locking flange nuts (item 9). See Figure 3.



See Figure 4.

2. Attach rubber chute (item 16) and chute support bracket (item 17) to bracket assembly using three 3/8" x 1 1/2" round head square neck bolts (item 8) and three 3/8" top locking flange nuts (item 9). Install bolts with heads inside of chute.
3. Secure front and back of rubber chute to support bracket with two 3/8" x 1" round head square neck bolts (item 18) and two 3/8" top locking flange nuts (item 9). Install bolts with heads outside of chute.

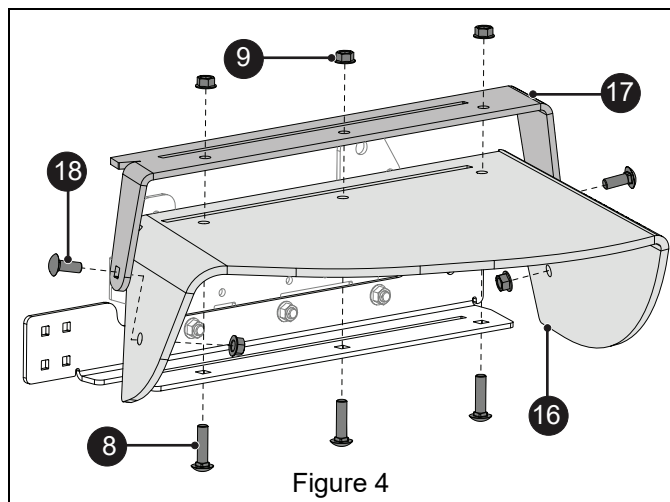

See Figure 5.

4. Insert block-off baffle plate (item 6) into slot in chute support bracket.
5. Install two 3/8" flat nylon washers (item 10) on two baffle slide pins (item 12) and position pins between block-off baffle plate and chute control plate. Secure with two 3/8" x 1" hex bolts (item 13).
6. Position baffle plate on pins. Secure plate to pins using two 3/8" flat nylon washers (item 10) and two 3/8" locking flange nuts (item 9). DO NOT fully tighten flange nuts. Ensure that baffle plate slides up and down freely.

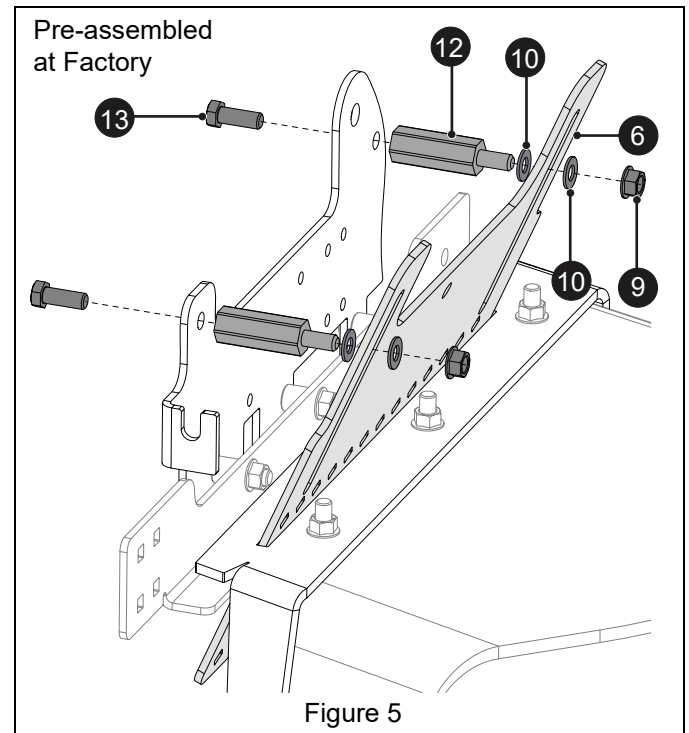

See Figure 6.

7. Position one 1 3/8" flat steel washer (item 14) and cam bracket (item 11) between block-off baffle plate and chute control plate and retain with one 1/2" x 1 1/2" round head square neck bolt (item 19) and one 1/2" top locking flange nut (item 20). Tighten hardware enough to secure without restricting cam bracket rotation.
8. Install two sleeve bushings (item 22) in slot in cam bracket and retain with one 13/16" flat steel washer (item 26), one 3/8" x 1 1/4" hex bolt (item 23) and one 3/8" locking flange nut (item 9).

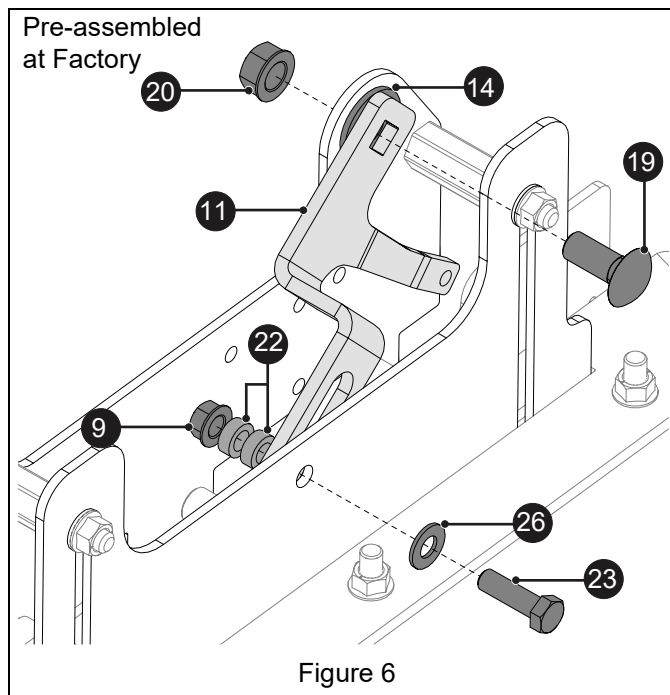

Figure 6

9. Position mounting bracket (item 30) on back of chute control assembly and retain with two hex washer head tapping screws (item 15). The mounting location varies depending on deck size. See Figure 7 for correct mounting location.

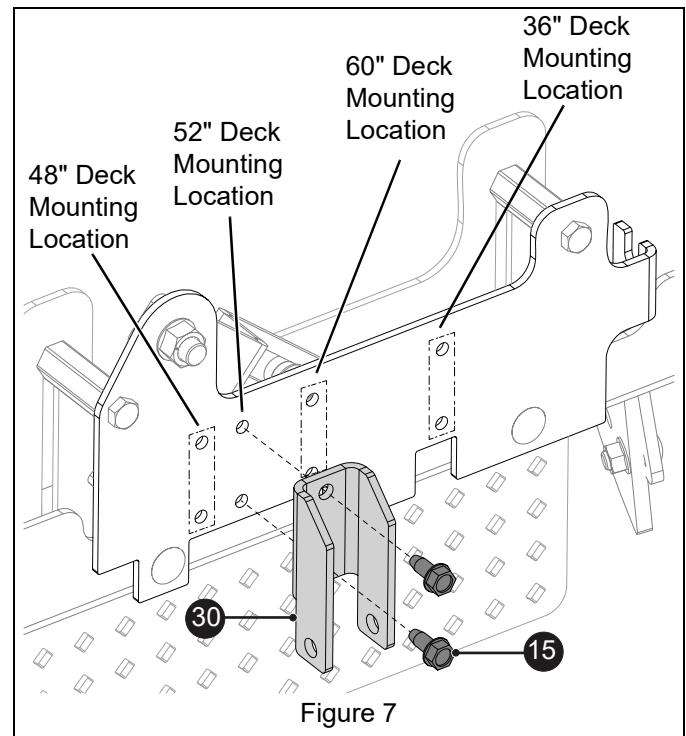

Figure 7

10. Position discharge chute pin (item 2) on front of chute control assembly and retain with two 5/16" x 1 1/2" round head square neck bolts (item 3) and two 5/16" top locking flange nuts (item 4). The mounting location varies depending on deck size. See Figure 8 for correct mounting location.

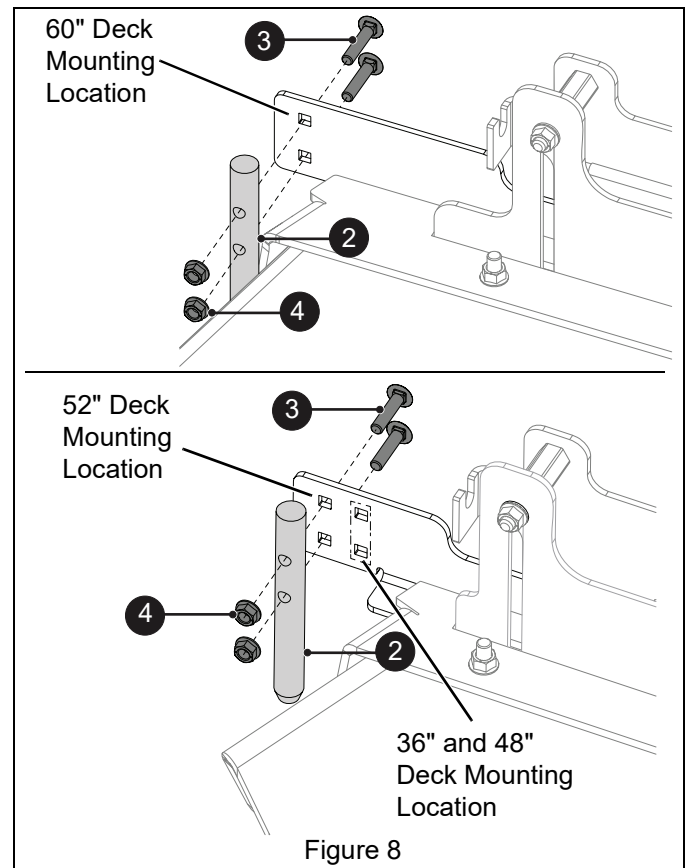
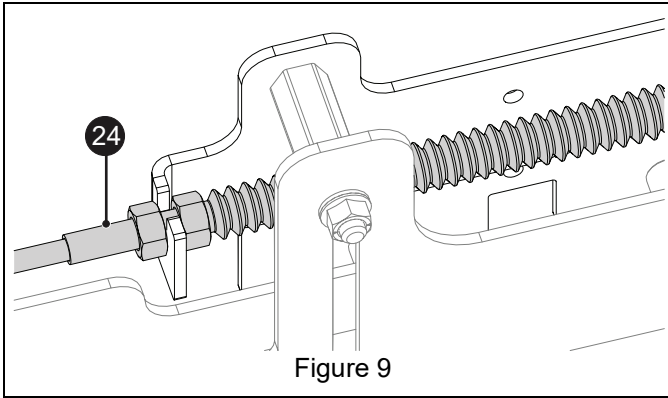
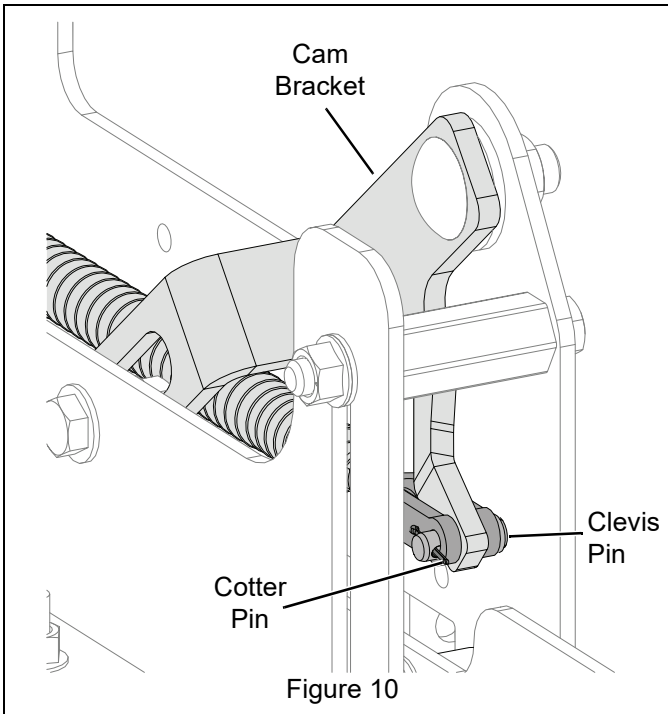

Figure 8

11. Position cable (item 24) in chute control plate slot.
12. Tighten jam nuts against chute control plate slot.
13. Position cable boot over cable threads so threads are covered. See Figure 9.



14. Remove cotter pin from clevis pin and remove clevis pin from cable end. Retain parts.
15. Secure cable end to cam bracket with clevis pin and cotter pin. Bend cotter pin ends. See Figure 10.



16. Install discharge baffle assembly onto deck. See Figure 11.

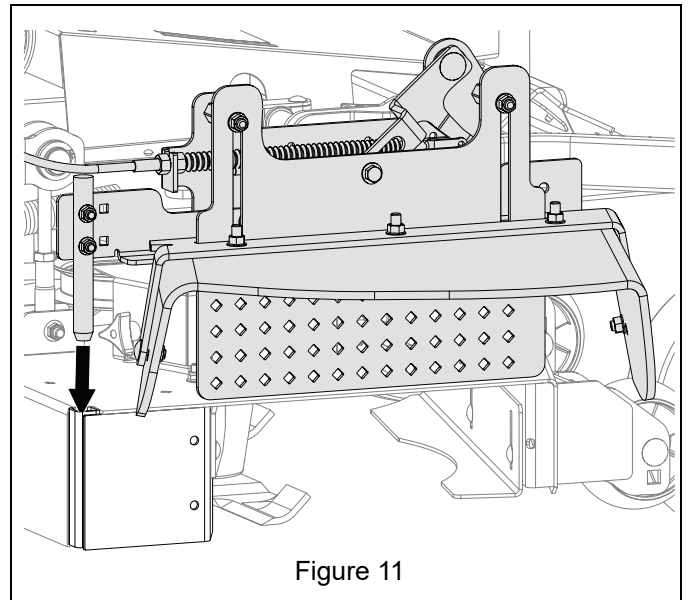

17. Secure discharge baffle assembly to deck with one 3/8" x 2 1/4" hex bolt (item 36) and one 3/8" nylon locking flange nut (item 21). See Figure 12.

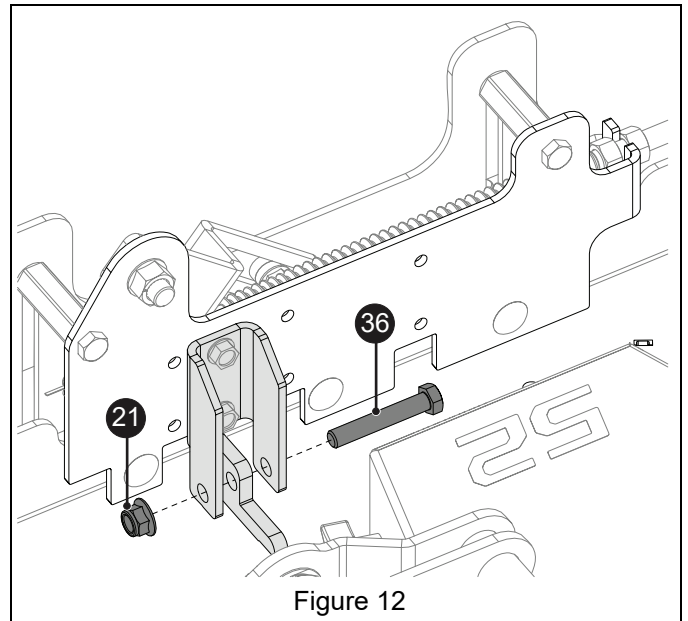

18. Remove and retain five 1/4" x 1/2" tapping screws retaining right side cover and remove cover. See Figure 13.

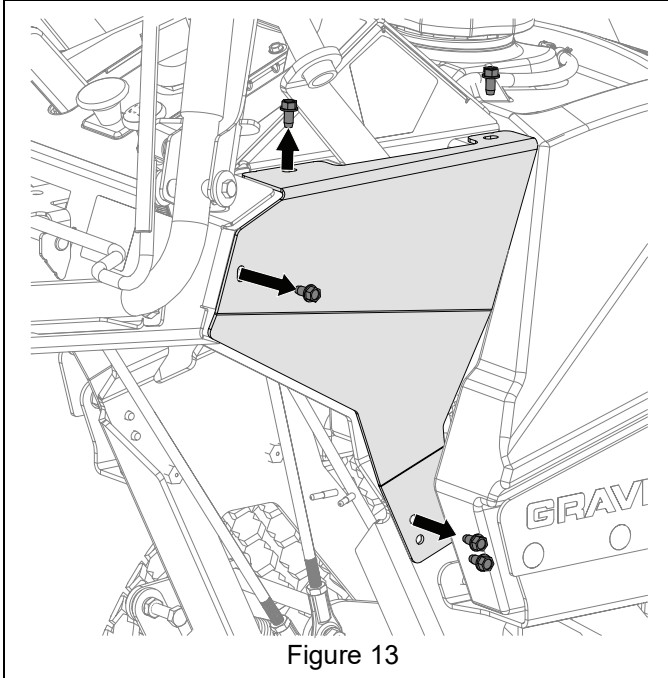

19. Remove and retain five 1/4" x 1/2" tapping screws retaining left side cover and remove cover. See Figure 14.

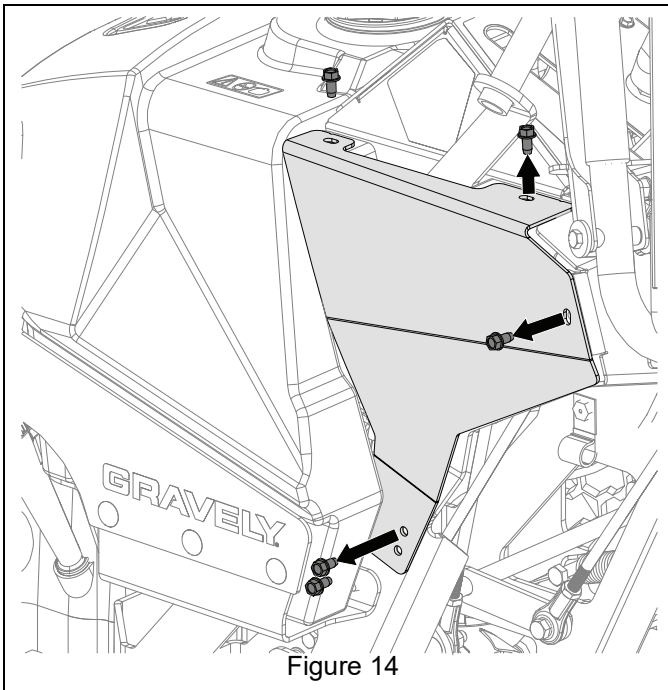

20. Remove and retain three 5/16" x 3/4" hex bolts and flat washers and one 5/16" x 1" hex bolt and flat washer securing left and right side of fuel tank. See Figure 15.

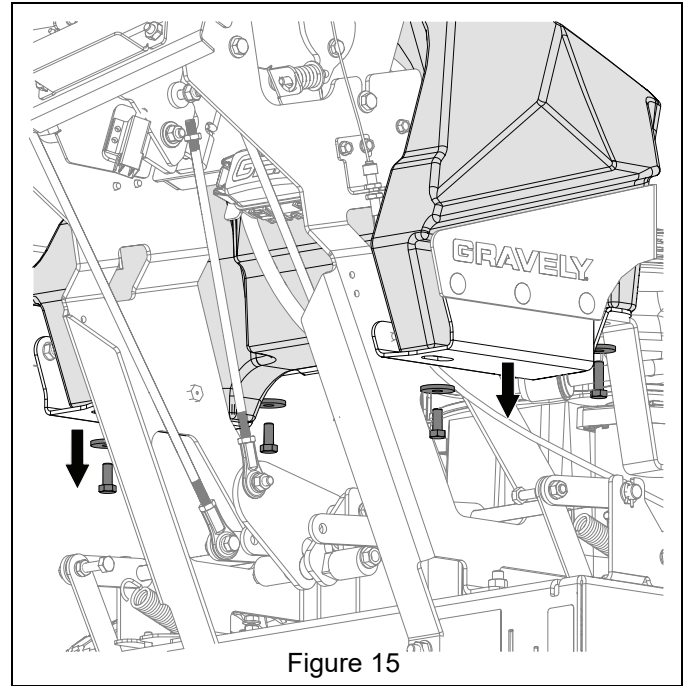

21. Disconnect fuel hoses at tank inlet and rollover valve. See Figure 16.

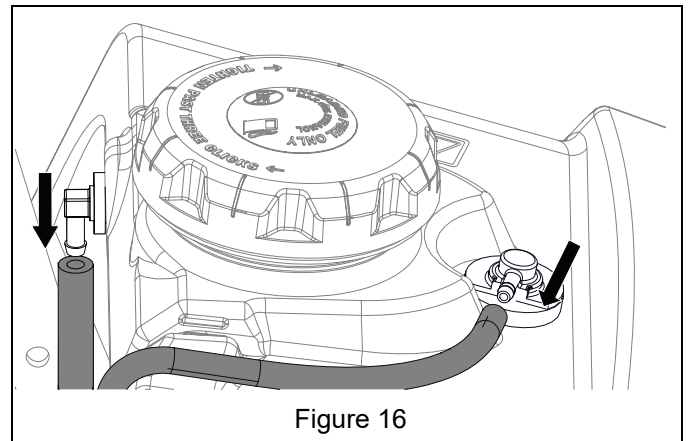

22. Remove and discard rear and center 5/16" x 3/4" round head square neck bolts and locking nuts retaining right-side fuel tank bracket. Lift, but DO NOT remove the fuel tank to gain access to the lock nuts. See Figure 17.

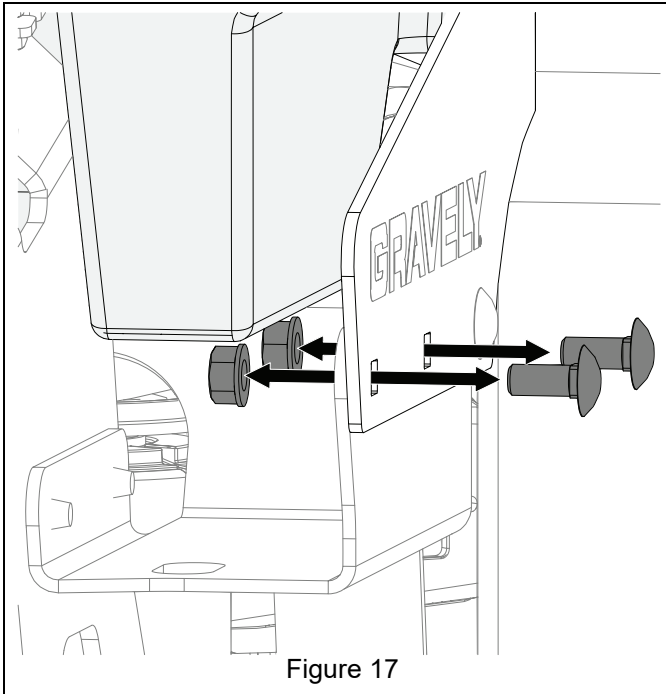

Figure 17

23. Mount upper mounting bracket (item 32) to fuel tank bracket using two 5/16" x 1" round head square neck bolts (item 34) and two locking center flange nuts (item 37). See Figure 18.

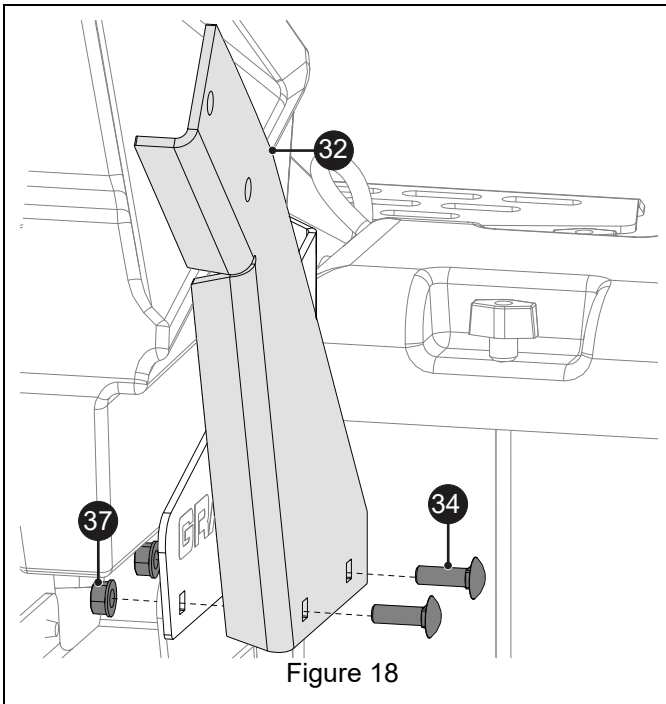

Figure 18

IMPORTANT: For installation with light kit 78807300 the upper bracket (item 32) must be installed behind the light bracket. Remove the right light bracket hardware and install flat washer (item 39). Retain washer, light bracket and upper bracket with one 5/16" x 1" round head square neck bolt, (item 34) two 5/16" x 1 1/2" bolts (item 39) and three locking center flange nuts (item 37). See Figure 19.

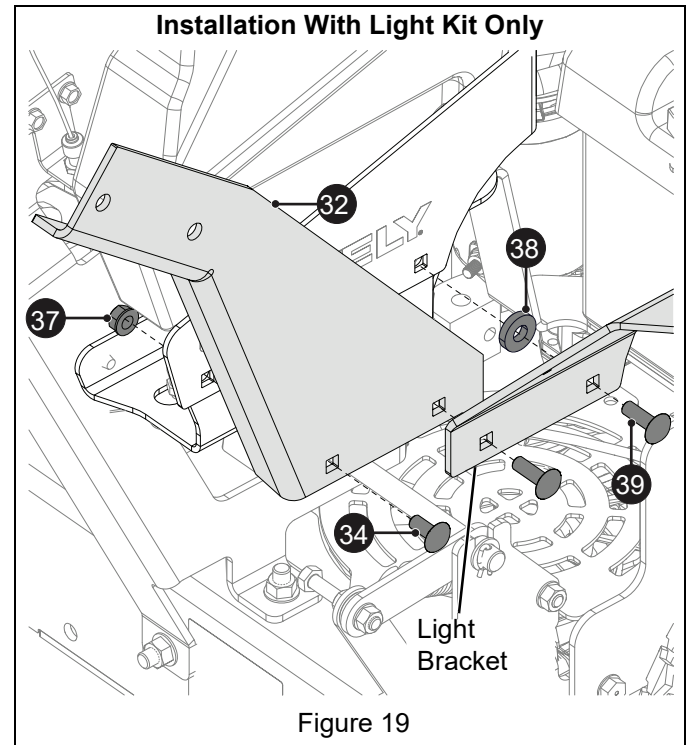

Figure 19

24. Reposition fuel tank.
 25. Reconnect fuel hoses.
 26. Reinstall hardware removed in step 20. Install three 5/16" x 3/4" hex bolts and flat washers in left side and right rear and one 5/16" x 1" hex bolt and flat washer in right front side. Torque bolts to 6.2 – 6.8 N•m (55 – 60 lb-in).

27. Reinstall left and right side covers and retain with ten tapping screws. See Figure 20.

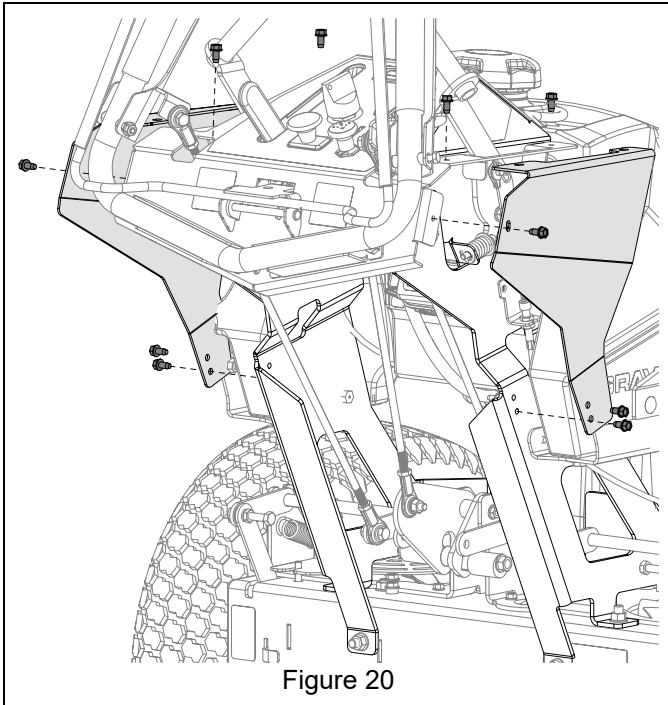

Figure 20

28. Mount the cable bracket (item 25) to the upper bracket with two 3/8" x 3/4" hex bolts (item 33), two flat steel washers (item 26) and two 3/8" locking center flange nuts (item 35). Ensure that tab hole with flat edges faces up. See Figure 21.

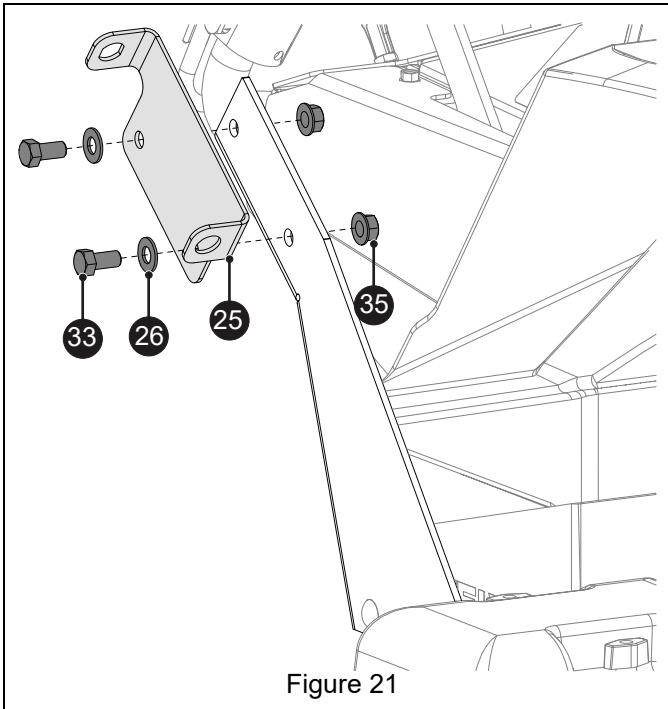

Figure 21

29. Remove T-handle, upper nut, lock washer and jam nut from cable (item 24). Route cable through lower tab of cable bracket and reinstall jamb nut and lock washer. Route cable through upper tab of cable bracket and reinstall upper nut. Tighten jam nut against bracket and reinstall T-handle. See Figure 22.

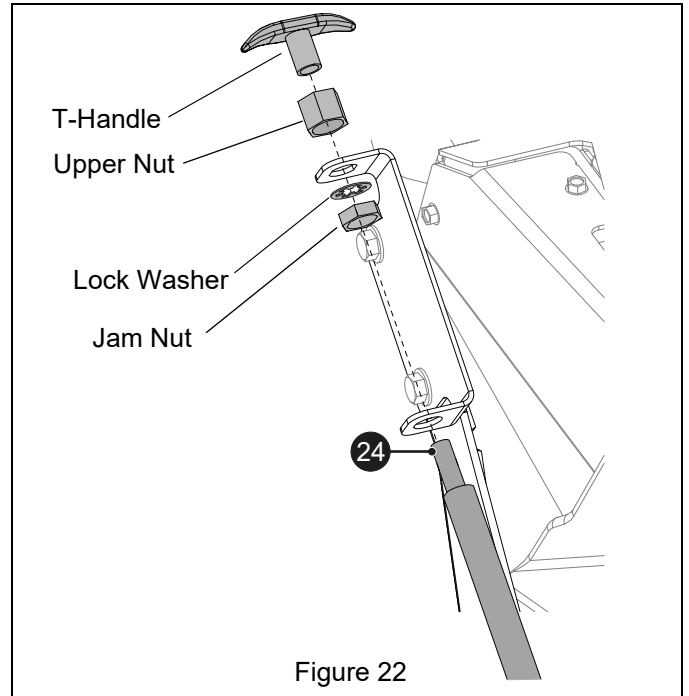
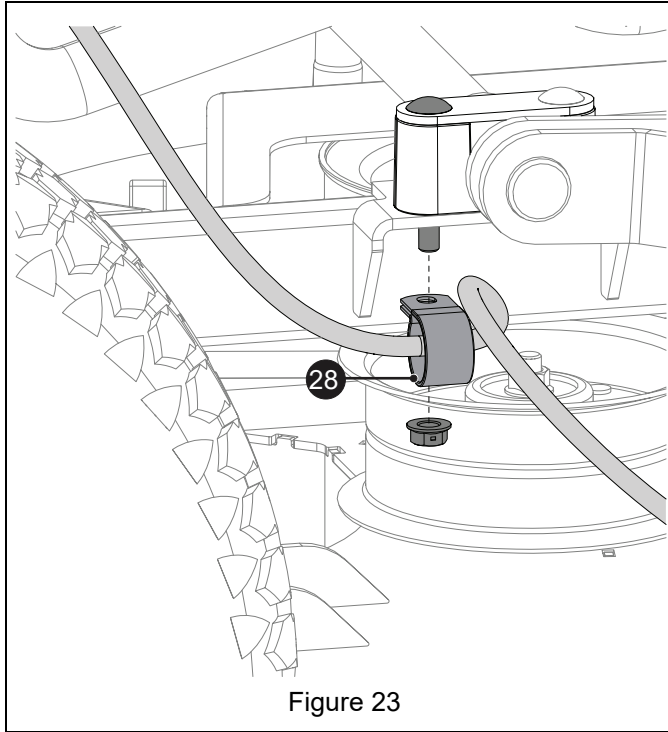

Figure 22

RETAIN CABLE

36" Decks

1. Remove and retain the right rear 5/16" locking nut from the round head square neck bolt retaining the bearing support plate.
2. Position cushioned steel clamp (item 28) facing downward onto cable.
3. Install clamp on bearing support bolt and retain with nut just removed. See Figure 23.



4. Remove and retain 1/4" x 3/4" round head square neck bolt and locking nut from front hydraulic expansion tank mount.

5. Install J-clamp (item 27) onto cable and attach J-clamp to backside of expansion tank bracket. Retain clamp with round head square neck bolt and locking nut just removed. See Figure 24.

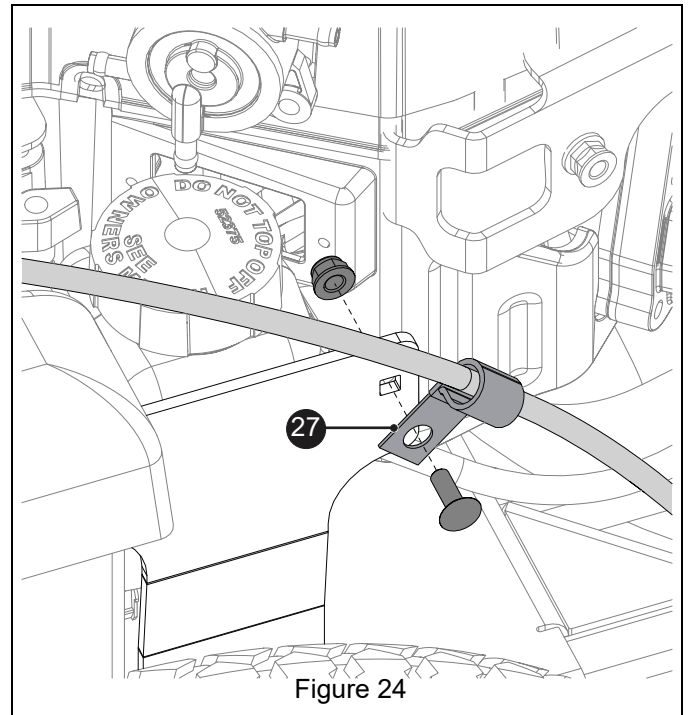

6. Unlock cable and extend and retract cable to ensure block-off baffle plate lifts and lowers.

48" & 52" Decks

1. Remove the right front 5/16" x 2 1/4" round head square neck bolt and locking nut retaining the bearing support plate. Retain lock nut; dispose of bolt. See Figure 25.

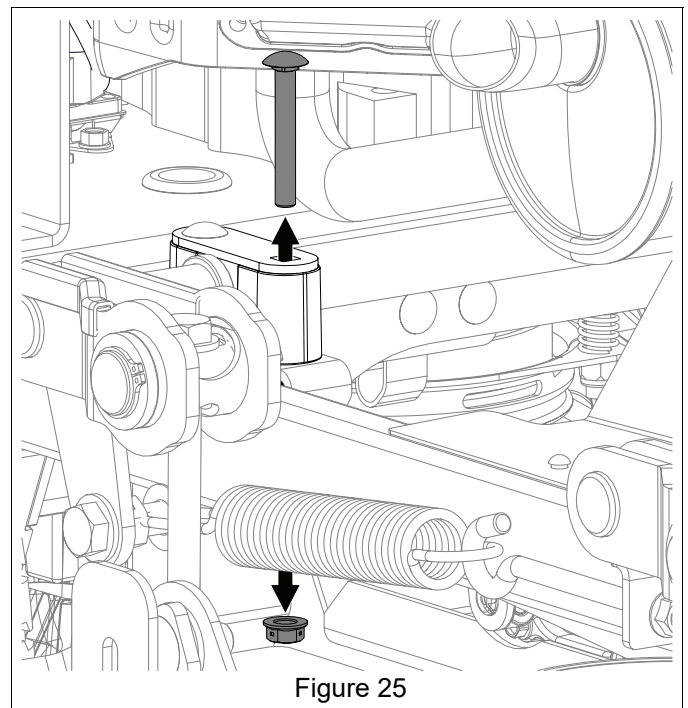

2. Install cushioned steel clamp (item 28) onto cable facing upward.
3. Install clamp on bearing support and secure with one 5/16" x 2 1/4" hex bolt (item 29) and nut just removed. See Figure 26.

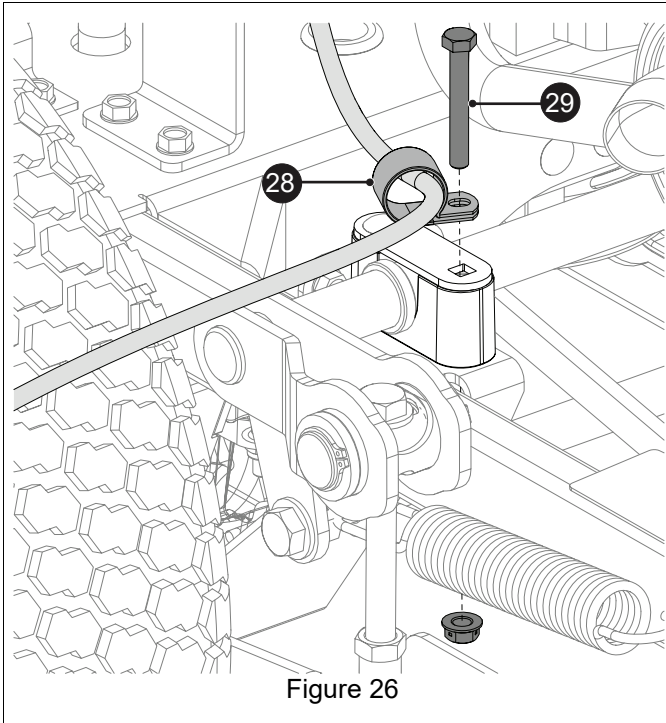

4. Install two 4" cowl strips (item 31) on the top edges of the deck-lift weldment. Ensure that strips are fully engaged. See Figure 27.

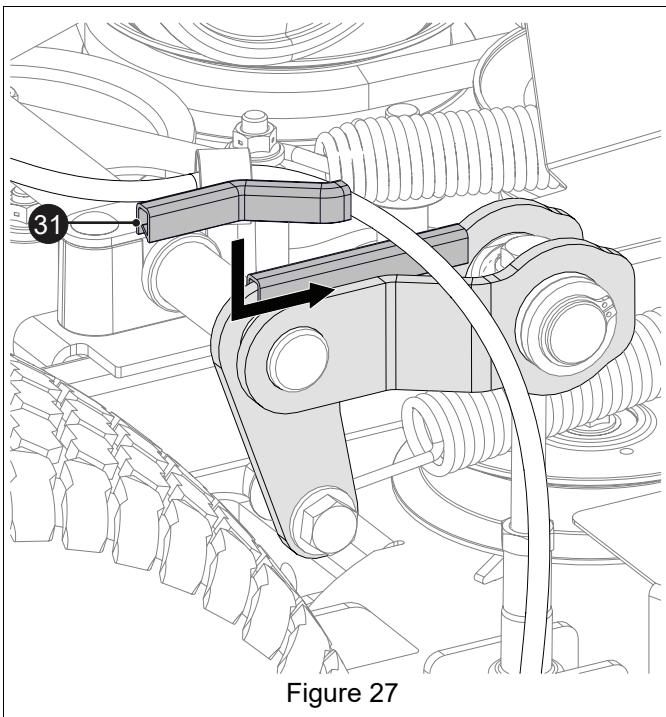

See Figure 28.

5. Remove and retain 1/4" x 3/4" round head square neck bolt and locking nut from front hydraulic expansion tank mount.
6. Install J-clamp (item 27) onto cable facing outward and attach J-clamp to backside of expansion tank bracket. Retain clamp with round head square neck bolt and locking nut removed in step .

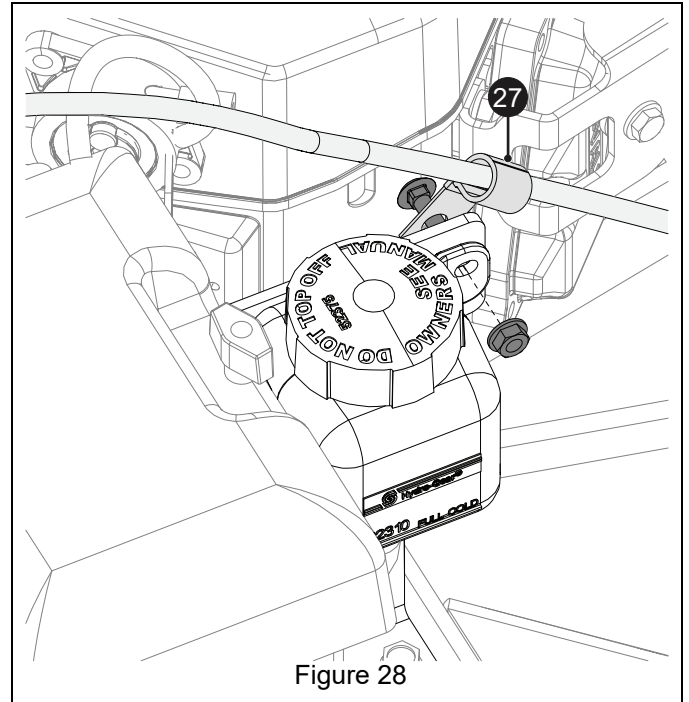

7. Unlock cable and extend and retract cable to ensure block-off baffle plate lifts and lowers.

60" Decks

1. Remove the right rear 5/16" x 2 1/4" round head square neck bolt and locking nut retaining the bearing support plate. Retain lock nut; dispose of bolt. See Figure 29.

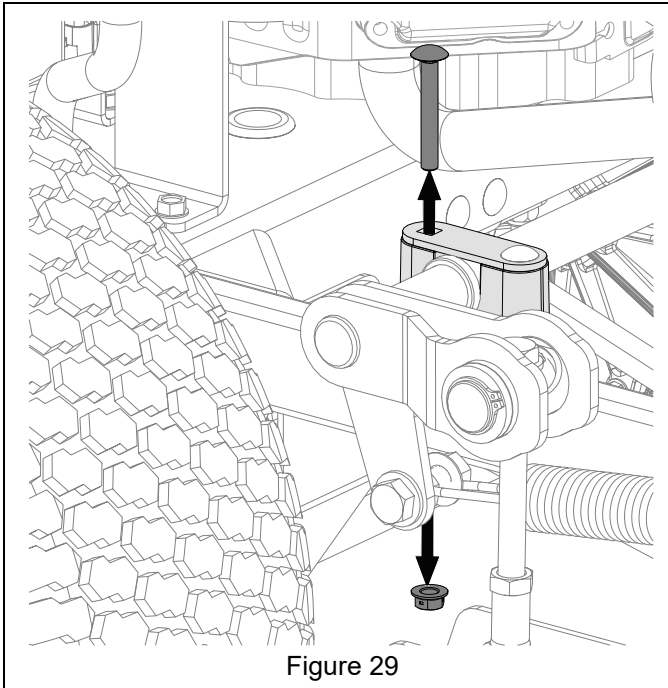

2. Install cushioned steel clamp (item 28) onto cable facing upward.
3. Install clamp on bearing support and secure with one 5/16" x 2 1/4" hex bolt (item 29) and nut just removed. See Figure 30.

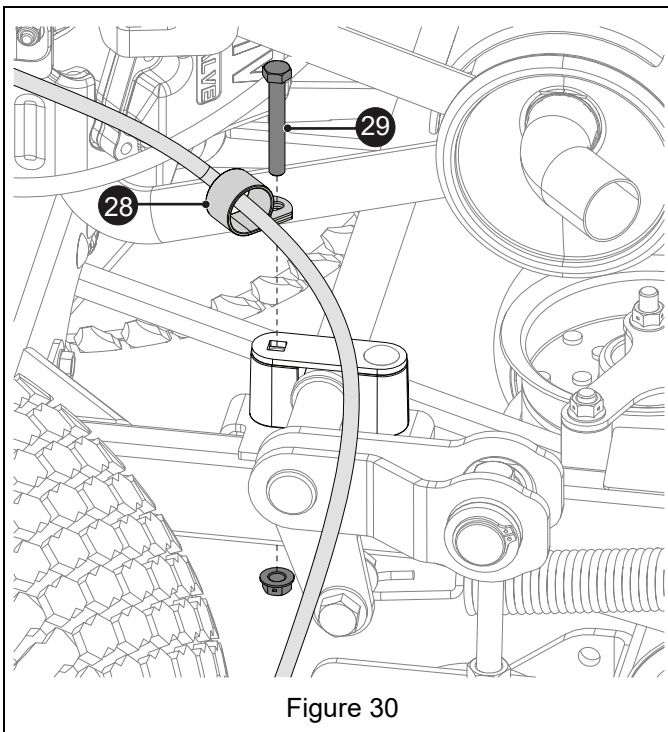

4. Unlock cable and extend and retract cable to ensure block-off baffle plate lifts and lowers.

OPERATION

1. Unlock T-handle by rotating to center of clockwise or counterclockwise range of travel. Baffle plate will drop freely to lowest position.

NOTICE: Cable may remain unlocked when baffle plate is in lowest position.

2. Pull T-handle out to raise baffle plate.
3. Turn T-handle fully clockwise or counterclockwise to lock baffle plate position.

IMPORTANT: DO NOT pull T-handle when cable is locked or cable damage will result.

NOTICE: Baffle is designed for temporary discharge control. It is not a mulching attachment.