

Instruction Sheet

Kit Number: 79404500

OPERATOR-CONTROLLED DISCHARGE BAFFLE (OCDB) KIT



WARNING: FAILURE TO FOLLOW INSTRUCTIONS could result in personal injury and/or damage to unit.

Read, understand, and follow all safety practices in Operator's Manual before beginning.

Package Contents

Check the contents of your kit for the parts listed below
Also see Figure 1.

Item	Description	Qty	Ariens P/N
1	Discharge Chute Assembly (Pre-Assembled)	1	N/A
2	Formed Rubber Discharge Chute	1	04880900
3	Discharge Chute Clamp Plate	1	04976151
4	3/8"-16 x 1" Round Head Square Neck Bolt	4	06200235
5	3/8"-16 Nylon Locking Center Flange Nut	4	06500901
6	11/16" x 7/8" x 9/16" Panel Snap Bushing	1	07500126
7	Wire Handle With Soft Grip (Pre-Assembled)	1	N/A
8	5/16" Right-Hand Thread Rod End	1	03787100
9	5/16"-24 Jam Nut	3	06500923
10	5/16"-18 x 1" Hex Bolt	1	05901701
11	5/16"-18 Center Locking Flange Nut		06500840
	• Pro-Stance Models	3	
	• Z-Stance Models	1	
12	Safety Decal	1	02988100
13	1/2"-13 x 6 1/2" Hex Bolt	1	05901907
14	1/2" x 1 7/16" Flat Steel Washer	1	06401022
15	1/2"-13 Center Locking Flange Nut	1	06500902
16	Coupler Nut	1	06501003
17	Handle Extension	1	05181200
18	Hole Template	1	09669051

Item	Description	Qty	Ariens P/N
Pro-Stance Models Only			
19	Mounting Bracket	1	05284753
20	5/16"-18 x 1" Round Head Square Neck Bolt	2	06200237
21	1/4"-20 x 1/2" Hex Bolt (48" Model Only)	1	05901705
22	Belt Cover (48" Model Only)	1	N/A
Z-Stance Models Only			
23	Mounting Bracket	1	09667753
24	3/8"-16 x 4" Round Head Square Neck Bolt	2	06200239

NOTICE: See *Parts List* on page 8 for a full list of parts.

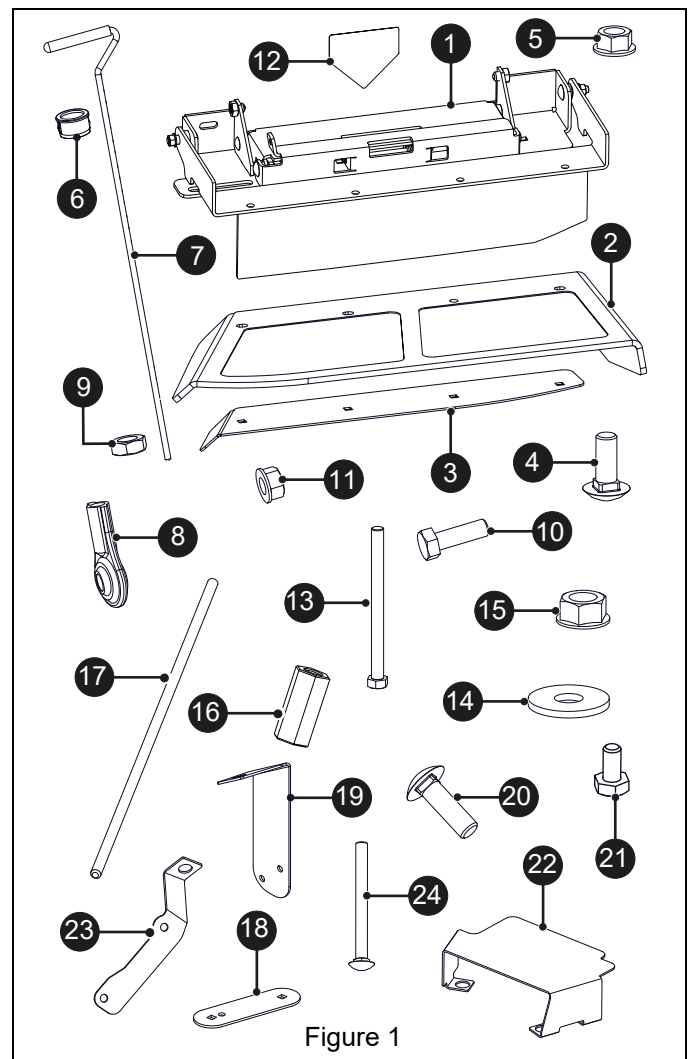

REMOVAL

1. Park unit on a flat, level surface and engage parking brake.
2. Stop engine, remove key and wait for all moving parts to stop and for hot parts to cool.
3. Remove two 3/8" x 1" round head square neck bolts and two 3/8" center locking flange nuts securing discharge chute assembly and remove chute assembly. Retain hardware for reinstallation and discharge chute for use without OCDB kit. See Figure 2.

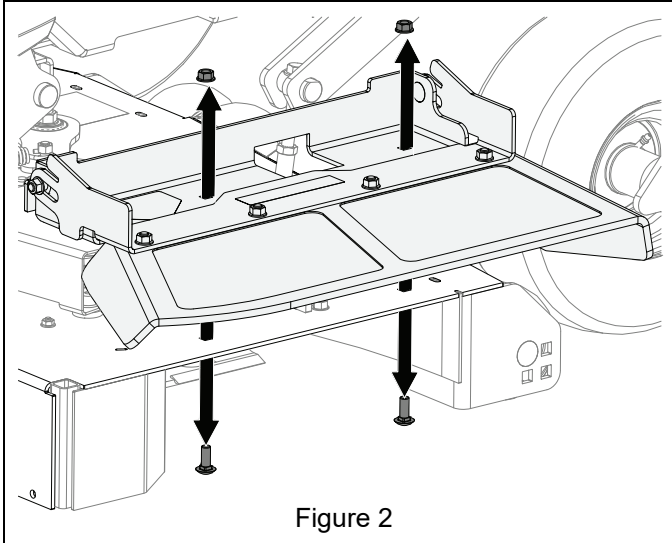

4. *Pro-Stance Models Only:* Remove two 5/16" x 3/4" round head square neck bolts and two center lock flange nuts securing muffler bracket to support bracket. Retain nuts and bolts for use without OCDB kit. See Figure 3.

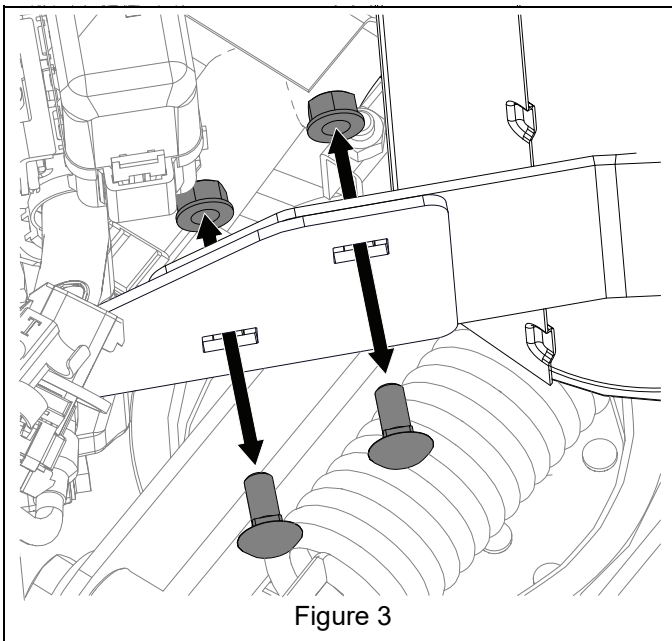

5. *Z-Stance Models Only:* Remove two 3/8" x 3 1/2" round head square neck bolts and two 3/8" center locking flange nuts securing lanyard and spacers to height-of-cut bracket. Retain lanyard, spacers, and nuts for reinstallation and bolts for operation without OCDB kit. See Figure 4.

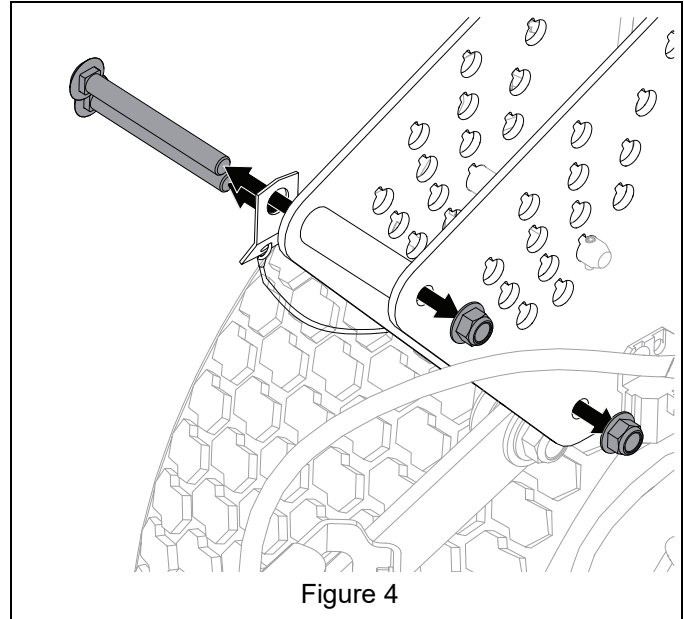

INSTALLATION

IMPORTANT: 48" Models Only: Installing the belt cover requires drilling the deck. See *Install Belt Cover* on page 5 prior to performing installation procedures below.

1. Position rubber discharge chute (item 2) and chute clamp plate (item 3) on the discharge chute (item 1) mounting bracket and retain using four 3/8" x 1" round head square neck bolts (item 4) and four 3/8" nylon locking center flange nuts (item 5). Bolts install from bottom up. See Figure 5.

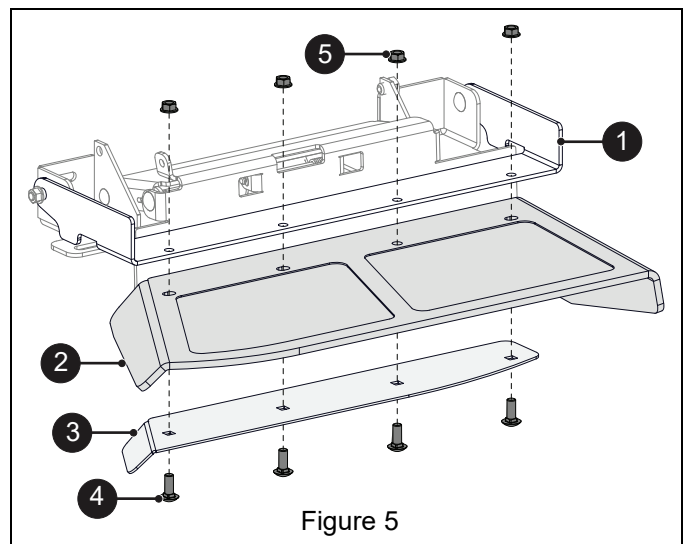

2. Position discharge chute assembly on deck and retain with hardware removed in Figure 2. Secure discharge chute with one 1/2" x 6 1/2" hex bolt (item 13), one 1/2" x 1 7/16" flat steel washer (item 14) and one 1/2" center locking flange nut (item 15). See Figure 6.

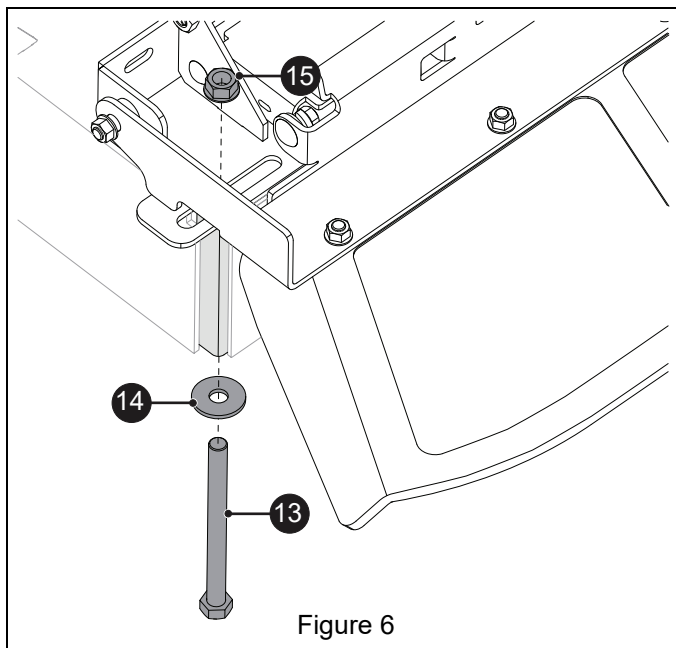

3. Position rod end (item 8) on hinge plate and retain with one 5/16" x 1" hex bolt (item 10) and one 5/16" center-locking flange nut (item 11). See Figure 7.

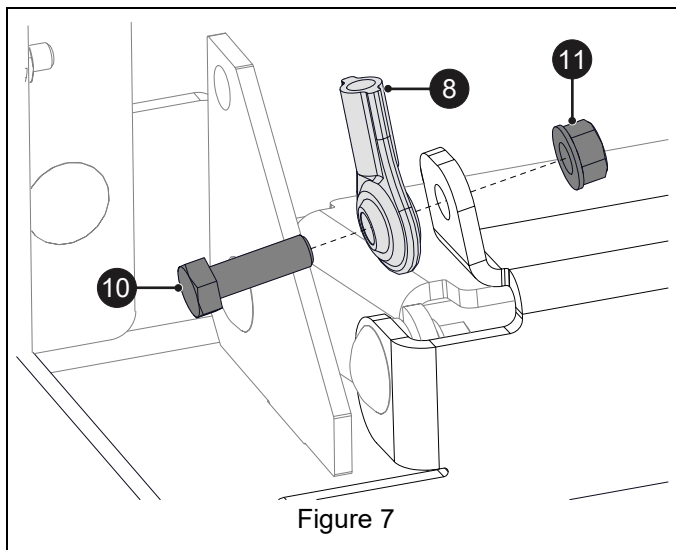

4. Install mounting bracket:

- *Pro-Stance Models (See Figure 8):* Position mounting bracket (item 19) on muffler bracket and secure with two 5/16" x 1" round head square neck bolts (item 20) and two 5/16" center locking flange nuts (item 11).
- *Z-Stance Models (See Figure 9):* Position mounting bracket (item 23) on height-of-cut bracket and secure with two 3/8" x 4" round head square neck bolts (item 24) and parts retained for reinstallation in Figure 4.

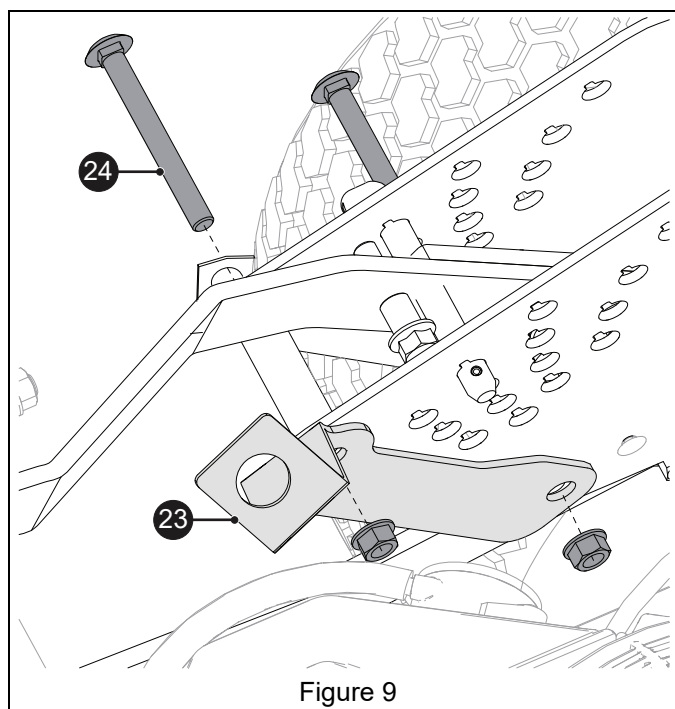
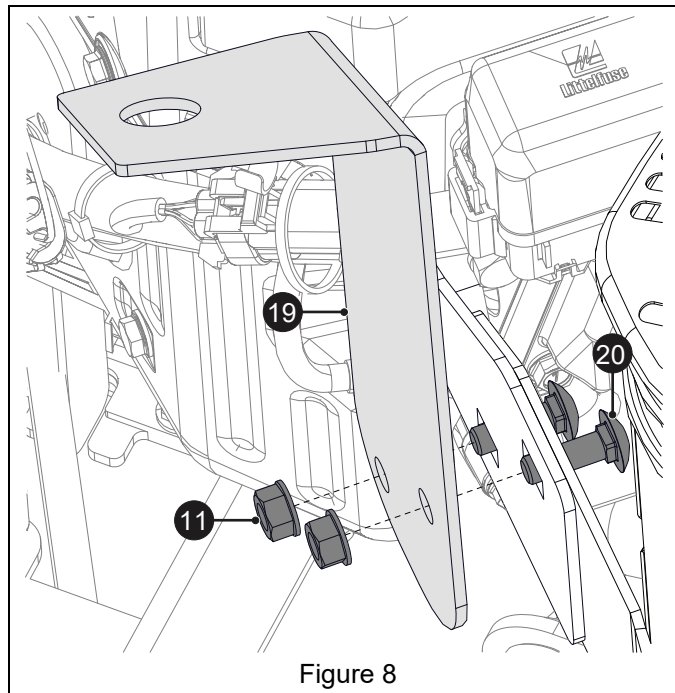

5. Install one bushing (item 6) into mounting bracket.
See Figure 10.

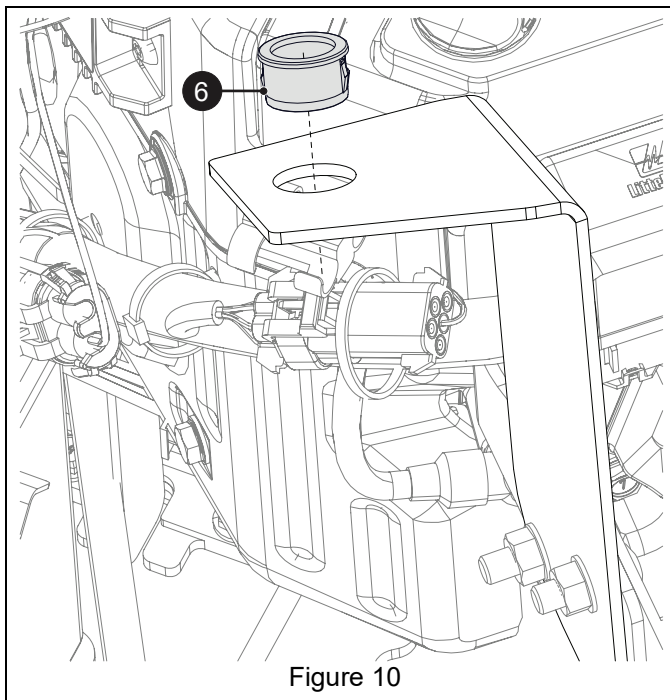

6. Insert handle assembly (item 7) through bracket and bushing. See Figure 11.

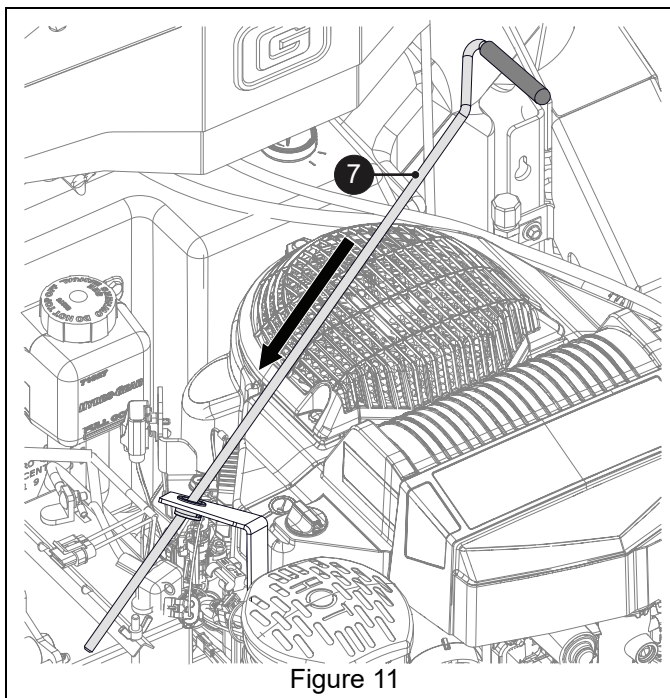

See Figure 12.

7. Install one jam nut (item 9) onto handle assembly threads.
8. Install second jam nut (item 9) onto the handle extension (item 17) threads.
9. Thread each rod halfway into the 5/16" coupling nut (item 9). Tighten jam nuts against coupling nut.

IMPORTANT: Ensure that there are sufficient threads in coupling nut.

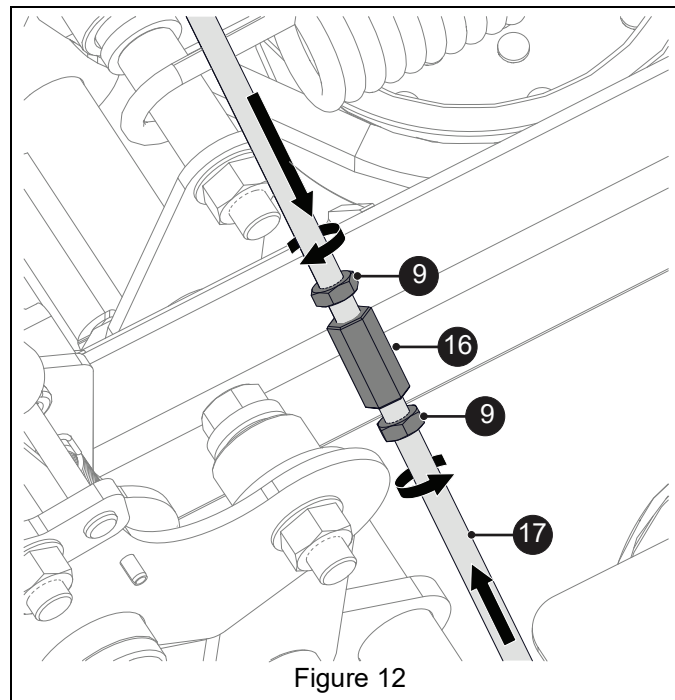

10. Turn jam nut (item 9) up handle threads and turn handle assembly clockwise into ball joint. See Figure 13.

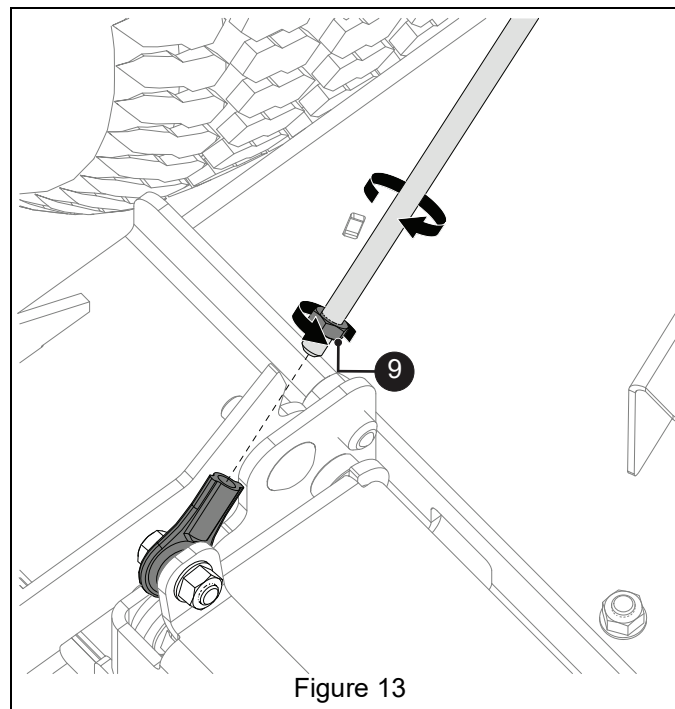

11. Stand on unit and rotate handle to preferred position.
See Figure 14.

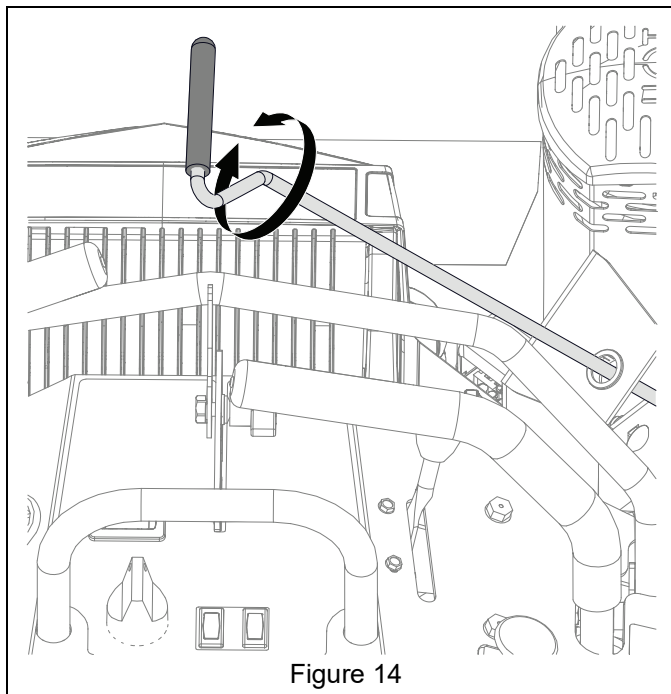

Figure 14

12. Locate an area on the deck surface with sufficient space to fit the safety decal (item 12).

NOTICE: Decal mounting location will vary with deck size. Choose a location that is clearly visible to the operator and bystanders.

13. Thoroughly clean deck surface and install safety decal on deck. See Figure 15.

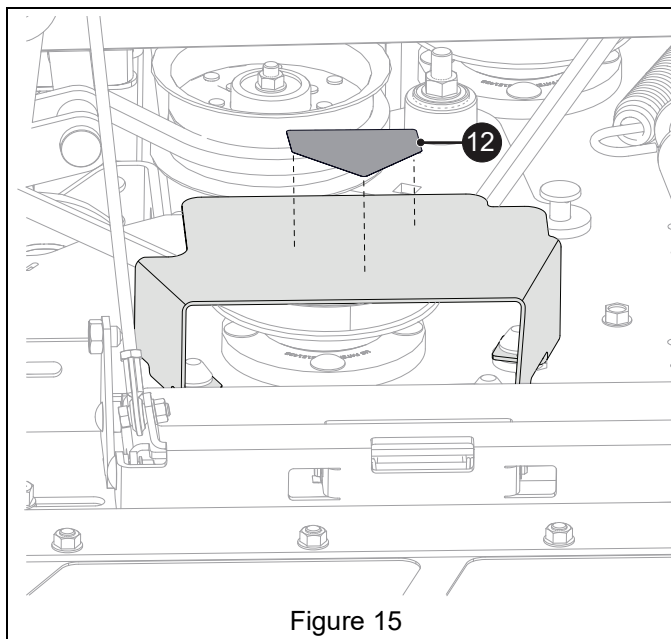

Figure 15

INSTALL BELT COVER

48" Models Only

1. Remove right side belt cover and retain for use without OCDB kit. See Figure 16.

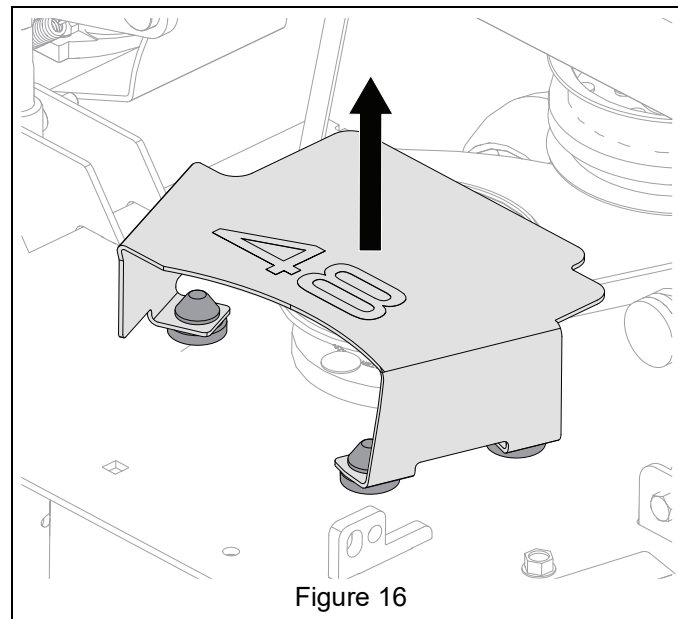

Figure 16

2. Remove and retain two round head square neck bolts and two ball studs from deck. See Figure 17.

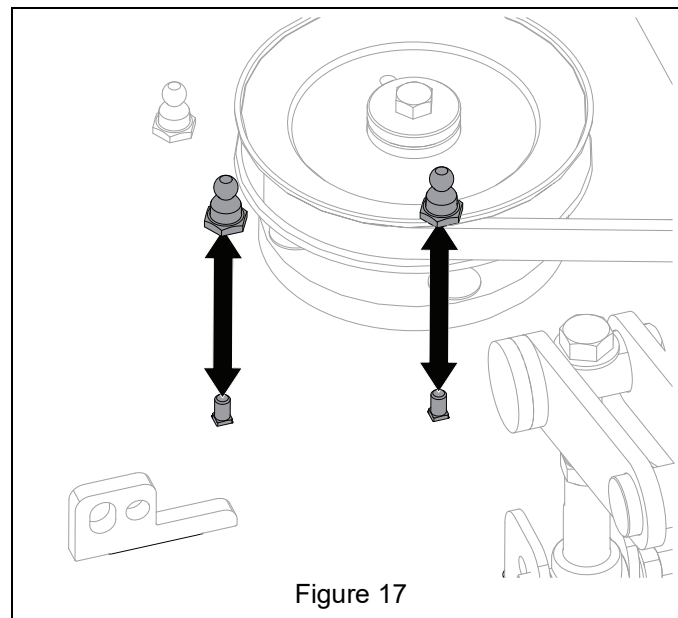
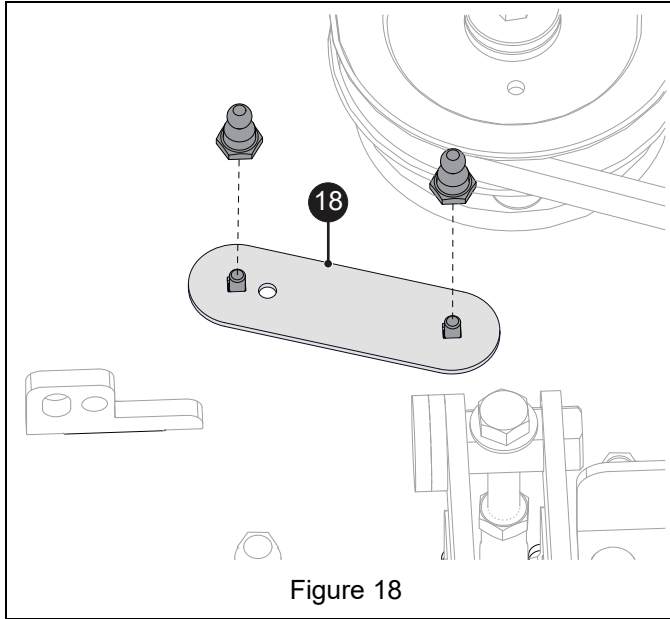
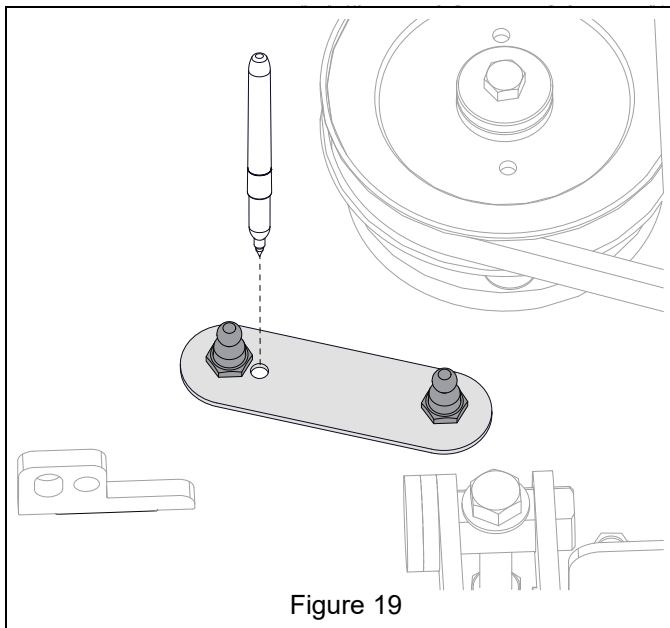

Figure 17

3. Temporarily position hole template (item 18) over ball stud holes and reinstall round head square neck bolts and ball studs removed earlier. See Figure 18.



4. Mark drill location on deck. See Figure 19.



5. Use a center punch to create a drill-indexing indent at the marked location. See Figure 20.

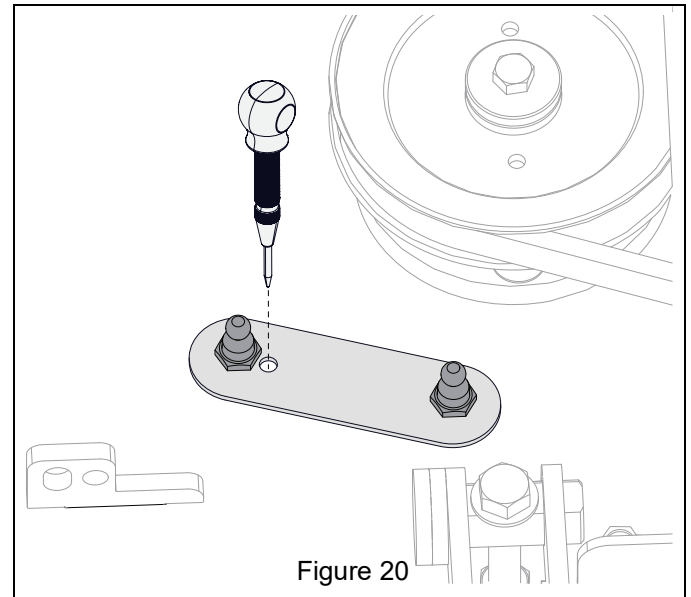

6. Drill one 9/32" (0.281") hole at the center-punched location. See Figure 21.

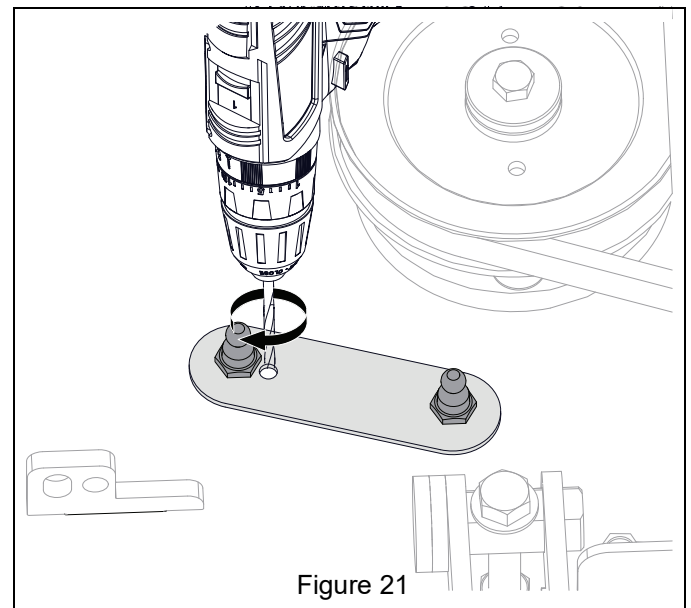

See Figure 22.

7. Remove hardware retaining template and discard template. Retain ball studs and one round head square neck bolt for reinstallation. Retain remaining round head square neck bolt for use without OCDB kit.
8. Reinstall ball stud in newly drilled hole and secure with one 1/4" x 1/2" hex bolt (item 21). Reinstall ball stud and round head square neck bolt in the other hole.

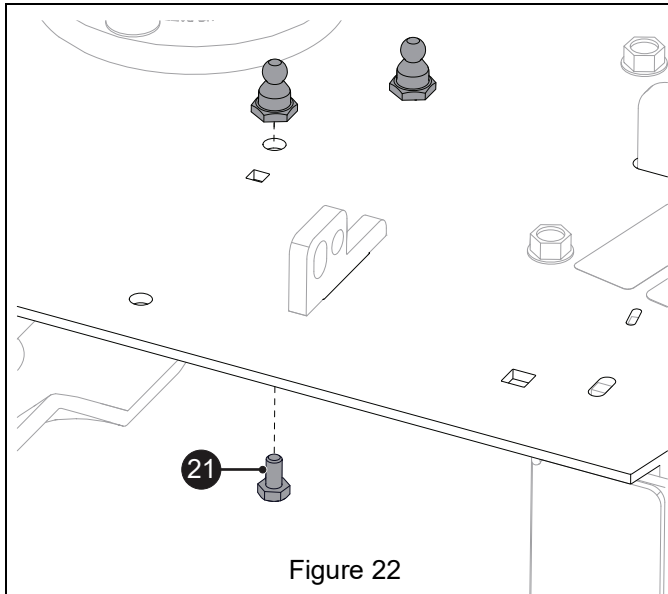

9. Install belt cover (item 22). See Figure 23.

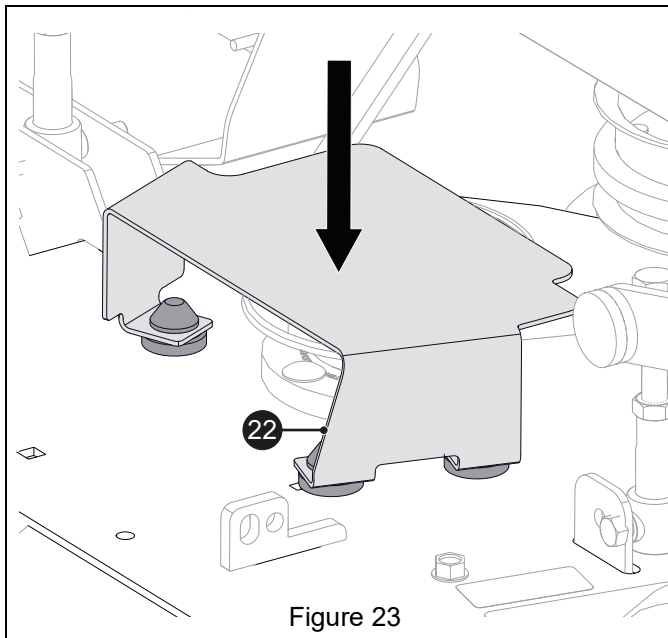

OPERATION

1. Pull handle up to open discharge opening; push handle down to block discharge opening.

PARTS LIST

See Figure 24.

Item Description	Qty	Ariens P/N
1 OCDB Base	1	09396051
2 Block-Off Hinge	1	09396151
3 Block-Off Plate	1	09396251
4 Chute Mounting Bracket	1	09396353
5 Formed Rubber Discharge Chute	1	04880900
6 Discharge Chute Clamp Plate	1	04976151
7 Wire Handle	1	04852700
8 Soft Touch Hand Grip	1	05174400
9 3/8"-16 x 1 1/2" Round Head Square Neck Bolt	2	06200328
10 3/8"-16 x 1" Round Head Square Neck Bolt	7	06200235
11 5/16"-18 x 1 1/4" Round Head Square Neck Bolt	2	06200310
12 3/8"-16 Nylon Locking Center Flange Nut	9	06500901
13 5/16"-18 Center Locking Flange Nut	3	06500840
14 1/2"-13 Jam Nut	2	06500911
15 1/2"-13 Ball Spring Plunger	2	07001704
16 3/8" x 1/2" x 7/8" Flange Bushing	2	05500435
17 External Retaining Ring	2	05718300
18 25/64" x 1/2" x 25/32" x 7/8" Flanged Spacer	2	03114500
19 5/16" x 1/2" x 11/16" Flange Bearing Spacer	2	01213100
20 3/16" x 11 1/4" Pin	1	06800123
21 Torsion Spring	1	08300515
22 5/16" Right-Hand Thread Rod End	1	03787100
23 11/16" x 7/8" x 9/16" Panel Snap Bushing	1	07500126
24 5/16"-24 Jam Nut	3	06500923
25 5/16"-18 x 1" Hex Bolt	1	05901701
26 Danger Decal	1	02988100

Item Description	Qty	Ariens P/N
27 1/2"-13 x 6 1/2" Hex Bolt	1	05901907
28 1/2" x 1 7/16" Flat Steel Washer	1	06401022
29 1/2"-13 Center Locking Flange Nut	1	06500902
30 Coupler Nut	1	06501003
31 Handle Extension	1	05181200
32 Hole Template	1	09669051
33 Mounting Bracket	1	05284753
34 5/16"-18 x 1" Round Head Square Neck Bolt	2	06200237
35 1/4"-20 x 1/2" Hex Bolt	1	05901705
36 Belt Cover	1	09667253
37 Mounting Bracket	1	09667753
38 3/8"-16 x 4" Round Head Square Neck Bolt	2	06200239
39 Rubber Push-In Bushing	1	07500429

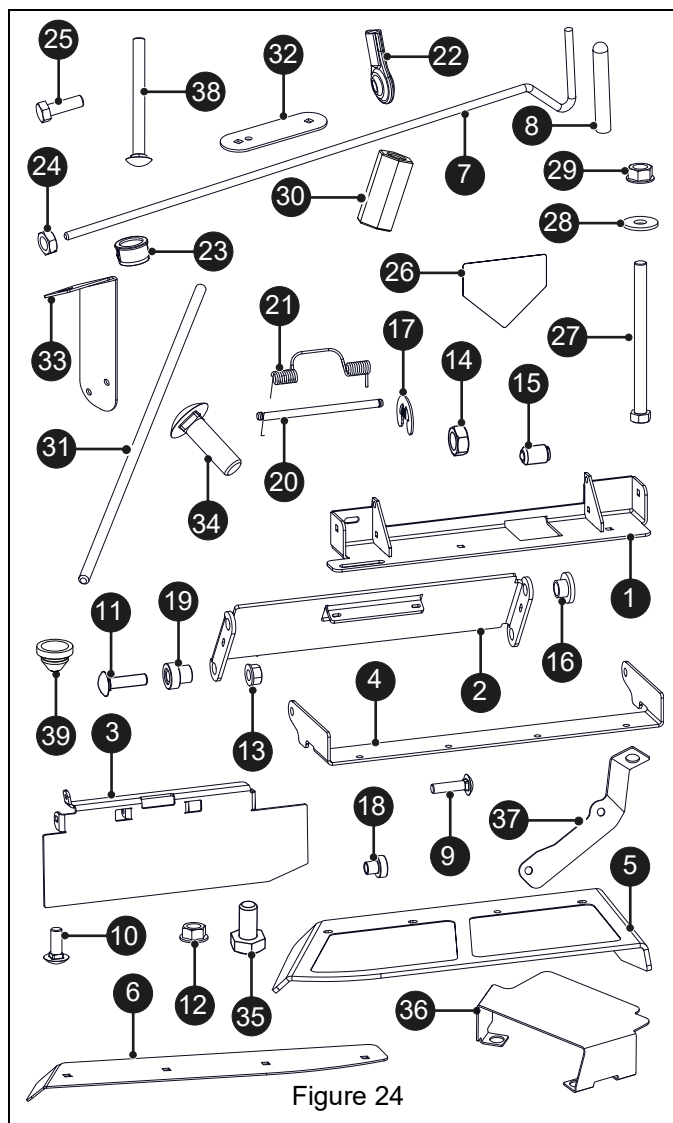

Figure 24