

Instruction Sheet

Kit Number: 78807200

MULCH KIT



WARNING: FAILURE TO FOLLOW INSTRUCTIONS could result in personal injury and/or damage to unit.

Read, understand, and follow all safety practices in Owner/Operator Manual before beginning.

Package Contents

Check the contents of your kit for the parts listed below. Also see Figure 1.

Item	Description	Qty	Ariens P/N
1	Front Mulch Baffle	1	05154053
2	Rear Mulch Baffle	1	05158353
3	18" Mulch Blade	2	00273100
4	5/16"-18 Nylon Locking Flange Nut	5	06545400
5	5/16"-18 x 1" Round Head Square Neck Bolt	5	06216100

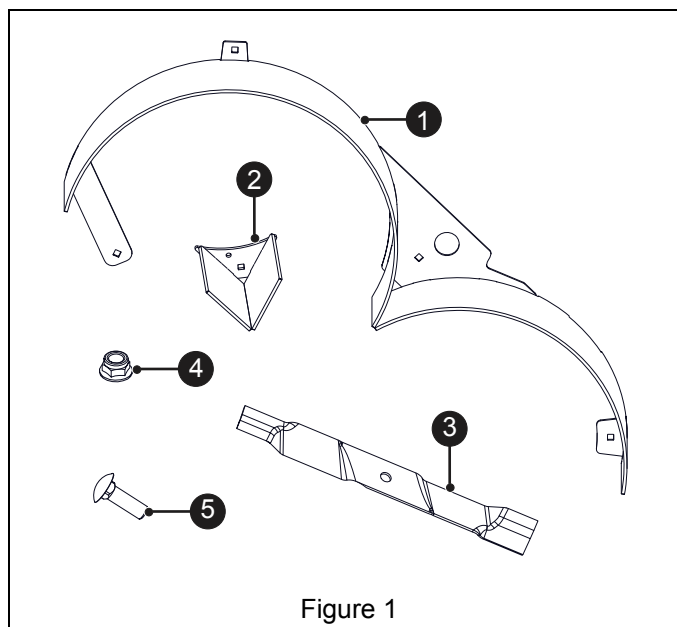

Figure 1

INSTALLATION



CAUTION: AVOID INJURY! Use sturdy gloves or padding to protect hands when working with mower blades.

Rotation of one blade rotates the other blades.

1. Stop engine, remove key and engage parking brake. Wait for all moving parts to stop and for hot parts to cool.
2. Disconnect spark plug wires.
3. Remove 3/8" x 2 1/4" hex bolt and 3/8" nylon locking flange nut retaining discharge chute assembly. Remove discharge chute assembly and retain all parts for operation without mulch kit. See Figure 2.

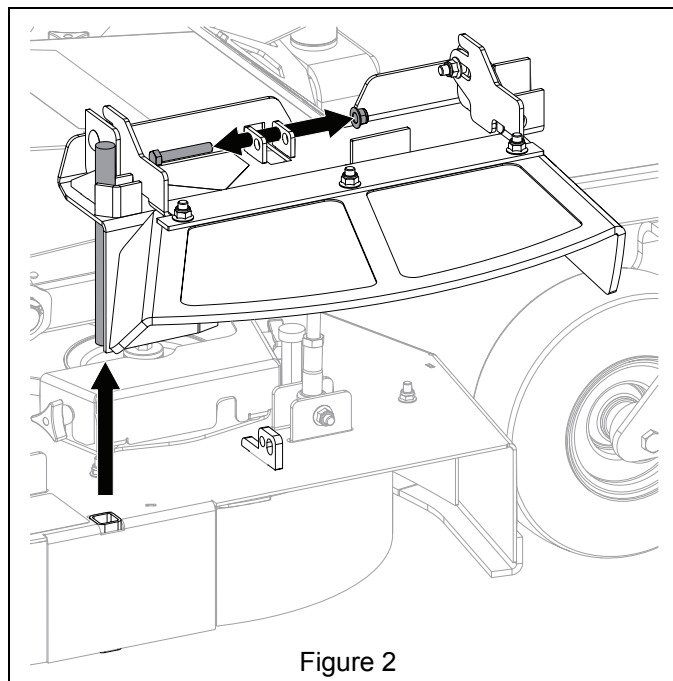
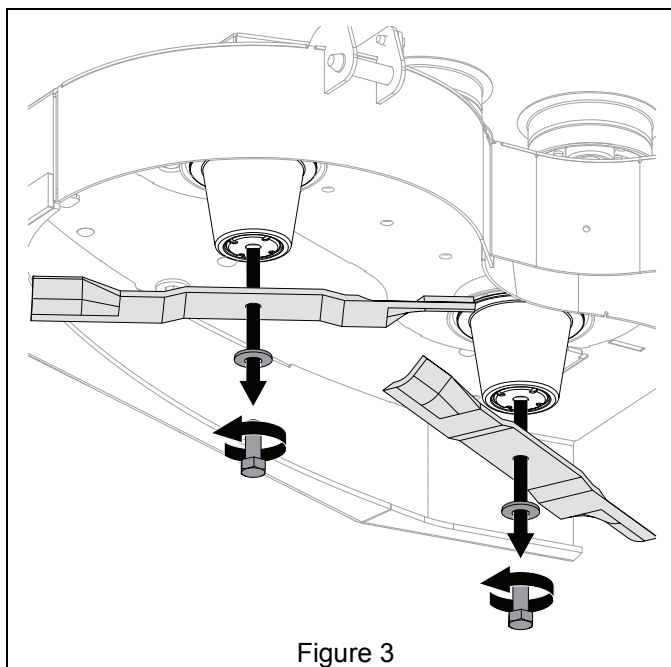
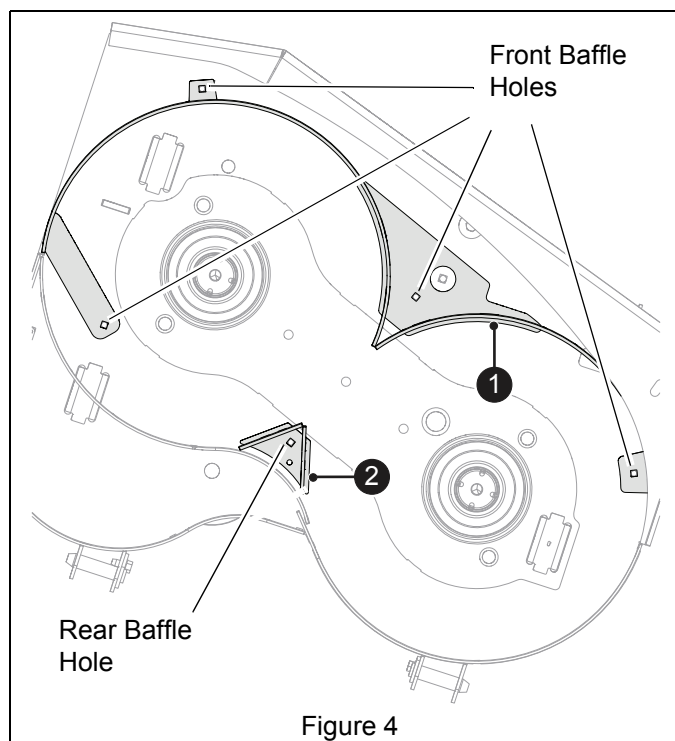

Figure 2

4. Remove bolts, washers and blades from spindles. Retain washers and bolts for reinstallation. Retain blades for operation without mulch kit. See Figure 3.



5. Align front baffle (item 1) and rear baffle (item 2) with the existing holes in deck. See Figure 4 for alignment.



6. Secure baffles to the deck with five 5/16" nylon locking flange nuts (item 4) and five 5/16" x 1" round head square neck bolts (item 5). See Figure 5.

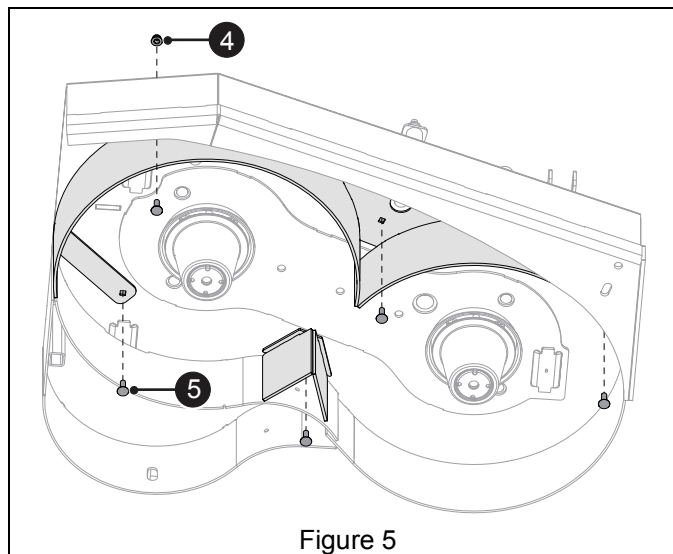

7. Install mulch blades (item 3) and secure with washers and bolts removed in step 5. Torque bolts to 156 N•m – 217 N•m (115 lb-ft – 160 lb-ft). See Figure 6.

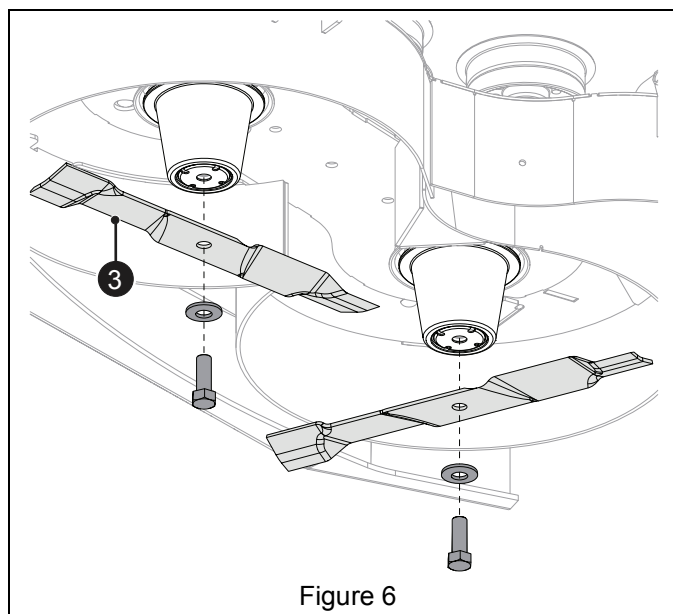

8. Reconnect spark plug wires.

MULCHING TIPS

1. Mow at full throttle and half speed.
2. Mow dry grass only.
3. Keep mower blades sharp.
4. Cut no more than 2.5 cm (1") at a time. For tall grass, mow at a higher cutting height, then make a second or third pass with the deck set to the desired cutting height.
5. Clean the underside of deck after each mowing.
6. DO NOT wash mower with high-pressure sprayer when cleaning deck or mower.