

Instruction Sheet

Kit Number: 78593600

SPRING TINE KIT



WARNING: FAILURE TO FOLLOW INSTRUCTIONS could result in personal injury and/or damage to unit.

Read, understand, and follow all safety practices in Owner/Operator Manual before beginning.

Package Contents

Check the contents of your kit for the parts listed below. Also see Figure 1.

Item	Description	Qty
1	Spring Tine Assembly	1

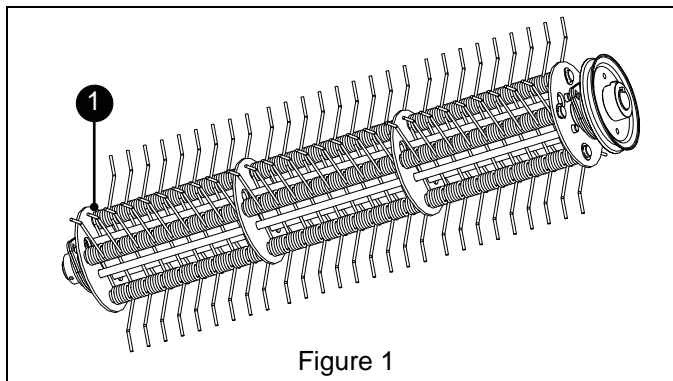

Figure 1

REMOVAL

1. Stop engine, remove key and engage parking brake.
2. Wait for all moving parts to stop and for hot parts to cool.
3. Remove and retain two nyloc nuts and hex bolts from right end cover and remove cover. See Figure 2.

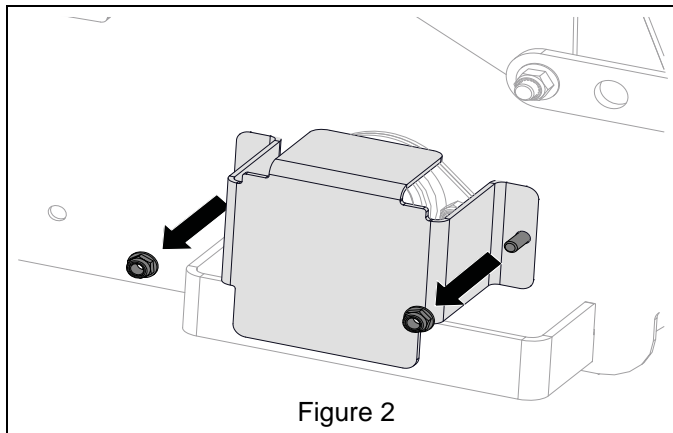

Figure 2

4. Remove and retain one hex bolt, lock washer, flat washer and p-clip from belt shield. See Figure 3.

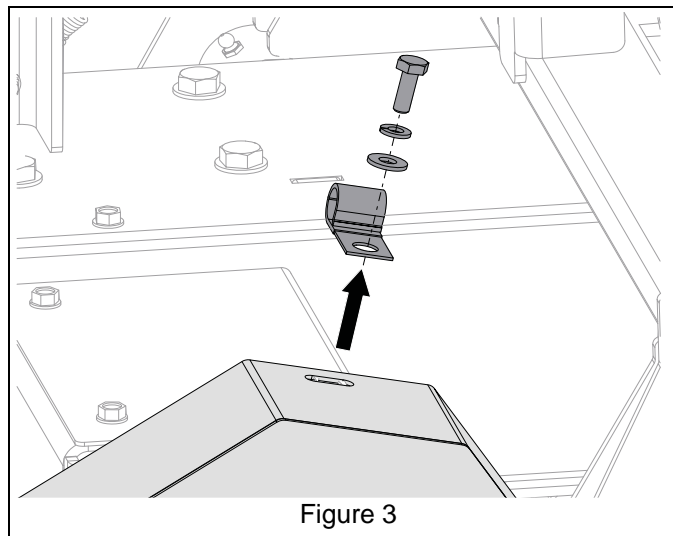

Figure 3

5. Remove and retain one hex bolt, flat washer and nyloc nut from bottom of belt shield and remove shield. See Figure 4.

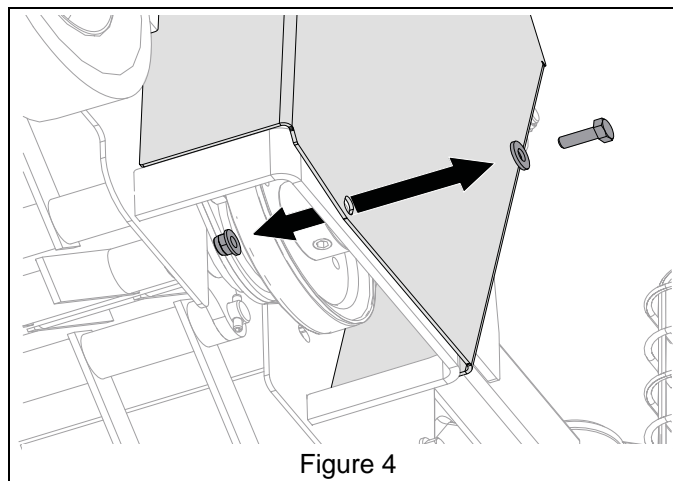

Figure 4

6. Disconnect idler spring from anchor. See Figure 5.

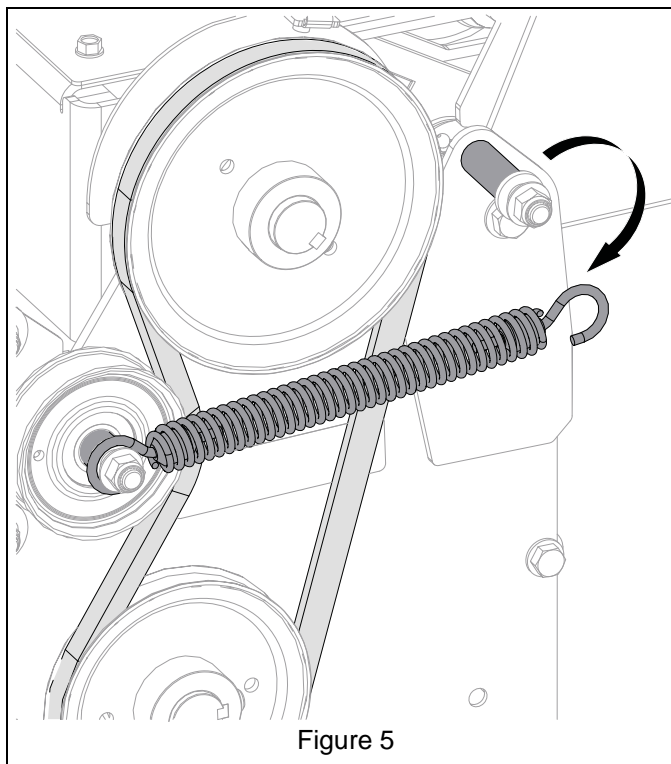

Figure 5

7. Remove and retain belt. See Figure 6.

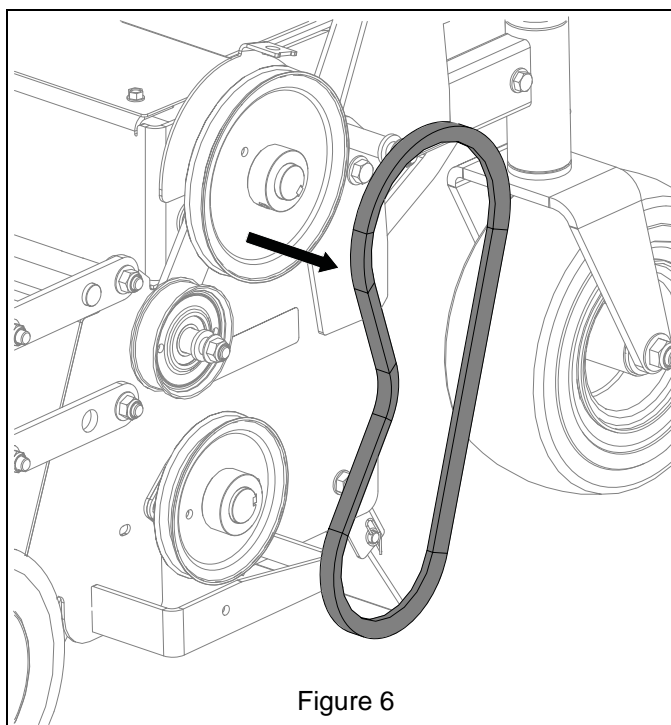

Figure 6

CAUTION: Support blade assembly before removing mounting hardware.

8. Remove and retain two hex nuts and round-head-square neck bolts from left flange bearing. See Figure 7.

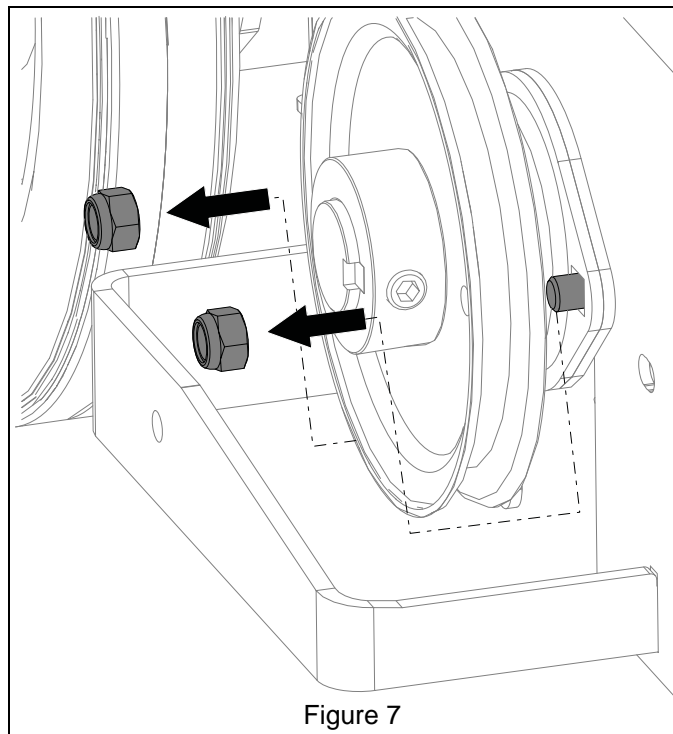

Figure 7

9. Support blade assembly and remove two hex bolts and nyloc nuts from right flange bearing. See Figure 8.

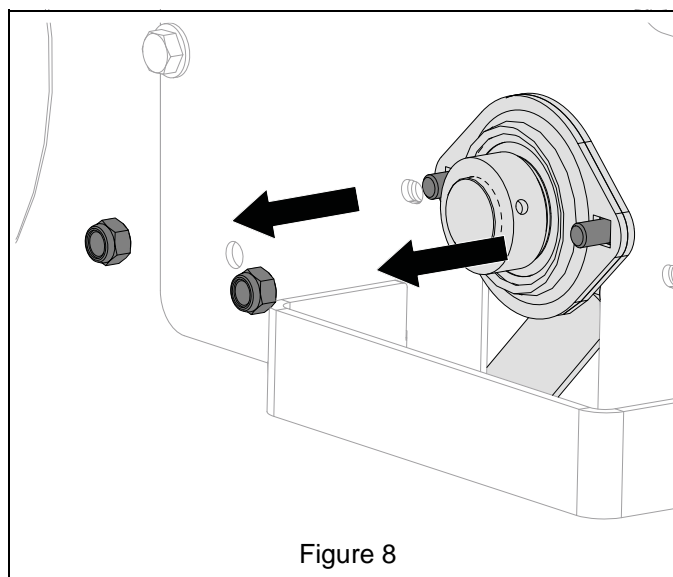
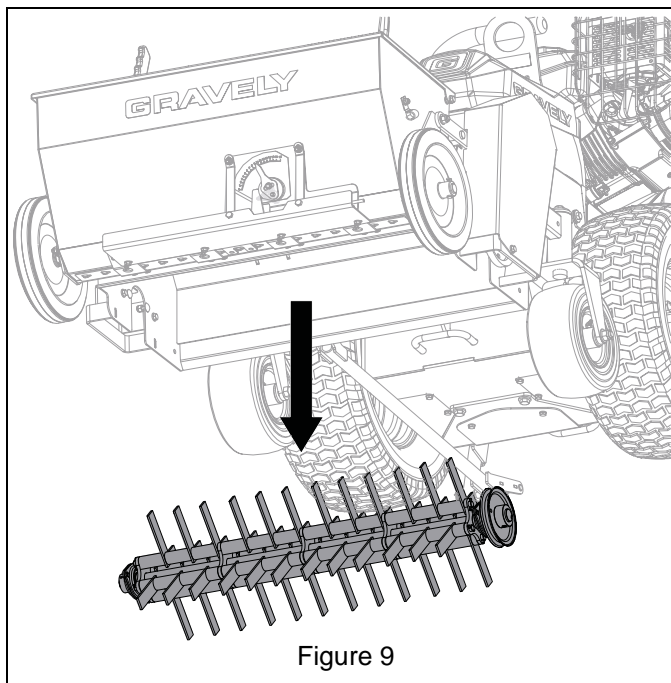

Figure 8

10. Remove blade assembly. See Figure 9.



INSTALLATION

1. Position and support spring tine assembly (item 1) in dethatcher.

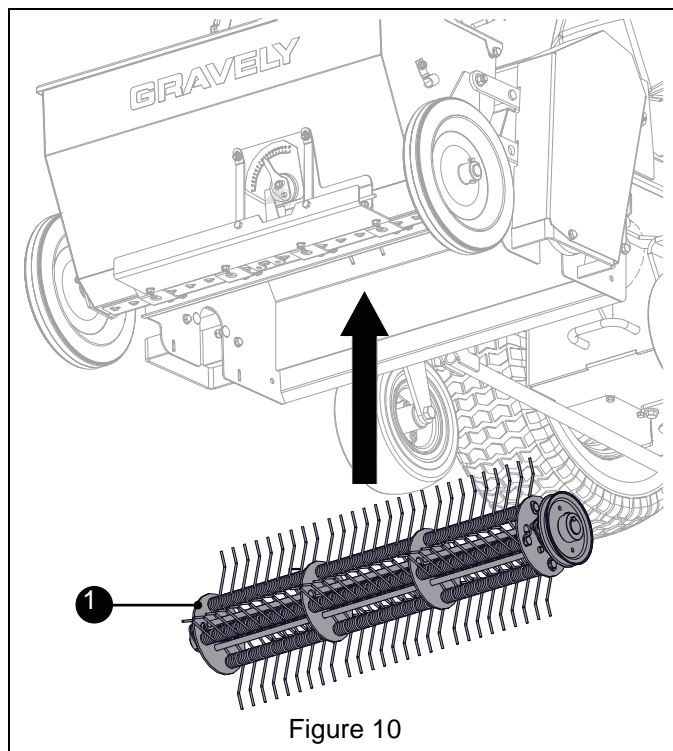

2. Secure right flange bearing with hardware removed earlier. See Figure 11.

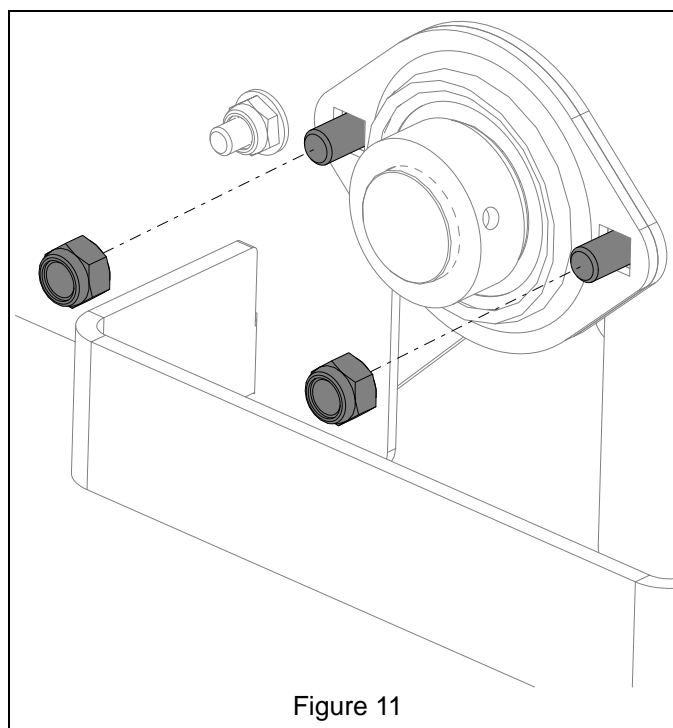

3. Secure the left flange bearing with hardware removed earlier. See Figure 12.

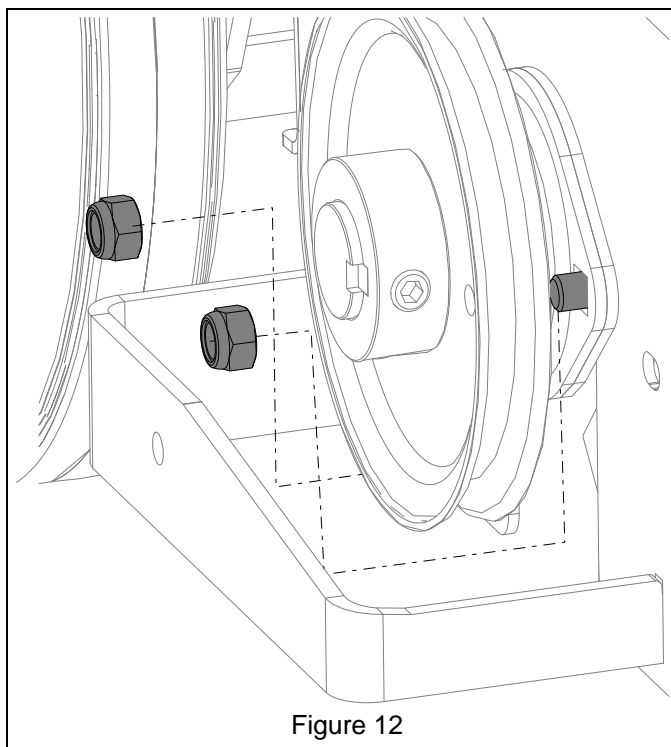

Figure 12

4. Verify that spring tine assembly rotates freely.
5. Secure right end cover with hardware removed earlier. See Figure 13.

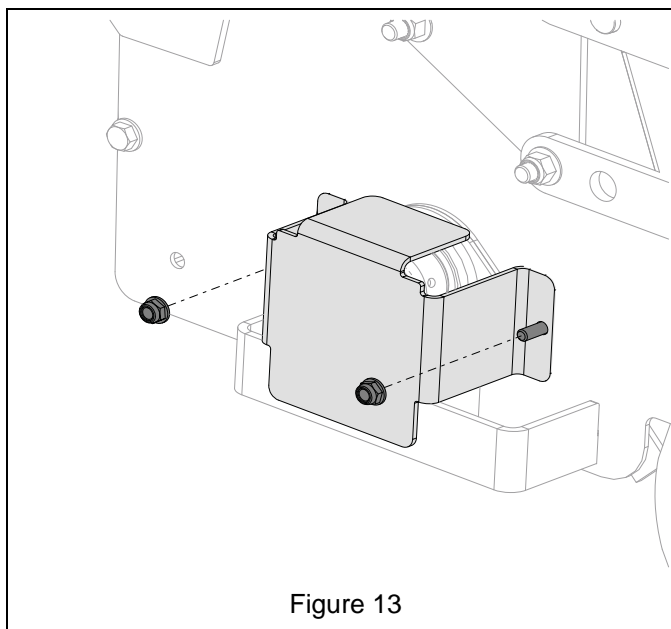

Figure 13

6. Install belt. See Figure 14.

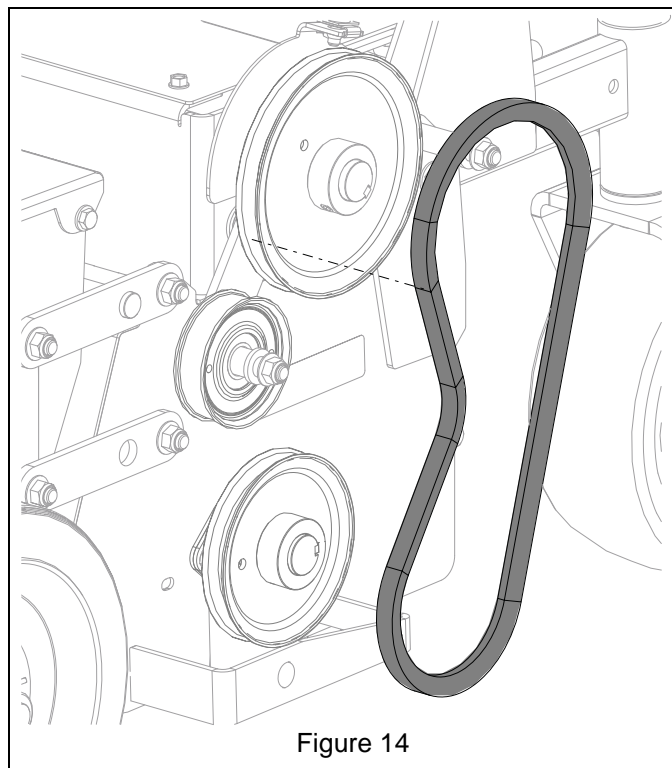

Figure 14

7. Connect idler spring to anchor. See Figure 15.

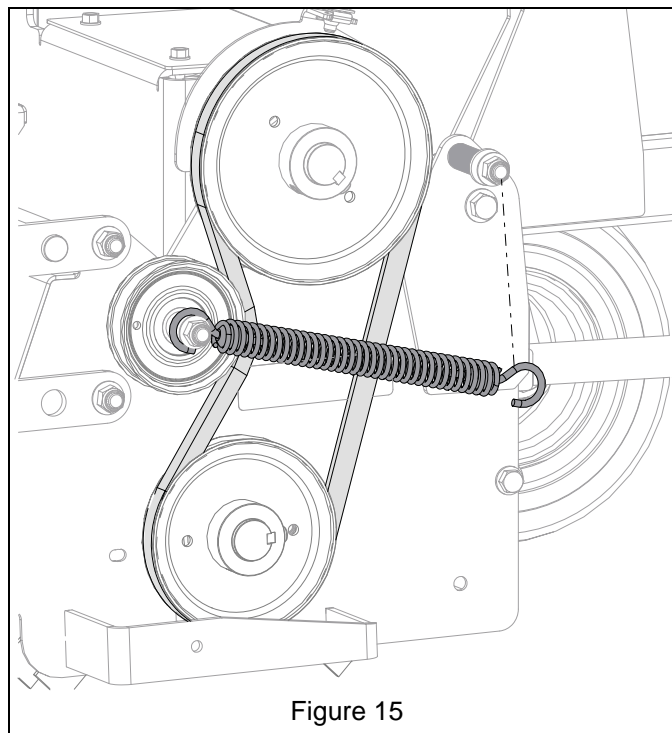

Figure 15

8. Route cable through p-clip and secure p-clip to belt shield with hardware removed earlier. See Figure 16.

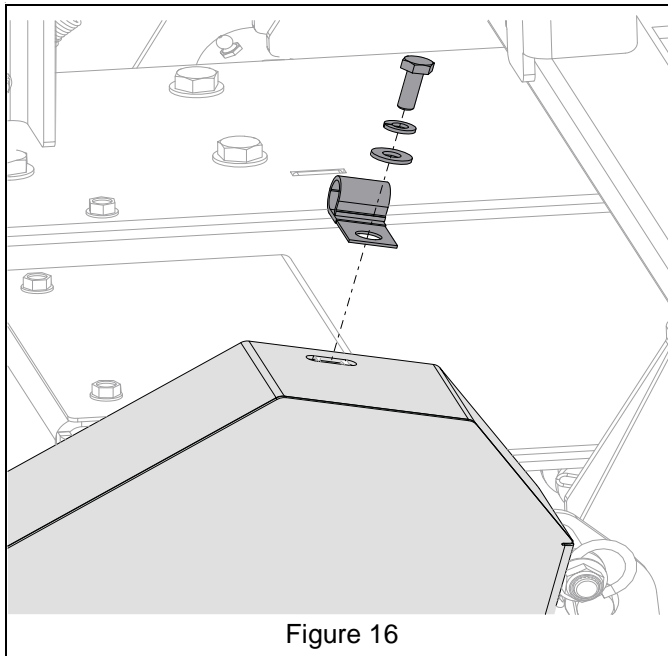

Figure 16

9. Secure bottom of belt shield with hardware removed earlier. See Figure 17.

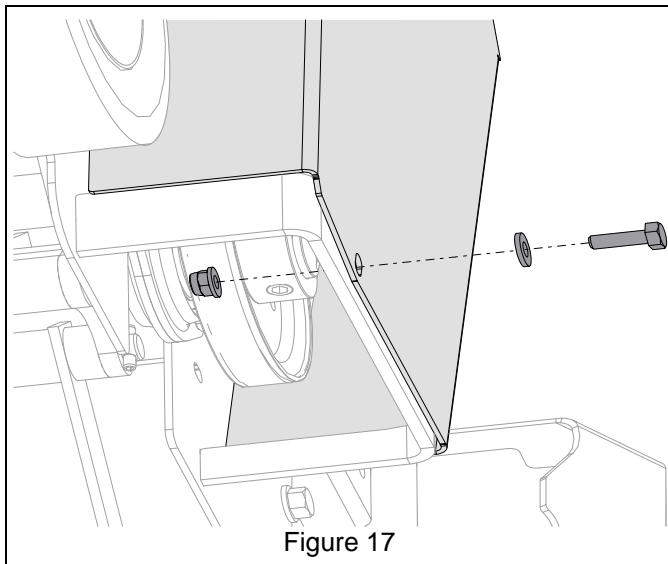

Figure 17

SPRING TINE FEATURES

See Figure 18.

Spring Tines:

- Remove dead grass and thatch from turf without tearing or damaging existing root structure.
- Provide less aggressive dethatching than flail blades.

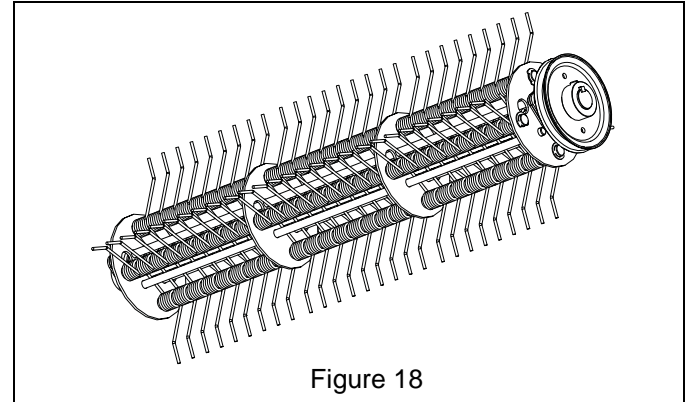

Figure 18

OPERATION



WARNING: AVOID INJURY.

Read and understand the *Safety* section before proceeding.

OPERATE ATTACHMENT

1. Set tine depth to lightly brush turf.
2. Start the engine.
3. Engage operator presence lever.
4. Rotate drive control grip to drive unit.
5. Pull PTO switch to activate tine assembly.
6. Lower attachment.
7. Drive forward.

STOP ATTACHMENT

1. Push PTO switch to stop tine assembly.
2. Push lift lever fully forward to raise attachment.
3. Stop engine.

MAINTENANCE

Replace tines when they cannot comb 0.6 cm (1/4") into the turf.